



# Domestic And Light Commercial Compressors



**杭州新霓虹制冷设备有限公司**  
Hangzhou Comptek Compressor Manufacturing Co., Ltd

地址: 杭州市余杭区瓶窑镇凤都工业区二区园西路6号 邮编: 311115  
电话: 0571-88622980 88622981 传真: 0571-88622980 88622982  
邮箱: comptek@comptek.com.cn comptek03@comptek.com.cn nhzl-000@163.com  
网址: www.comptek.com.cn http://cnnihong.en.alibaba.com www.hznhl.com

---

Add: The Second District Of Fengdu Industrial Zone, Pingyao Town, Yuhang, Hangzhou  
P.C.: 311115 Tel: 0571-88622980 88622981 Fax: 0571-88622980 88622982  
E-mail: comptek@comptek.com.cn comptek03@comptek.com.cn nhzl-000@163.com  
www.comptek.com.cn http://cnnihong.en.alibaba.com www.hznhl.com  
Contact person: Jonathan What's app: 008818352925888 We chat: 008818352925888





**COMPANY**

**INTRODUCTION**



Hangzhou Comptek Compressor Manufacturing Co, Ltd. located in the second district of Fengdu Industrial Zone, Pingyao town, Hangzhou City. It is 50 kilometers away from Xiaoshan international airport. Adjacent to National Road 104.

Our company owns standard factory and office buildings covering an area of 17000 square meters. We have more than 20 years history of refrigeration Equipment. Our company specialize in the manufacturing of 1/10HP to 1/2HP refrigeration compressors.

Our main products include DW, DM, DF, DL, FN, DV and QD series hermetical compressor, compressor start relay, overload protector, and so on. Strictly implementing the ISO9001 system, in addition to the CCC and CE standards, these products are selling well in southeast Asia, Middle East, South America and Russia, in addition to the domestic markets.

Our company specializes in manufacturing L/M/HBP ,M/HBP, L/MBP and LBP series compressor, these compressors are suitable for business refrigeration equipment, such as deep freeze, display case, showcase, serve food case, and island showcase refrigerator etc.

Our enterprise tenet of "trial carve out, not satisfaction forever, be brave in competition, pursuing excellence" We insist on the working tenet of " blossom and flourish together, benefit together" ; our provide preferential price and excellent service to our consumers wholeheartedly.





压缩机机型 Compressor Style  
 命名 Nomenclature

压缩机应用范围 Application of Compressor

工作范围 Working Range

测试工况 Test Conditions / 冷却方式 Cooling Type / 电机启动扭矩 Motor Torque

电机类型 Electrical Motor Types / 商标说明图 Trademark Illustration

R134a制冷压缩机技术参数 L/M/HBP QD Series R134a

R134a制冷压缩机技术参数 L/M/HBP FN Series R134a

R134a制冷压缩机技术参数 L/MBP QD Series R134a

R134a制冷压缩机技术参数 M/HBP QD Series R134a

R134a制冷压缩机技术参数 LBP QD Series R134a

R134a 制冷压缩机技术参数 L/MBP QD Series R134a(50-60Hz)

R134a 制冷压缩机技术参数 M/HBP QD Series R134a(50-60Hz)

R1600a制冷压缩机技术参数 L/M/HBP QD Series R800a

R1600a制冷压缩机技术参数 LBP QD Series R800a

R290制冷压缩机技术参数 L/MBP QD Series R290

R290 制冷压缩机技术参数 L/M/HBP QD Series R290

R290 制冷压缩机技术参数 LBP QD Series R290

R404A制冷压缩机技术参数 L/MBP QD Series R404A

R404A制冷压缩机技术参数 M/HBP QD Series R404A

R22制冷压缩机技术参数 L/MBP QD Series R22

产品接线图和外形尺寸 Compressor Wiring Diagram & Dimensions

DW/DM/DF系列外形尺寸图 Dimensions

D/L/DQ/FN系列外形尺寸图 Dimensions

直流压缩机 DV compressor

直流压缩机安装说明 DV Compressor Instruction

控制器使用说明 Electronic Unit Specification

工作电压设定表 Optional battery protection settings

速度设定表 Compressor speed settings

包装清单 Packing List

电 器 配 件 Electric Parts

Hermetic Piston Refrigerant Compressor Screw Connection Type

Hermetic Piston Refrigerant Compressor Copper Connection Type

Hermetic Piston Refrigerant Compressor Parallel Screw Connection Type

Hermetic Piston Refrigerant Compressor Copper Connection Type

R134a Condensing Units

R404a Condensing Units

R22 Condensing Units

Horizontal Condensing unit

R22 Air Conditioning Series

R22 / R407 Air Conditioning Series

M/HBP R22 Compressors

R404a Commercial Refrigeration & M/HBP

R404a Commercial Refrigeration & M/HBP

R134a Commercial Refrigeration & M/HBP

HORIZONTAL CONDENSING UNIT (R404A)

Kitchen Freezer Unit

# CONTENTS

## 压缩机机型 Compressor Style

DW机型  
DW style



DM机型  
DM style

DF机型  
DF style



DL 机型  
DL style

DQ机型  
DQ style



FN机型  
FN style

DV机型  
DV style



## 命名 Nomenclature



应用工况 Application	
L	低背压 蒸发温度-35℃~-15℃ LBP Evaporation range-35℃~-15℃
M	中低背压 蒸发温度-35℃~0℃ L/MBP Evaporation range-35℃~0℃
H	中高背压 蒸发温度-20℃~+15℃ M/HBP Evaporation range-20℃~+15℃
K	高背压 蒸发温度-15℃~+15℃ HBP Evaporation range-15℃~+15℃
T	低中高背压 蒸发温度-35℃~+15℃ L/M/HBP Evaporation range-35℃~+15℃

电压/频率 Voltage/Frequency	
A	220-240V/50Hz
B	208-230V/60Hz
C	110V/60Hz
D	115-127V/60Hz
E	220-240V/60Hz
F	220V/50Hz/60Hz
G	110V/50Hz
Z	12/24V
W	48V

机型 Style	
W	DW
M	DM
F	DF
L	DL
Q	DQ
X	FN

系列 Compressor Family	
QD	全封闭单级压缩机 Hermetic single compressor
FN	松下外形压缩机 FN series compressor
DF	高效压缩机 DF series compressor
DM	高效压缩机 DM series compressor
DV	直流变频压缩机 Direct current inverter compressor

启动方式 Electrical Equipment	
P	PTC
Y	PTC+启动电容 (强制配置) PTC+Start cap(mandatory)
R	继电器 Relay
M	继电器+启动电容 (强制配置) Relay+Start cap (mandatory)
K	直流变频控制器 DC frequency conversion controller
W	继电器+启动电容+运行电容 Relay+Start cap+Running cap

效率等级 Efficiency Level	
H	标准效率 Standard efficiency
G	高效型 High efficiency
V	超高效型 Surper high efficiency

制冷剂 Refrigerant Code	
A	R12,R406A
E	R22
K	R404A
H	R134a
Y	R600a
U	R290

压缩机名义气缸容积  
Displacement Of Compressor



## 压缩机应用范围

Application Of Compressor

<p style="text-align: center;"><b>低中高压</b> L/M/HBP</p> <p>蒸发温度范围: <math>-35^{\circ}\text{C} \sim +15^{\circ}\text{C}</math> Evaporation range: <math>-35^{\circ}\text{C} \sim +15^{\circ}\text{C}</math> 实际应用: 饮水机、饮料机、制冰机、啤酒机、自动售货机、食品展示柜、酒柜、除湿机、风幕柜、蛋糕柜、专业厨房冷柜、冷柜、超市岛柜、医疗冷藏箱等。 Application: Water cooler, beverage cooler, ice maker, beer dispenser, vending machine, food exhibitor, wine cooler, dehumidifier, vpright cabinet, cake cabinet, professional kitchen, chest freezer, refrigerated island, medical cooler etc.</p>	<p style="text-align: center;"><b>中高压</b> M/HBP</p> <p>蒸发温度范围: <math>-20^{\circ}\text{C} \sim +15^{\circ}\text{C}</math> Evaporation range: <math>-20^{\circ}\text{C} \sim +15^{\circ}\text{C}</math> 实际应用: 饮水机、饮料机、制冰机、啤酒机、自动售货机、食品展示柜、酒柜、除湿机、风幕柜、蛋糕柜、专业厨房冷柜、冷柜、超市岛柜、医疗冷藏箱等。 Application: Water cooler, beverage cooler, ice maker, beer dispenser, vending machine, food exhibitor, wine cooler, dehumidifier, vpright cabinet, cake cabinet, professional kitchen, chest freezer, refrigerated island, medical cooler etc.</p>
<p style="text-align: center;"><b>低中压</b> L/MBP</p> <p>蒸发温度范围: <math>-35^{\circ}\text{C} \sim 0^{\circ}\text{C}</math> Evaporation range: <math>-35^{\circ}\text{C} \sim 0^{\circ}\text{C}</math> 实际应用: 饮水机、饮料机、制冰机、啤酒机、自动售货机、食品展示柜、专业厨房冷柜、冷柜、超市岛柜、医疗冷藏箱等。 Application: Water cooler, beverage cooler, ice maker, beer dispenser, vending machine, food exhibitor, professional kitchen, chest freezer, refrigerated island, medical cooler etc.</p>	<p style="text-align: center;"><b>低背压</b> LBP</p> <p>蒸发温度范围: <math>-35^{\circ}\text{C} \sim +15^{\circ}\text{C}</math> Evaporation range: <math>-35^{\circ}\text{C} \sim +15^{\circ}\text{C}</math> 实际应用: 冰箱、冷柜、超市岛柜等。 Application: Refrigerator, chest freezer, refrigerated island etc.</p>

## 工作范围

Working Range

**LBP**  
R290/R134a/R600a

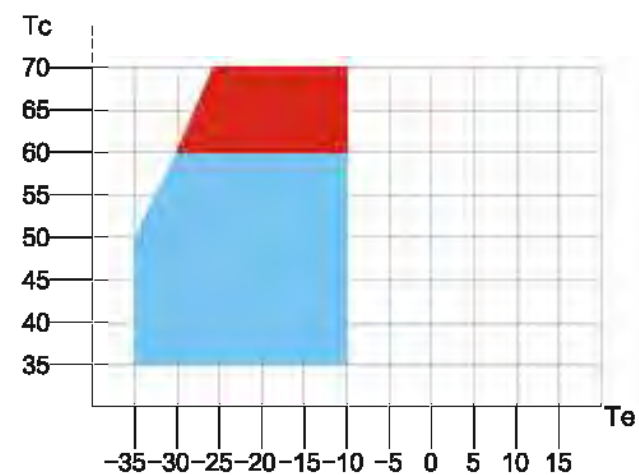

**M-HBP**  
R290/R134a

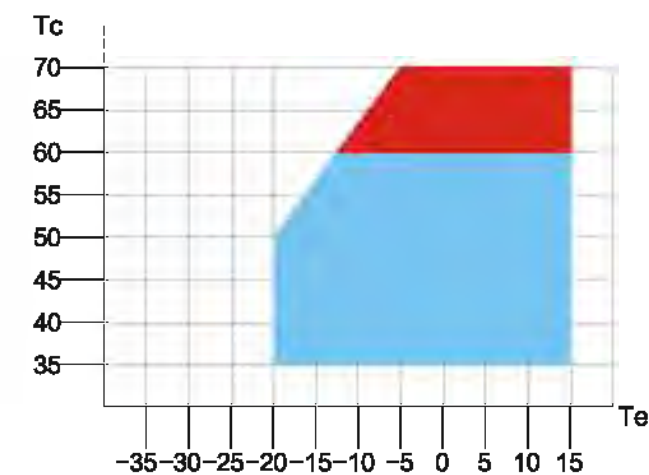

**L-MBP**  
R290/R134a

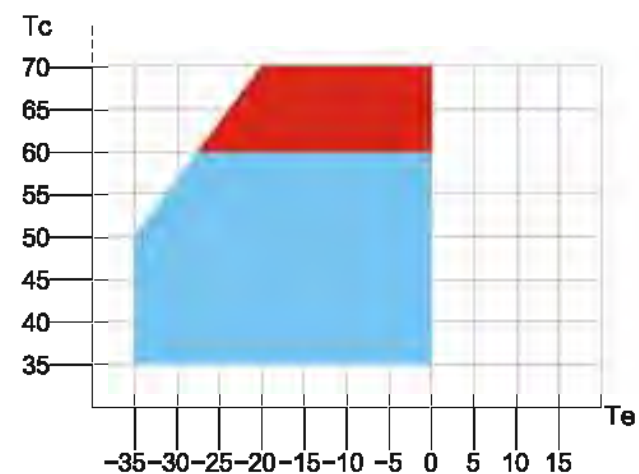

**L-M-HBP**  
R290/R134a/R600a

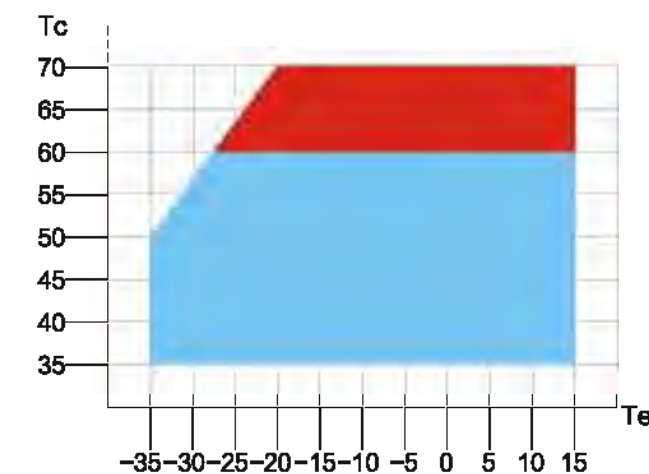

## 测试工况 Test Conditions

测试工况 Test Conditions	应用 Application	蒸发温度 °C/°F Evaporating Temperature °C/°F	冷凝温度 °C/°F Condensing Temperature °C/°F	回气温度 °C/°F Return Temperature °C/°F	过冷温度 °C/°F Subcooling Temperature °C/°F	环境温度 °C/°F Ambient Temperature °C/°F
ASHRAE	LBP	-23.3/10	54.4/130	32.2/90	32.2/90	32.2/90
	MBP	-6.7/ 20	54.4/130	35/95	46.1/115	35/95
	HBP	7.2/45	54.4/130	35/95	46.1/115	35/95

## 冷却方式 Cooling Type

静态 Static	压缩机不需要强制冷却，但是必须正确安装，以便环境空气充分冷却压缩机，防止过热。 Compressors approved for static cooling are those that don't allow operation of a fan motor associated with the condenser.
风扇冷却 Fan	压缩机需要风扇强制冷却。 Compressors approved for forced cooling are those that require the operation of a fan motor associated with the condenser.
静态风冷/动态冷却 Static/Fan	压缩机兼容静态冷却及风扇冷却两种方式。 Compressors approved for static and forced cooling are those which may or may not be used with a fan motor associated with the condenser.

## 电机启动扭矩 Motor Torque

LST	低启动扭矩： 低背压-中背压-高背压-空调工况，使用RSIR-RSCR-PSC的电机，适用于毛细管节流系统平衡压力启动。 (Low starting Torque) Low starting torque: LBP/MBP/HBP applications with RSIR/RSCR electric motors. Appropriate for systems with a capillary tube (c) expansion type device and equalized pressures on start up.
HST	HST 高启动扭矩： 低背压-中背压-高背压，使用CSIR-CSR的电机，适用于节流阀和毛细管节流膨胀系统，满足不平衡压力启动。 (High starting Torque) high starting torque: LBP/MBP/HBP applications with CSIR/CSR electric motors. Appropriate for systems with expansion valve(V) or capillary tube expansion type device with disequalized pressures on start up.

## 电机类型 Electrical Motor Types

RSIR	电阻启动-电感运行 该电机类型，适用于小型压缩机，低启动扭矩，仅适用于压力平衡的毛细管节流系统。电机带有高阻抗的启动绕组且在电机达到稳定转速后，需断开启动绕组。当完成启动后，继电器根据电机电流断开启动绕组。对部分型号而言，继电器可以是PTC启动器。 Resistive start -Inductive Run:no start capacitor;no run capacitor.
RSCR	电容启动-电容运行 电容启动-电感运行 与RSIR电机类似，使用与启动绕组串联的匹配的电容器来保证高启动扭矩。 Resistive start-Capacitive Run:no start capacitor;run capacitor is needed to improve the efficiency.
CSIR	电容启动-电感运行 与RSIR电机类似，使用与启动绕组串联的匹配的电容器来保证高启动扭矩。 Capacitive Start-Inductive Run:no run capacitor;start capacitor is needed to improve the torque.
CSR	带电容启动，电容运行 与PSC电机类型类似，但是启动绕组中串有启动电容。根据电机电流，在启动完成后，继电器断开启动电容。电机具有高启动扭矩和高效率的特征。 Resistive start and Run-CSR version with capacitive run and start windings.

## 商标说明图 Trademark Illustration



# 低中高背压商用系列制冷压缩机

L/M/HBP Commercial Series Compressor

## R134a制冷压缩机技术参数

Technical Data of

QD Series R134a Refrigeration Compressor ( 220-240V/50Hz )

QD系列  
L/M/HBP  
R134a

机型 Style	型号 Model	气缸 容积 Displ. (Cm3)	商业标称 Power HP	电机类型 Motor Type	冷却方式 Cooling	制冷量 Capacity(W)54.4°C/ 130°F Condensing Temp.																能效比 COP W/W			输入功率 Input Power (W)			注油量 Oil Charge
						-35	-30	-25	-23.3	-20	-15	-10	-6.7	-5	0	5	7.2	10	15	-23.3	-6.7	7.2	-23.3	-6.7	7.2			
DW	TAWQD25HHY	2.5	1/12	CSIR	S	28	37	49	55	70	87	108	137	150	170	235	216	236	290	0.85	1.60	1.78	85	85	121	140		
	TAWQD30HHY	3.0	1/10	CSIR	S	33	45	59	65	85	105	130	165	180	205	235	260	288	350	0.85	1.60	1.80	76	103	145	140		
	TAWQD35HHY	3.5	1/8	CSIR	S	38	53	68	76	99	122	175	220	240	275	315	350	385	473	0.90	1.98	2.31	84	111	152	140		
DF	TAFQD43HHY	4.3	1/6	CSIR	S	47	65	83	93	121	149	215	270	296	335	387	430	473	639	0.95	2.01	2.36	98	134	182	180		
	TAFQD52HHY	4.9	1/6+	CSIR	S	56	78	101	112	145	179	245	310	340	368	440	490	539	661	1.00	2.01	2.37	112	154	207	180		
	TAFQD59HHY	5.5	1/5	CSIR	S	67	93	120	133	173	213	275	345	380	431	495	550	605	743	1.10	2.00	2.35	121	173	234	180		
	TAFQD65HHY	6.2	1/4	CSIR	S	80	112	145	160	208	256	312	390	430	488	568	630	695	850	1.15	2.05	2.41	139	190	261	180		
	TAFQD75HHY	7.2	1/4+	CSIR	S	90	126	163	180	234	293	336	420	463	523	585	670	740	905	1.30	2.05	2.41	138	205	278	180		
DL	TALQD75HHM	7.2	1/4+	CSIR	S/F	93	130	168	185	240	300	345	430	475	538	620	690	760	930	1.35	2.10	2.50	137	205	276	220		
	TALQD91HHM	8.8	1/3	CSIR	S/F	115	158	203	225	293	360	440	550	605	688	765	850	935	1150	1.37	2.12	2.51	164	259	339	220		
	TALQD110HHM	10.6	3/8	CSIR	F	140	195	250	280	365	450	520	650	720	810	945	1050	1155	1420	1.41	2.12	2.50	199	307	420	220		
	TALQD120HHM	11.6	1/2	CSIR	F	160	225	288	320	416	510	576	720	790	900	1030	1145	1260	1545	1.30	2.02	2.36	246	356	485	220		
DQ	TAQD128HHM	12.3	1/2	CSIR	F	175	245	315	350	455	560	615	770	845	960	1090	1215	1335	1640	1.30	2.02	2.36	271	381	515	250		
	TAQD142HHM	13.6	1/2+	CSIR	F	190	265	340	380	495	605	668	835	920	1045	1188	1320	1450	1780	1.31	2.02	2.37	290	413	557	250		
	TAQD158HHM	15.3	5/8	CSIR	F	210	295	380	420	545	670	740	925	1015	1155	1310	1460	1600	1970	1.30	2.02	2.36	323	458	619	250		

## R134a制冷压缩机技术参数

Technical Data of

QD Series R134a Refrigeration Compressor ( 208-230V/60Hz )

机型 Style	型号 Model	气缸 容积 Displ. (Cm3)	商业标称 Power HP	电机类型 Motor Type	冷却方式 Cooling	制冷量 Capacity(W)54.4°C/ 130°F Condensing Temp.																能效比 COP W/W			输入功率 Input Power (W)			注油量 Oil Charge
						-35	-30	-25	-23.3	-20	-15	-10	-6.7	-5	0	5	7.2	10	15	-23.3	-6.7	7.2	-23.3	-6.7	7.2			
DW	TBWQD25HHY	2.5	1/10	CSIR	S	32	44	58	64	83	103	127	160	176	200	230	256	283	345	0.85	1.70	1.90	75	94	135	140		
	TBWQD30HHY	3.0	1/8	CSIR	S	39	53	70	77	100	124	153	195	212	242	277	307	340	413	0.85	1.70	1.90	90	115	161	140		
	TBWQD35HHY	3.5	1/7	CSIR	S	45	63	80	90	117	144	207	260	283	325	372	413	454	558	0.90	1.98	2.31	100	131	179	140		
DF	TBFQD43HHY	4.3	1/6	CSIR	S	55	77	98	110	143	176	254	319	349	395	457	507	558	754	0.95	2.01	2.36	116	159	215	180		
	TBFQD52HHY	4.9	1/5	CSIR	S	66	92	119	132	171	211	289	366	401	434	519	578	636	780	1.00	2.01	2.37	132	182	244	180		
	TBFQD59HHY	5.5	1/4	CSIR	S	79	110	142	157	204	251	325	407	448	509	584	649	714	877	1.10	2.00	2.35	143	204	276	180		
	TBFQD65HHY	6.2	1/4+	CSIR	S	92	130	168	185	240	296	360	450	498	565	656	728	805	983	1.10	2.00	2.36	168	225	308	180		
	TBLQD65HHM	6.2	1/4+	CSIR	S	94	132	171	189	245	302	368	460	507	576	670	743	820	1003	1.25	2.05	2.41	151	224	308	220		
DL	TBLQD75HHM	7.2	1/3	CSIR	S/F	110	153	198	218	283	354	407	507	561	635	732	814	897	1097	1.35	2.10	2.50	162	242	326	220		
	TBLQD91HHM	8.8	1/3+	CSIR	S/F	136	186	240	266	346	425	519	649	714	812	903	1000	1103	1357	1.37	2.12	2.51	194	306	400	220		
	TBLQD110HHM	10.6	1/2	CSIR	F	165	230	295	330	431	531	614	767	850	956	1115	1239	1363	1676	1.41	2.12	2.50	234	362	496	220		
	TBLQD120HHM	11.6	1/2+	CSIR	F	188	265	340	378	490	605	680	850	935	1060	1215	1350	1485	1820	1.39	2.11	2.50	272	403	540	220		
DQ	TBQD128HHM	12.3	5/8	CSIR	F	207	289	372	413	537	661	726	910	997	1133	1286	1435	1575	1935	1.30	2.02	2.36	320	450	608	250		
	TBQD142HHM	13.6	5/8	CSIR	F	207	289	372	413	537	661	726	909	997	1133	1286	1560	1575	1935	1.31	2.02	2.37	320	450	608	250		
	TBQD158HHW	15.3	5/8+	CSCR	F	224	313	401	448	584	714	788	985	1086	1233	1402	1560	1711	2100	1.31	2.02	2.37	342	488	657	250		

## R134a制冷压缩机技术参数

Technical Data of

QD Series R134a Refrigeration Compressor ( 115-127V/60Hz )

机型 Style	型号 Model	气缸 容积 Displ. (Cm3)	商业标称 Power HP	电机类型 Motor Type	冷却方式 Cooling	制冷量 Capacity(W)54.4°C/ 130°F Condensing Temp.																能效比 COP W/W			输入功率 Input Power (W)			注油量 Oil Charge
						-35	-30	-25	-23.3	-20	-15	-10	-6.7	-5	0	5	7.2	10	15	-23.3	-6.7	7.2	-23.3	-6.7	7.2			
DW	TDWQD25HHY	2.5	1/10	CSIR	S	32	44	58	64	83	103	127	160	176	200	230	256	283	345	0.85	1.70	1.90	75	94	135	140		
	TDWQD30HHY	3.0	1/8	CSIR	S	40	54	71	78	117	125	207	260	283	325	372	413	454	558	0.85	1.70	1.90	100	115	163	140		
	TDFQD35HHY	3.5	1/7	CSIR	S	45	63	80	90	117	145	207	260	283	325	372	413	454	558	0.90	1.98	2.31	100	131	179	180		
DF	TDFQD43HHY	4.3	1/6	CSIR	S	55	77	98	110	143	177	254	319	349	395	457	507	558	754	0.95	2.01	2.36	116	159	215	180		
	TDFQD52HHY	4.9	1/5	CSIR	S	67	93	120	133	173	213	289	366	401	434	519	578	636	780	1.00	2.01	2.37	132	182	244	180		
	TDFQD59HHY	5.5	1/4	CSIR	S	79	110	142	158	205	252	325	407	448	509	584	649	714	877	1.10	2.00	2.35	143	204	276	180		
	TDFQD65HHY	6.2	1/4+	CSIR	S	92	129	168	185	240	296	360	450	498	563	650	723	800	980	1.10	2.00	2.35	168	225	308	180		
	TDLQD65HHM	6.2	1/4+	CSIR	S	95	133	173	190	248	305	372	465	510	580	670	745	825	1010	1.15	2.05	2.41	164	224	308	220		
DL	TDLQD75HHM	7.2	1/3	CSIR	S/F	105	147	189	210	274	354	407	510	561	635	732	820	897	1097	1.35	2.10	2.50	162	242	326	220		
	TDLQD91HHM	8.8	1/3+	CSIR	S/F	125	175	225	250	325	400	519	651	715	812	905	1010	1110	1360	1.37	2.12	2.51	194	306	400	220		
	TDLQD110HHM	10.6	1/2	CSIR	F	161	225	289	320	431	531	614	770	850	956	1115	1245	1363	1676	1.41	2.12	2.50	234	362	496	220		
	TDLQD120HHM	11.6	1/2+	CSIR	F	190	266	340	380	490	605	680	870	950	1080	1235	1380	1510	1855	1.40	2.12	2.50	271	408	550	250		
DQ	TDQD128HHM	12.3	5/8	CSIR	F	193	270	348	418	503	661	726	910	997	1133	1286	1435	1575	1935	1.30	2.02	2.36	320	450	608	250		
	*TDQD142HHW	13.6	5/8	CSCR	F	227	318	410	455	590	728	880	1110	1210	1375	1420	1580	1735	2130	1.31	2.03	2.37	341	546	667	250		
	*TDQD158HHW	15.3	5/8+	CSCR	F	244	341	439	487	634	780	866	1072	1177	1337	1518	1660	1859	2284	1.31	2.02	2.37	377	531	717	250		

以上规格参数满足LST启动方式, 如需HST, 请联系本公司订制。  
The above specifications are for LST starting torque, if you need HST, contact with us please.

# 低中高背压商用系列制冷压缩机

L/M/HBP Commercial Series Compressor

FN系列  
L/M/HBP  
R134a

## R134a制冷压缩机技术参数

Technical Data of

FN Series R134a Refrigeration Compressor ( 220-240V/50Hz )

机型 Style	型号 Model	气缸 容积 Displ. (Cm3)	商业标称 Power HP	电机类型 Motor Type	冷却方式 Cooling	制冷量 Capacity(W															
-------------	-------------	-----------------------------	---------------------	-----------------------	-----------------	-------------------	--	--	--	--	--	--	--	--	--	--	--	--	--	--	--



# 低中背压商用系列制冷压缩机

L/MBP Commercial Series Compressor

R134a制冷压缩机技术参数

Technical Data of

QD Series R134a Refrigeration Compressor ( 220-240V/50Hz )

QD系列  
L/MBP  
R134a

机型 Style	型号 Model	气缸 容积 Displ. (Cm3)	商业标称 Power HP	电机类型 Motor Type	冷却方式 Cooling	制冷量 Capacity(W)54.4℃/ 130°F Condensing Temp.										能效比 COP W/W		输入功率 Input Power (W)		注油量 Oil Charge
						-35	-30	-25	-23.3	-20	-15	-10	-6.7	-5	0	-23.3	-6.7	-23.3	-6.7	
						℃	℃	℃	℃	℃	℃	℃	℃	℃	℃	℃	℃	℃	℃	
DW	MAWQD25HHP	2.5	1/12	RSIR	S	30	40	52	58	75	93	126	140	156	175	0.85	1.90	68	74	140
	MAWQD30HHP	3.0	1/10	RSIR	S	35	49	63	70	90	112	152	170	188	210	0.85	1.90	82	89	140
DM	MAWQD35HHP	3.5	1/8	RSIR	S	40	56	72	80	105	128	176	220	242	275	0.90	1.98	89	111	140
	MAMQD43HHP	4.3	1/7	RSIR	S	47	65	83	110	121	149	216	270	297	338	0.95	2.01	116	134	160
DF	MAFQD52HHP	5.5	1/7	RSIR	S	70	95	123	136	177	218	280	350	385	438	1.15	2.01	118	174	180
	MAFQD59HHP	6.2	1/6	RSIR	S	85	115	149	165	215	265	312	390	430	488	1.16	2.01	142	194	180
DL	MALQD75HHR	7.2	1/5+	RSIR	S/F	105	147	190	210	273	337	387	495	545	618	1.20	2.05	175	241	180
	MALQD75HGR	7.6	1/5+	RSIR	S/F	105	147	190	220	273	337	387	495	545	618	1.36	2.11	162	235	220
DQ	MAQQD128HHR	12.3	3/8	CSIR	F	180	252	324	360	468	576	740	925	1018	1156	1.31	2.00	275	463	250
	MAQQD142HHR	13.5	3/8+	CSIR	F	195	273	351	390	507	624	800	1000	1100	1250	1.30	2.00	300	500	250
DQ	MAQQD158HHR	15.3	3/8+	CSIR	F	215	300	387	430	560	690	890	1120	1230	1400	1.30	2.00	331	560	250
	MAQQD168HHR	16.3	1/2	CSIR	F	230	322	415	460	598	736	976	1220	1340	1530	1.30	2.00	354	610	250

## R134a制冷压缩机技术参数

Technical Data of

QD Series R134a Refrigeration Compressor ( 208-230V/60Hz )

机型 Style	型号 Model	气缸 容积 Displ. (Cm3)	商业标称 Power HP	电机类型 Motor Type	冷却方式 Cooling	制冷量 Capacity(W)54.4℃/ 130°F Condensing Temp.										能效比 COP W/W		输入功率 Input Power (W)		注油量 Oil Charge
						-35	-30	-25	-23.3	-20	-15	-10	-6.7	-5	0	-23.3	-6.7	-23.3	-6.7	
						℃	℃	℃	℃	℃	℃	℃	℃	℃	℃	℃	℃	℃	℃	
DW	MBWQD25HHP	2.5	1/10	RSIR	S	35	48	62	70	90	111	143	166	183	208	0.83	1.85	84	90	140
	MBWQD30HHP	3.0	1/8	RSIR	S	41	58	74	83	106	132	170	200	220	250	0.85	1.90	97	106	140
DF	MBFQD43HHP	4.3	1/6	RSIR	S	65	90	117	130	170	210	270	320	350	400	1.18	2.05	110	156	180
	MBFQD52HHP	4.9	1/6	RSIR	S	75	101	130	150	188	232	328	390	428	488	1.20	2.08	125	188	180
DL	MBLQD65HHR	6.2	1/4	CSIR	S	112	152	197	218	284	350	435	540	560	640	1.32	2.10	165	257	220
	MBLQD75HHR	7.2	1/4	CSIR	S/F	124	173	207	230	322	398	445	595	580	655	1.35	2.10	170	243	220
DQ	MBQQD128HHR	12.3	3/8+	CSIR	F	195	273	350	390	507	624	800	1000	1100	1250	1.30	2.00	300	500	250
	MBQQD142HHR	13.6	1/2	CSIR	F	212	297	382	425	552	680	925	1090	1200	1360	1.31	2.00	324	546	250
DQ	MBQQD158HHR	15.3	3/8+	CSIR	F	230	322	414	460	598	736	1000	1180	1300	1480	1.30	2.00	354	590	250
	MBQQD168HHR	16.3	1/2	CSCR	F	252	353	455	505	656	808	1055	1320	1450	1650	1.30	2.00	388	660	250

## R134a制冷压缩机技术参数

Technical Data of

QD Series R134a Refrigeration Compressor ( 115-127V/60Hz )

机型 Style	型号 Model	气缸 容积 Displ. (Cm3)	商业标称 Power HP	电机类型 Motor Type	冷却方式 Cooling	制冷量 Capacity(W)54.4℃/ 130°F Condensing Temp.										能效比 COP W/W		输入功率 Input Power (W)		注油量 Oil Charge
						-35	-30	-25	-23.3	-20	-15	-10	-6.7	-5	0	-23.3	-6.7	-23.3	-6.7	
						℃	℃	℃	℃	℃	℃	℃	℃	℃	℃	℃	℃	℃	℃	
DW	MDWQD25HHP	2.5	1/10	CSIR	S	35	49	62	70	92	112	143	168	183	210	0.85	1.90	82	88	140
	MDWQD30HHP	3.0	1/8	CSIR	S	42	59	75	84	110	135	172	202	220	253	0.86	1.95	98	104	140
DF	MDFQD35HHP	3.5	1/7	CSIR	S	48	67	86	96	125	155	225	263	290	330	0.92	1.98	104	133	180
	MDFQD43HHP	4.3	1/6	CSIR	S	65	90	117	130	170	210	270	320	350	400	1.18	2.05	110	156	180
DL	MDLQD65HHR	6.2	1/4	CSIR	S	112	152	197	218	284	350	435	540	560	640	1.32	2.10	165	257	220
	MDLQD75HHR	7.2	1/4	CSIR	S/F	124	173	207	230	322	398	445	595	580	655	1.35	2.10	170	243	220
DQ	MDQQD128HHR	12.3	3/8	CSIR	F	195	273	350	390	507	624	800	1000	1100	1250	1.30	2.00	300	500	250
	MDQQD142HHR	13.6	1/2	CSIR	F	212	297	382	425	552	680	925	1090	1200	1360	1.31	2.00	324	546	250
DQ	MDQQD158HHR	15.3	3/8+	CSCR	F	230	322	414	460	598	736	1000	1180	1300	1480	1.30	2.00	354	590	250
	MDQQD168HHR	16.3	1/2	CSCR	F	252	353	455	505	656	808	1055	1320	1450	1650	1.30	2.00	388	660	250

以上规格参数满足LST启动方式, 如需HST, 请联系本公司订制。  
The above specifications are for LST starting torque, if you need HST, contact with us please.

# 中高背压商用系列制冷压缩机

M/HBP Commercial Series Compressor

R134a制冷压缩机技术参数

Technical Data of

QD Series R134a Refrigeration Compressor ( 220-240V/50Hz )

QD系列  
M/HBP  
R134a

机型 Style	型号 Model	气缸 容积 Displ. (Cm3)	商业标称 Power HP	电机类型 Motor Type	冷却方式 Cooling	制冷量 Capacity(W)54.4℃/ 130°F Condensing Temp.										能效比 COP W/W		输入功率 Input Power (W)		注油量 Oil Charge
						-20	-15	-10	-6.7	-5	0	5	7.2	10	15	-6.7	7.2	-6.7	7.2	
						℃	℃	℃	℃	℃	℃	℃	℃	℃	℃	℃	℃	℃	℃	
DW	HAWQD30HHP	3.0	1/8	RSIR	S	90	120	150	190	210	225	273	300	345	420	1.90	2.18	100	138	140
	HAWQD35HHP	3.5	1/7	RSIR	S	105	140	175	220	245	263	318	350	403	490	1.98	2.31	111	152	140
DF	HAFQD52HHP	4.9	1/6+	RSIR	S	145	196	245	310	343	368	446	490	563	686	2.01	2.37	154	207	180
	HAFQD59HHP	5.5	1/5	RSIR	S	165	220	275	345	385	413	500	550	633	770	2.00	2.35	173	234	180
DL	HALQD75HHR	7.2	1/4	RSIR	S/F	200	270	340	420	475	505	600	660	760	925	2.05	2.38	205	277	180
	HALQD91HHR	8.8	1/4+	RSIR	S/F	250	332	415	530	580	623	747	830	955	1160	2.12	2.51	250	331	220
DQ	HAQQD128HHR	12.3	3/8+	CSIR	F	395	528	660	830	924	960	1200	1320	1518	1848	2.02	2.36	411	559	250
	HAQQD142HHR	13.6	1/2	CSIR	F	440	586	733	920	1026	1099	1333	1465	1685	1978	2.02	2.37	455	618	250
DQ	HAQQD158HHR	15.3	1/2+	CSIR	F	480	640	800	1008	1120	1200	1456	1600	1840	2160	2.02	2.37	499	675	250
	*HAQQD168HHR	16.3	5/8	CSCR	F	510	680	850	1070	1190	1270	1540	1700	1950	2290	2.10	2.50	510	680	250

## R134a制冷压缩机技术参数

Technical Data of

QD Series R134a Refrigeration Compressor ( 208-230V/60Hz )

机型 Style	型号 Model	气缸 容积 Displ. (Cm3)	商业标称 Power HP	电机类型 Motor Type	冷却方式 Cooling	制冷量 Capacity(W)54.4℃/ 130°F Condensing Temp.										能效比 COP W/W		输入功率 Input Power (W)		注油量 Oil Charge
						-20	-15	-10	-6.7	-5	0	5	7.2	10	15	-6.7	7.2	-6.7	7.2	
						℃	℃	℃	℃	℃	℃	℃	℃	℃	℃	℃	℃	℃	℃	
DW	HBWQD30HHP	3.0	1/7	RSIR	S	105	142	177	224	248	266	322	354	407	496	1.90	2.18	118	162	140
	HBWQD35HHP	3.5	1/6	RSIR	S	125	165	207	260	289	310	375	413	476	578	1.98	2.31	131	179	140
DF	HBFQD43HHP	4.3	1/6+	RSIR	S	152	203	254	319	354	381	461	507	584	708	2.01	2.36	159	215	180
	HBFQD52HHP	4.9	1/5	RSIR	S	173	231	289	366	405	434	526	578	664	809	2.01	2.37	182	244	180
DL	HBLQD65HHR	6.2	1/4	CSIR	S	210	285	360	450	505	540	650	720	830	980	2.01	2.35	224	306	180
	HBLQD75HHR	7.2	1/4+	CSIR	S/F	245	326	407	507	570	611	741	814	938	1139	2.10	2.51	242	324	220
DQ	HBLQD128HHR	12.3	3/8+	CSIR	F	365	485	608	767	850	910	1103	1213	1395	1698	2.12	2.52	362	481	220
	HBLQD142HHR	1																		

# 低背压商用系列制冷压缩机

LBP Commercial Series Compressor

R134a制冷压缩机技术参数

Technical Data of

QD Series R134a Refrigeration Compressor ( 220-240V/50Hz )

QD系列  
LBP  
R134a

机型 Style	型号 Model	气缸 容积 Displ. (Cm3)	商业标称 Power HP	电机类型 Motor Type	冷却方式 Cooling	制冷量 Capacity(W)54.4°C/ 130°F Condensing Temp.						能效比 COP W/W	输入功率 Input Power (W)	注油量 Oil Charge
						-35 °C	-30 °C	-25 °C	-23.3 °C	-20 °C	-15 °C			
DW	LAWQD25HHP	2.5	1/12	RSIR	S	32	45	58	65	85	105	0.85	76	140
	LAWQD30HHP	3.0	1/10	RSIR	S	38	53	68	76	98	120	1.00	76	140
	LAWQD35HHP	3.5	1/10+	RSIR	S	45	60	79	88	115	140	1.00	88	140
DM	LAMQD43HHP	4.3	1/7	RSIR	S	57	80	103	115	150	185	1.10	105	160
	LAMQD52HHP	4.9	1/7	RSIR	S	66	90	116	130	170	208	1.18	110	160
DF	LAFQD59HHP	5.5	1/6	RSIR	S	75	105	135	150	195	240	1.30	115	180
	LAFQD65HHP	6.2	1/6+	RSIR	S	85	118	150	168	218	268	1.30	129	180
	LAFQD75HHP	6.8	1/5	RSIR	S	92	130	167	185	240	312	1.30	142	180
DL	LAFQD91HHP	8.3	1/5+	RSIR	S/F	105	146	190	210	270	335	1.30	162	180
	LALQD75HHR	7.2	1/5+	RSIR	S/F	100	140	160	200	260	320	1.35	148	220
	LALQD75HGR	7.6	1/5+	RSIR	S/F	105	147	190	220	273	337	1.36	162	220
	LALQD91HHR	8.8	1/5+	RSIR	S/F	115	160	207	245	300	368	1.37	179	220
	LALQD91HGR	9.3	1/4-	RSIR	S/F	127	176	228	270	330	405	1.41	191	220
	LALQD110HHR	10.0	1/4	RSIR	F	136	190	245	300	375	460	1.38	217	220
DQ	LALQD110HGR	11.1	1/4+	RSIR	F	150	210	270	330	410	510	1.42	232	220
	LAQQD128HHR	12.3	3/8	CSIR	F	180	252	324	360	468	576	1.31	275	250
	LAQQD142HHR	13.6	3/8+	CSIR	F	195	273	351	390	507	624	1.30	300	250
	LAQQD158HHR	15.3	3/8+	CSIR	F	215	300	387	430	560	690	1.30	331	250
LAQQD168HHR	16.3	1/2	CSIR	F	230	322	415	460	598	736	1.30	354	250	

R134a制冷压缩机技术参数

Technical Data of

QD Series R134a Refrigeration Compressor ( 208-230V/60Hz )

机型 Style	型号 Model	气缸 容积 Displ. (Cm3)	商业标称 Power HP	电机类型 Motor Type	冷却方式 Cooling	制冷量 Capacity(W)54.4°C/ 130°F Condensing Temp.						能效比 COP W/W	输入功率 Input Power (W)	注油量 Oil Charge
						-35 °C	-30 °C	-25 °C	-23.3 °C	-20 °C	-15 °C			
DW	LBWQD25HHP	2.5	1/8	RSIR	S	38	53	68	76	99	122	0.80	95	140
	LBWQD30HHP	3.0	1/8	RSIR	S	45	63	80	90	115	145	0.90	100	140
	LBWQD35HHP	3.5	1/7	RSIR	S	51	72	93	103	133	165	1.00	103	140
DF	LBFQD43HHP	4.3	1/6	RSIR	S	68	95	122	136	177	220	1.05	130	180
	LBFQD52HHP	4.9	1/5	RSIR	S	80	112	145	160	210	255	1.10	145	180
	LBFQD59HHP	5.5	1/5	RSIR	S	93	130	168	186	240	300	1.20	155	180
	LBFQD65HHP	6.2	1/5+	RSIR	S	105	145	188	208	270	330	1.20	173	180
DL	LBLQD65HHR	6.2	1/4	CSIR	S	108	148	190	210	230	283	1.32	165	220
	LBLQD75HHR	7.2	1/4	CSIR	S/F	100	139	207	230	257	316	1.35	170	220
	LBLQD91HHR	8.8	1/4	CSIR	S/F	124	173	224	270	322	398	1.37	197	220
	LBLQD110HHR	10.6	1/3	CSIR	S/F	160	224	289	348	443	543	1.41	238	220
DQ	LBLQD120HHR	11.6	3/8	CSIR	F	195	273	350	390	507	624	1.30	300	220
	LBOQD128HHR	12.3	3/8+	CSIR	F	177	248	319	389	484	602	1.31	274	250
	LBOQD142HHR	13.6	1/2	CSIR	F	212	297	382	425	552	680	1.30	325	250
	LBOQD158HHR	15.3	1/2	CSIR	F	252	353	455	505	656	808	1.30	388	250
*LBOQD168HHR	16.3	1/2	CSCR	F	275	380	495	550	715	880	1.35	407	250	

R134a制冷压缩机技术参数

Technical Data of

QD Series R134a Refrigeration Compressor ( 115-127V/60Hz )

机型 Style	型号 Model	气缸 容积 Displ. (Cm3)	商业标称 Power HP	电机类型 Motor Type	冷却方式 Cooling	制冷量 Capacity(W)54.4°C/ 130°F Condensing Temp.						能效比 COP W/W	输入功率 Input Power (W)	注油量 Oil Charge
						-35 °C	-30 °C	-25 °C	-23.3 °C	-20 °C	-15 °C			
DW	LDWQD25HHP	2.5	1/8	RSIR	S	38	53	68	77	100	125	0.86	90	140
	LDWQD30HHP	3.0	1/8	RSIR	S	45	63	80	90	115	145	0.95	95	140
DF	LDFQD35HHP	3.5	1/7	RSIR	S	53	75	95	105	135	170	1.06	99	180
	LDFQD43HHP	4.3	1/6	RSIR	S	70	97	123	138	180	225	1.12	123	180
	LDFQD52HHP	4.9	1/5	RSIR	S	80	112	145	160	210	255	1.15	139	180
	LDFQD59HHP	5.5	1/5	RSIR	S	94	130	170	188	243	305	1.27	148	180
DL	LDFQD65HHP	6.2	1/5+	RSIR	S	105	146	190	210	272	333	1.26	167	180
	LDLQD65HHR	6.2	1/4	CSIR	S	110	150	193	212	275	335	1.32	165	220
	LDLQD75HHR	7.2	1/4	CSIR	S/F	80	112	207	230	209	260	1.35	170	220
	LDLQD91HHR	8.8	1/4	CSIR	S/F	104	146	188	270	272	334	1.37	197	220
	LDLQD110HHR	10.6	1/3	CSIR	F	189	265	341	348	522	641	1.41	238	220
	LDLQD120HHR	11.6	3/8	CSIR	F	195	273	350	390	507	624	1.30	300	220
DQ	LDOQD128HHR	12.3	3/8+	CSIR	F	230	322	413	389	598	736	1.31	354	250
	*LDQQD142HHR	13.6	1/2	CSCR	F	209	292	376	425	571	710	1.35	340	250
	*LDQQD158HHR	15.3	1/2	CSCR	F	252	353	455	505	656	808	1.35	374	250
	*LDQQD168HHR	16.3	1/2+	CSCR	F	275	380	495	550	715	880	1.35	407	250

以上规格参数满足LST启动方式, 如需HST, 请联系本公司订制。  
The above specifications are for LST starting torque, if you need HST, contact with us please.

# 低中背压商用系列制冷压缩机

L/MBP Commercial Series Compressor

QD系列  
L/MBP  
R134a

R134a制冷压缩机技术参数

Technical Data of

QD Series R134a Refrigeration Compressor ( 220-240V/50Hz ~ 60Hz )

机型 Style	型号 Model	气缸 容积 Displ. (Cm3)	商业标称 Power HP	电机类型 Motor Type	冷却方式 Cooling	频率	制冷量 Capacity(W)54.4°C/ 130°F Condensing Temp.												能效比 COP W/W	输入功率 Input Power (W)	注油量 Oil Charge
							-35 °C	-30 °C	-25 °C	-23.3 °C	-20 °C	-15 °C	-10 °C	-6.7 °C	-5 °C	0 °C	-23.3 °C	-6.7 °C			
DW	MFWQD25HHP	2.5	1/10	RSIR	S	50	27	38	50	55	70	88	108	138	150	170	0.85	1.60	65	86	140
							60	32	44	58	64	83	103	127	160	176	200	0.85	1.60	75	100
	MFWQD30HHP	3.0	1/10	RSIR	S	50	33	45	59	65	85	105	130	165	180	205	0.85	1.60	76	103	140
							60	39	53	70	77	100	124	153	195	212	242	0.85	1.70	90	115
	MFWQD35HHP	3.5	1/8	RSIR	S	50	38	53	68	76	99	122	175	220	240	275	0.90	1.98	84	111	140
							60	45	63	80	90	117	144	207	260	283	325	0.90	1.98	100	131
DF	MFFQD43HHP	4.3	1/6	RSIR	S	50	47	65	83	93	121	149	215	270	296	335	0.95	2.01	98	134	180
							60	55	77	98	110	143	176	254	319	349	395	0.95	2.01	116	159
	MFFQD52HHP	4.9	1/6+	RSIR	S	50	56	78	101	112	145	179	245	310	340	368	1.00	2.01	112	154	180
							60	66	92	119	132	171	211	289	366	401	434	1.00	2.01	132	182
	MFFQD59HHP	5.5	1/5	RSIR	S	50	67	93	120	133	173	213	275	345	380	431	1.10	2.00	121	173	180
							60	79	110	142	157	204	251	325	407	448	509	1.10	2.00	143	204
MFFQD65HHP	6.2	1/4	RSIR	S	50	80	112	145	160	208	256	312	390	430	488	1.15	2.05	139	190	180	
						60	92	130	168	185	240	296	360	450	498	565	1.10	2.00	168	225	180
DL	MFLQD75HHR	7.2	1/4+	CSIR	S/F	50	93	130	168	185	240	300	345	430	475	538	1.35	2.10	137	205	220
							60	110	153	198	218	283	354	407	507	561	635	1.35	2.10	162	242
	MFLQD91HHR	8.8	1																		

# 中高背压商用系列制冷压缩机

M/HBP Commercial Series Compressor

QD系列  
M/HBP  
R134a

## R134a制冷压缩机技术参数

Technical Data of  
QD Series R134a Refrigeration Compressor ( 220-240V/50Hz ~ 60Hz )

机型 Style	型号 Model	气缸 容积 Displ. (Cm3)	商业标称 Power HP	电机类型 Motor Type	冷却方式 Cooling	频率	制冷量 Capacity(W)54.4°C/ 130°F Condensing Temp.												能效比 COP W/W			输入功率 Input Power (W)			注油量 Oil Charge			
							-20 -15 -10 -6.7 -5 0 5 7.2 10 15 -6.7 7.2 -6.7 7.2												-23.3 -8.7 7.2 -23.3 -8.7 7.2			-23.3 -8.7 7.2						
							-20	-15	-10	-6.7	-5	0	5	7.2	10	15	-6.7	7.2	-6.7	7.2	-23.3	-8.7	7.2	-23.3		-8.7	7.2	-23.3
DW	HFWQD25HHP	2.5	1/12	RSIR	S	50	71	63	108	138	150	171	196	216	240	290	1.60	1.80	86	120	140	1.15	1.70	2.80	40	64	68	140
							60	83	88	128	163	176	202	231	256	280	345	1.70	1.90	96	135							
	HFWQD30HHP	3.0	1/10	RSIR	S	50	85	105	130	165	180	205	235	260	288	350	1.60	1.80	103	145	140	1.15	1.70	2.80	48	76	82	140
							60	100	124	153	195	212	242	277	307	340	413	1.70	1.90	115	161							
	HFWQD35HHP	3.5	1/8	RSIR	S	50	99	122	175	220	240	275	315	350	385	473	1.98	2.31	111	152	140	1.15	1.70	2.80	61	94	102	140
							60	117	144	207	260	283	325	372	413	454	558	1.98	2.31	131	179							
DF	HFFQD43HHP	4.3	1/6	RSIR	S	50	121	149	215	270	296	335	387	430	473	639	2.01	2.36	134	182	180	1.15	1.70	2.80	50	78	82	140
							60	143	176	254	319	349	395	457	507	558	754	2.01	2.36	159	215							
	HFFQD52HHP	4.9	1/6+	RSIR	S	50	145	179	245	310	340	368	440	490	539	661	2.01	2.37	154	207	180	1.15	1.70	2.80	71	111	118	140
							60	171	211	289	366	401	434	519	578	636	780	2.01	2.37	182	244							
	HFFQD59HHP	5.5	1/5	RSIR	S	50	173	213	275	345	380	431	495	550	605	743	2.00	2.35	173	234	180	1.15	1.70	2.80	82	122	126	140
							60	204	251	325	407	448	509	584	649	714	877	2.00	2.35	204	276							
DL	HFLQD65HHP	6.2	1/4	CSIR	S	50	208	256	312	390	430	488	568	630	695	850	2.05	2.41	190	261	180	1.15	1.70	2.80	82	122	126	140
							60	240	296	360	450	498	565	656	728	805	983	2.00	2.36	225	308							
	HFLQD75HHP	7.2	1/4+	CSIR	S/F	50	240	300	345	430	475	538	620	690	760	930	2.10	2.50	205	276	220	1.15	1.70	2.80	82	122	126	140
							60	283	354	407	507	561	635	732	814	897	1097	2.10	2.50	242	326							
	HFLQD91HHP	8.8	1/3	CSIR	S/F	50	293	360	440	550	605	688	765	850	935	1150	2.12	2.51	259	339	220	1.15	1.70	2.80	82	122	126	140
							60	346	425	519	649	714	812	903	1000	1103	1357	2.12	2.51	306	400							
HFLQD110HHP	10.6	3/8	CSIR	F	50	365	450	520	650	720	810	945	1050	1155	1420	2.12	2.50	307	420	220	1.15	1.70	2.80	82	122	126	140	
						60	431	531	614	767	850	956	1115	1239	1363	1676	2.12	2.50	362	496								220
DQ	HFQD128HHP	12.3	1/2	CSIR	F	50	455	560	615	770	845	960	1090	1215	1335	1640	2.02	2.36	381	515	250	1.15	1.70	2.80	82	122	126	140
							60	537	661	726	910	997	1133	1286	1435	1575	1935	2.02	2.36	450	608							
HFQD142HHP	13.6	1/2+	CSIR	F	50	495	605	668	835	920	1045	1188	1320	1450	1780	2.02	2.37	413	557	250	1.15	1.70	2.80	82	122	126	140	
						60	584	714	788	985	1086	1233	1402	1560	1711	2100	2.02	2.37	488	657								250

以上规格参数满足LST启动方式, 如需HST, 请联系本公司订制。  
The above specifications are for LST starting torque, if you need HST, contact with us please.

# 低中高背压商用系列制冷压缩机

L/M/HBP Commercial Series Compressor

QD/DM/DF/DW系列  
L/M/HBP  
R600a

## R600a制冷压缩机技术参数

Technical Data of  
QD Series R600a Refrigeration Compressor ( 220-240V/50Hz )

机型 Style	型号 Model	气缸 容积 Displ. (Cm3)	商业标称 Power HP	电机类型 Motor Type	冷却方式 Cooling	制冷量 Capacity(W)54.4°C/ 130°F Condensing Temp.												能效比 COP W/W			输入功率 Input Power (W)			注油量 Oil Charge		
						-35 -30 -25 -23.3 -20 -15 -10 -6.7 -5 0 5 7.2 10 15 -23.3 -8.7 7.2 -23.3 -8.7 7.2												-23.3 -8.7 7.2			-23.3 -8.7 7.2					
						-35	-30	-25	-23.3	-20	-15	-10	-6.7	-5	0	5	7.2	10	15	-23.3	-8.7	7.2	-23.3		-8.7	7.2
DW	TAWQD30YHP	3.0	1/12	RSIR	S	20	30	40	46	57	70	93	108	115	145	170	190	212	258	1.15	1.70	2.80	40	64	68	140
	TAWQD35YHP	3.5	1/12	RSIR	S	25	35	48	56	68	85	112	130	138	175	206	230	255	310	1.15	1.70	2.80	48	76	82	140
	TAWQD43YHP	4.3	1/10	RSIR	S	30	45	60	70	85	105	140	160	170	215	255	285	315	385	1.15	1.70	2.80	61	94	102	140
	TAWQD52YHP	5.2	1/10	RSIR	S	35	50	70	80	95	120	165	185	195	245	290	325	360	440	1.20	1.70	2.80	67	108	116	140
DM	TAMDM65YHP	6.5	1/7	RSIR	S	50	70	95	108	130	160	215	245	260	320	390	430	475	580	1.30	1.75	2.85	83	140	151	160
	TAFDF75YHP	7.5	1/6	RSIR	S	55	80	105	122	145	185	250	280	300	370	445	495	545	670	1.30	1.75	2.85	94	160	173	180
DF	TAFDF85YHP	8.5	1/5	RSIR	S	60	90	120	135	165	205	275	315	330	410	495	550	605	740	1.35	1.85	2.90	100	170	190	180
	TAFDF91YHP	9.1	1/5	RSIR	S	65	95	125	143	170	215	290	330	350	435	520	580	640	780	1.35	1.85	2.90	106	178	200	180
	TAFDF103YHP	10.3	1/5+	RSIR	S/F	70	105	140	160	195	240	335	380	400	500	600	670	740	900	1.40	2.00	3.00	114	190	223	180
	TAFDF110YHP	11.1	1/5+	RSIR	S/F	75	110	150	170	205	255	350	400	420	525	630	700	770	945	1.40	2.00	3.00	121	200	233	180
DL	TALQD118YHP	11.8	1/5+	RSIR	F	80	115	160	180	215	270	375	420	440	550	660	735	810	985	1.43	2.05	3.05	126	205	241	220
	TALQD128YHP	12.8	1/4	RSIR	F	85	125	165	190	230	285	390	425	470	585	700	780	858	1050	1.43	2.05	3.05	133	207	256	220
DQ	TAQQD142YHP	14.2	1/4+	RSIR	F	105	150	200	230	275	345	470	535	565	705	845	940	1030	1270	1.40	1.95	2.95	164	274	319	250
	TAQQD158YHP	15.8	1/3	RSIR	F	115	165	225	255	310	385	525	590	630	790	945	1050	1155	1420	1.40	1.95	2.95	182	303	356	250

## R600a制冷压缩机技术参数

Technical Data of  
QD Series R600a Refrigeration Compressor ( 208-230V/60Hz )

机型 Style	型号 Model	气缸 容积 Displ. (Cm3)	商业标称 Power HP	电机类型 Motor Type	冷却方式 Cooling	制冷量 Capacity(W)54.4°C/ 130°F Condensing Temp.												能效比 COP W/W			输入功率 Input Power (W)			注油量 Oil Charge		
						-35 -30 -25 -23.3 -20 -15 -10 -6.7 -5 0 5 7.2 10 15 -23.3 -8.7 7.2 -23.3 -8.7 7.2												-23.3 -8.7 7.2			-23.3 -8.7 7.2					
						-35	-30	-25	-23.3	-20	-15	-10	-6.7	-5	0	5	7.2	10	15	-23.3	-8.7	7.2	-23.3		-8.7	7.2
DW	TBWQD30YHP	3.0	1/12	RSIR	S	25	35	50	58	70	85	115	130	140	170	205	230	255	345	1.15	1.70	2.80	50	78	82	140
	TBWQD35YHP	3.5	1/12	RSIR	S	30	40	60	66	80	100	135	155	160	200	240	265	295	400	1.15	1.70	2.80	57	91	95	140
	TBWQD43YHP	4.3	1/10	RSIR	S	35	52	72	82	98	123	168	188	197	246	295	330	365	493	1.15	1.70	2.80	71	111	118	140
	TBWQD52YHP	5.2	1/8	RSIR	S	42	60	81	92	110	138	186	210	225	280	335	370	412	560	1.18	1.71	2.82	78	123	132	140
DM	TBMDM65YHP	6.5	1/6	RSIR	S	55	80	110	126	150	190	246	285	300	375	450	500	550	750	1.31	1.76	2.86	96	162	175	160
	TBDF75YHP	7.5	1/6	RSIR	S	60	90	122	140	170	212	285	325	345	430	520	580	640	870	1.32	1.77	2.87	106	184	202	180
DF	TBDF85YHP	8.5	1/5	RSIR	S	70	100	140	158	187	235	320	365	383	480	580	645	710	970	1.36	1.85	2.90	116	197	223	180
	TBDF91YHP	9.1	1/5	RSIR</																						

# 低背压系列制冷压缩机

LBP Series Compressor

R600a制冷压缩机技术参数

Technical Data of QD Series R600a Refrigeration Compressor ( 220-240V/50Hz )

QD/DM/DF/DW系列  
LBP  
R600a

机型 Style	型号 Model	气缸 容积 Displ. (Cm3)	商业标称 Power HP	电机类型 Motor Type	冷却方式 Cooling	制冷量 Capacity(W)54.4°C/ 130°F Condensing Temp.						能效比 COP W/W	输入功率 Input Power (W)	注油量 Oil Charge
						-35°C	-30°C	-25°C	-23.3°C	-20°C	-15°C			
DW	LAWQD30YHP	3.0	1/12	RSIR	S	25	33	43	50	58	75	1.15	44	140
	LAWQD35YHP	3.5	1/12	RSIR	S	30	40	52	60	70	90	1.15	52	140
	LAWQD43YHP	4.3	1/12	RSIR	S	36	50	65	73	87	110	1.15	63	140
	LAWQD52YHP	5.2	1/12	RSIR	S	43	60	80	88	106	132	1.15	77	140
DM	LAWQD60YHP	6.0	1/10	RSIR	S	48	68	90	100	120	150	1.15	87	140
	LAMD65YHP	6.5	1/10	RSIR	S	56	76	102	112	135	170	1.38	81	150
DF	LAMD75YHP	7.5	1/8	RSIR	S	65	91	120	132	158	200	1.38	96	150
	LAFDF85YHP	8.5	1/8	RSIR	S	73	102	132	145	175	218	1.46	99	160
	LAFDF91YHP	9.1	1/7	RSIR	S	79	110	143	158	190	238	1.46	108	160
	LAFDF103YHP	10.3	1/7	RSIR	S	88	123	160	176	210	260	1.51	117	160
	LAFDF110YHP	11.1	1/6	RSIR	S	95	130	171	188	226	280	1.51	125	160
	LAFDF118YHP	11.8	1/6	RSIR	S/F	101	140	183	202	240	303	1.55	130	180
	LAFDF128YHP	12.8	1/6	RSIR	S/F	110	153	198	218	260	330	1.55	140	180
	LALQD142YHP	14.2	1/5	RSIR	F	120	167	216	238	286	358	1.51	157	220
DQ	LAQD158YHP	15.8	1/5	RSIR	F	135	188	245	268	320	400	1.51	177	250

R600a制冷压缩机技术参数

Technical Data of QD Series R600a Refrigeration Compressor ( 208-230V/60Hz )

机型 Style	型号 Model	气缸 容积 Displ. (Cm3)	商业标称 Power HP	电机类型 Motor Type	冷却方式 Cooling	制冷量 Capacity(W)54.4°C/ 130°F Condensing Temp.						能效比 COP W/W	输入功率 Input Power (W)	注油量 Oil Charge
						-35°C	-30°C	-25°C	-23.3°C	-20°C	-15°C			
DM	LBWQD30YHP	3.0	1/12	RSIR	S	30	40	55	60	70	90	1.25	48	140
	LBWQD35YHP	3.5	1/12	RSIR	S	35	48	63	70	85	105	1.25	56	140
	LBWQD43YHP	4.3	1/11	RSIR	S	43	60	78	86	103	130	1.26	68	140
	LBWQD52YHP	5.2	1/9	RSIR	S	52	73	96	105	126	158	1.31	80	140
DF	LBDF65YHP	6.5	1/8	RSIR	S	66	92	120	132	158	200	1.38	95	160
	LBDF75YHP	7.5	1/7	RSIR	S	78	110	143	157	188	235	1.38	113	160
	LBDF85YHP	8.5	1/6	RSIR	S	86	120	157	173	208	260	1.46	118	160
	LBDF91YHP	9.1	1/6	RSIR	S	93	130	170	187	225	280	1.46	128	160
	LBDF103YHP	10.3	1/5	RSIR	S/F	105	146	188	210	250	315	1.51	139	180
DL	LBLQD110YHP	11.1	1/5	RSIR	S/F	110	155	202	222	266	333	1.51	147	220
	LBLQD118YHP	11.8	1/5	RSIR	F	120	166	215	238	285	358	1.55	153	220
	LBLQD128YHP	12.8	1/4	RSIR	F	130	180	235	258	310	388	1.55	166	220
DQ	LBQQD142YHP	14.2	1/4	RSIR	F	140	197	255	282	338	425	1.51	186	250
	LBQQD158YHP	15.8	1/4	RSIR	F	158	220	288	316	380	475	1.51	209	250

R600a制冷压缩机技术参数

Technical Data of QD Series R600a Refrigeration Compressor ( 115-127V/60Hz )

机型 Style	型号 Model	气缸 容积 Displ. (Cm3)	商业标称 Power HP	电机类型 Motor Type	冷却方式 Cooling	制冷量 Capacity(W)54.4°C/ 130°F Condensing Temp.						能效比 COP W/W	输入功率 Input Power (W)	注油量 Oil Charge
						-35°C	-30°C	-25°C	-23.3°C	-20°C	-15°C			
DM	LDMQD30YHP	3.0	1/12	RSIR	S	30	45	55	60	73	93	1.25	48	140
	LDMQD35YHP	3.5	1/12	RSIR	S	35	50	65	70	85	108	1.25	56	140
	LDWQD43YHP	4.3	1/11	RSIR	S	45	62	80	88	105	133	1.28	69	140
	LDWQD52YHP	4.9	1/9	RSIR	S	53	75	97	106	128	160	1.31	80	140
DF	LDFDF65YHP	6.5	1/8	RSIR	S	65	91	119	131	156	198	1.38	95	160
	LDFDF75YHP	7.5	1/7	RSIR	S	77	111	142	158	190	238	1.38	114	160
	LDFDF85YHP	8.5	1/6	RSIR	S	85	121	156	174	210	263	1.46	119	160
	LDFDF91YHP	9.1	1/6	RSIR	S	95	131	172	188	226	283	1.46	128	160
	LDFDF103YHP	10.3	1/5	RSIR	S/F	106	147	190	212	250	315	1.51	140	220
DL	LDLQD110YHP	11.1	1/5	RSIR	S/F	111	156	203	224	268	336	1.51	148	220
	LDLQD118YHP	11.8	1/5	RSIR	F	121	167	216	240	287	360	1.56	154	220
	LDLQD128YHP	12.8	1/4	RSIR	F	131	182	236	260	312	390	1.56	167	220
DQ	LDQQD142YHM	14.2	1/4	CSIR	F	141	198	257	285	340	430	1.52	187	250
	LDQQD158YHM	15.8	1/4	CSIR	F	160	225	290	320	386	480	1.52	211	250

以上规格参数满足LST启动方式, 如需HST, 请联系本公司订制。  
The above specifications are for LST starting torque, if you need HST, contact with us please.

# 低中背压商用系列制冷压缩机

L/MBP Commercial Series Compressor

R290制冷压缩机技术参数

Technical Data of QD Series R290 Refrigeration Compressor ( 220-240V/50Hz )

QD系列  
L/MBP  
R290

机型 Style	型号 Model	气缸 容积 Displ. (Cm3)	商业标称 Power HP	电机类型 Motor Type	冷却方式 Cooling	制冷量 Capacity(W)54.4°C/ 130°F Condensing Temp.											能效比 COP W/W	输入功率 Input Power (W)	注油量 Oil Charge	
						-35°C	-30°C	-25°C	-23.3°C	-20°C	-15°C	-10°C	-6.7°C	-5°C	0°C					
																				-23.3°C
DF	*MAFQD30UHP	3.0	1/8	RSIR	S	105	95	120	135	155	180	210	235	260	295	1.25	1.75	108	134	180
	MAFQD35UHP	3.5	1/6	RSIR	S	96	110	145	160	185	215	250	280	310	380	1.25	1.75	128	160	180
	MAFQD43UHP	4.3	1/5	RSIR	S	120	140	180	200	230	270	315	350	385	435	1.30	1.80	153	195	180
	MAFQD52UHP	5.2	1/5	RSIR	S	135	160	205	230	265	310	350	390	430	490	1.30	1.80	177	216	180
	MAFQD59UHP	6.2	1/5	RSIR	S	158	190	248	275	310	370	425	475	525	590	1.30	1.80	212	263	180
DL	MALQD59UHR	5.9	1/5+	RSIR	S	158	190	248	275	310	370	425	475	525	590	1.45	2.00	183	238	220
	MALQD65UHR	6.5	1/4	RSIR	S	175	205	265	295	335	395	455	510	560	635	1.45	2.00	196	255	220
	MALQD75UHM	7.5	1/4+	CSIR	S/F	205	235	310	345	390	430	530	590	655	740	1.50	2.05	230	288	220
DQ	MAQQD91UHM	9.1	3/8	CSIR	F	240	285	365	410	470	550	630	695	765	870	1.45	2.00	273	348	250
	MAQQD110UHM	11.1	3/8+	CSIR	F	295	345	435	495	565	660	770	860	940	1050	1.45	2.00	330	430	250
	MAQQD120UHM	12.1	3/5	CSIR	F	325	385	480	550	630	730	855	955	1040	1160	1.50	2.00	366	478	250
	MAQQD142UHW	14.2	1/2	CSCR	F	380	450	560	645	740	855	1000	1120	1260	1360	1.50	2.00	430	560	250
	MAQQD158UHW	15.8	1/2+	CSCR	F	410	490	610	700	800	930	1090	1215	1320	1470	1.50	2.00	467	608	250

R290制冷压缩机技术参数

Technical Data of QD Series R290 Refrigeration Compressor ( 208-230V/60Hz )

机型 Style	型号 Model	气缸 容积 Displ. (Cm3)	商业标称 Power HP	电机类型 Motor Type	冷却方式 Cooling	制冷量 Capacity(W)54.4°C/ 130°F Condensing Temp.											能效比 COP W/W	输入功率 Input Power (W)	注油量 Oil Charge	
						-35°C	-30°C	-25°C	-23.3°C	-20°C	-15°C	-10°C	-6.7°C	-5°C	0°C					
																				-23.3°C
DF	*MBFQD30UHM	3.00	1/6	CSIR	F	90	108	142	158	180	210	245	270	300	335	1.24	1.7	127	159	180
	*MBFQD35UHM	3.50	1/5	CSIR	F	106	127	168	188	216	250	290	320	350	400	1.24	1.7	152	188	180
	MBFQD43UHM	4.30	1/4	CSIR	F	140	165	210	235	270	320	370	410	450	510	1.29	1.75	182	234	180
	MBFQD52UHM	5.20	1/4+	CSIR	F	155	185	240	265	305	360	410	460	510	580	1.29	1.75	205	263	180
DL	MBLQD59UHM	5.90	1/4+	CSIR	F	175	205	265	295	340	400	460	505	555	635	1.44	1.95	205	259	220
	MBLQD65UHM	6.50	1/3	CSIR	F	205	240	305	340	390	460	540	600	660	750	1.45	2.00	234	300	220
	MBLQD75UHM	7.60	1/3	CSIR	F	220	260	330												

# 低中高背压商用系列制冷压缩机

L/M/HBP Commercial Series Compressor

QD系列  
L/M/HBP  
R290

## R290制冷压缩机技术参数

Technical Data of QD Series R290 Refrigeration Compressor ( 220-240V/50Hz )

机型 Style	型号 Model	气缸 容积 Displ. (Cm3)	商业标称 Power HP	电机类型 Motor Type	冷却方式 Cooling	制冷量 Capacity(W)54.4℃/130°F Condensing Temp.																能效比 COP W/W			输入功率 Input Power (W)			注油量 Oil Charge
						-35	-30	-25	-23.3	-20	-15	-10	-6.7	-5	0	5	7.2	10	15	-23.3	-6.7	7.2	-23.3	-6.7	7.2			
						80	90	115	130	150	170	200	230	250	280	350	390	430	510	1.25	1.70	2.50	108	135	156	180		
DF	*TAFQD30UHM	3.0	1/8	CSIR	F	80	90	115	130	150	170	200	230	250	280	350	390	430	510	1.25	1.70	2.50	108	135	156	180		
	TAFQD35UHM	3.5	1/6	CSIR	F	90	105	135	150	170	195	225	270	300	350	410	460	505	600	1.25	1.70	2.50	115	159	184	180		
	TAFQD43UHM	4.3	1/5	CSIR	F	110	130	170	190	220	245	285	335	370	435	515	570	630	750	1.30	1.70	2.50	146	197	228	180		
	TAFQD52UHM	4.9	1/5	CSIR	F	130	150	200	220	250	285	330	370	405	480	630	700	770	900	1.30	1.70	2.50	169	218	280	180		
DL	TALQD59UHM	5.9	1/5+	CSIR	F	145	170	220	245	280	320	365	420	460	545	720	800	880	1050	1.45	1.80	2.60	163	233	308	220		
	TALQD65UHM	6.2	1/4	CSIR	F	160	190	245	270	310	350	405	470	515	610	810	900	990	1150	1.45	1.80	2.60	180	261	346	220		
	TALQD75UHM	7.2	1/4+	CSIR	F	170	200	260	290	335	375	435	520	570	675	900	1000	1100	1300	1.50	1.80	2.60	193	289	385	220		
DQ	TAQD91UHM	8.8	3/8	CSIR	F	220	260	335	370	405	480	555	635	670	820	1130	1250	1375	1630	1.30	1.70	2.50	285	374	500	250		
	TAQD110UHM	10.6	3/8+	CSIR	F	260	305	390	435	500	565	650	760	835	980	1300	1450	1600	1890	1.30	1.70	2.50	334	447	580	250		
	TAQD120UHM	11.6	5/8	CSIR	F	288	335	435	480	550	620	720	830	910	1080	1520	1700	1880	2210	1.30	1.70	2.50	369	488	680	250		

## R290制冷压缩机技术参数

Technical Data of QD Series R290 Refrigeration Compressor ( 208-230V/60Hz )

机型 Style	型号 Model	气缸 容积 Displ. (Cm3)	商业标称 Power HP	电机类型 Motor Type	冷却方式 Cooling	制冷量 Capacity(W)54.4℃/130°F Condensing Temp.																能效比 COP W/W			输入功率 Input Power (W)			注油量 Oil Charge
						-35	-30	-25	-23.3	-20	-15	-10	-6.7	-5	0	5	7.2	10	15	-23.3	-6.7	7.2	-23.3	-6.7	7.2			
						95	105	135	155	180	200	240	275	300	335	420	465	515	610	1.25	1.70	2.50	119	212	186	180		
DF	*TBFQD30UHM	3.0	1/6	CSIR	F	95	105	135	155	180	200	240	275	300	335	420	465	515	610	1.25	1.70	2.50	119	212	186	180		
	TBFQD35UHM	3.5	1/5	CSIR	F	105	125	160	180	205	230	270	320	360	420	490	550	606	720	1.25	1.70	2.50	138	188	220	180		
	TBFQD43UHM	4.3	1/4	CSIR	F	130	156	205	230	260	290	340	400	445	520	615	680	755	900	1.30	1.70	2.50	177	235	272	180		
	TBFQD52UHM	4.9	1/4+	CSIR	F	155	180	240	260	300	340	390	445	485	570	750	840	920	1080	1.30	1.70	2.50	200	262	336	180		
DL	TBLQD59UHM	5.9	1/4+	CSIR	F	175	205	265	295	340	400	460	505	555	635	860	960	1050	1260	1.45	1.80	2.60	197	281	369	220		
	TBLQD65UHM	6.2	1/3	CSIR	F	190	225	290	320	370	420	480	560	615	730	970	1080	1190	1380	1.45	1.80	2.60	213	311	415	220		
	TBLQD75UHM	7.2	1/3	CSIR	F	205	240	310	350	400	450	520	620	680	810	1080	1200	1320	1560	1.30	1.70	2.50	269	365	480	250		
DQ	TBQD91UHM	8.8	3/8	CSIR	F	265	310	400	440	485	575	666	760	800	980	1350	1500	1650	1950	1.30	1.70	2.50	338	447	600	250		
	TBQD110UHM	10.6	1/2	CSIR	F	310	366	470	520	600	675	780	910	1000	1175	1560	1740	1920	2000	1.30	1.70	2.50	400	535	696	250		
	*TBQD120UHW	11.6	1/2+	CSCR	F	345	400	520	575	660	745	860	1000	1090	1300	1820	2040	2255	2650	1.30	1.70	2.50	442	588	816	250		

## R290制冷压缩机技术参数

Technical Data of QD Series R290a Refrigeration Compressor ( 115-127V/60Hz )

机型 Style	型号 Model	气缸 容积 Displ. (Cm3)	商业标称 Power HP	电机类型 Motor Type	冷却方式 Cooling	制冷量 Capacity(W)54.4℃/130°F Condensing Temp.																能效比 COP W/W			输入功率 Input Power (W)			注油量 Oil Charge
						-35	-30	-25	-23.3	-20	-15	-10	-6.7	-5	0	5	7.2	10	15	-23.3	-6.7	7.2	-23.3	-6.7	7.2			
						95	105	135	155	180	200	240	275	300	335	420	465	515	610 <td>1.25</td> <td>1.70</td> <td>2.50</td> <td>119</td> <td>212</td> <td>186</td> <td>180</td>	1.25	1.70	2.50	119	212	186	180		
DF	*TDFQD30UHM	3.0	1/6	CSIR	F	95	105	135	155	180	200	240	275	300	335	420	465	515	610	1.25	1.70	2.50	119	212	186	180		
	TDFQD35UHM	3.5	1/5	CSIR	F	105	125	160	180	205	230	270	320	360	420	490	550	606	720	1.25	1.70	2.50	138	188	220	180		
	TDFQD43UHM	4.3	1/4	CSIR	F	130	156	205	230	260	290	340	400	445	520	615	680	755	900	1.3	1.70	2.50	177	235	272	180		
	TDFQD52UHM	4.9	1/4+	CSIR	F	155	180	240	260	300	340	390	445	485	570	750	840	920	1080	1.30	1.70	2.50	200	262	336	180		
DL	TDLQD59UHM	5.9	1/4+	CSIR	F	175	205	265	295	340	400	460	505	555	635	860	960	1050	1260	1.45	1.80	2.60	197	281	369	220		
	TDLQD65UHM	6.2	1/3	CSIR	F	190	225	290	320	370	420	480	560	615	730	970	1080	1190	1380	1.45	1.80	2.60	213	311	415	220		
	TDLQD75UHM	7.2	1/3	CSIR	F	205	240	310	350	400	450	520	620	680	810	1080	1200	1320	1560	1.30	1.70	2.50	269	365	480	250		
DQ	TDQD91UHM	8.8	3/8	CSIR	F	265	310	400	440	485	575	666	760	800	980	1350	1500	1650	1950	1.30	1.70	2.50	338	447	600	250		
	*TDQD110UHW	10.6	1/2	CSCR	F	310	366	470	520	600	675	780	910	1000	1175	1560	1740	1920	2000	1.30	1.70	2.50	400	535	696	250		
	*TDQD120UHW	11.6	1/2+	CSCR	F	345	400	520	575	660	745	860	1000	1090	1300	1820	2040	2255	2650	1.30	1.70	2.50	442	588	816	250		

以上规格参数满足LST启动方式，如需HST，请联系本公司订制。  
The above specifications are for LST starting torque, if you need HST, contact with us please.

# 低背压商用系列制冷压缩机

LBP Commercial Series Compressor

QD系列  
LBP  
R290

## R290制冷压缩机技术参数

Technical Data of QD Series R290 Refrigeration Compressor ( 220-240V/50Hz )

机型 Style	型号 Model	气缸 容积 Displ. (Cm3)	商业标称 Power HP	电机类型 Motor Type	冷却方式 Cooling	制冷量 Capacity(W)54.4℃/130°F Condensing Temp.						能效比 COP W/W	输入功率 Input Power (W)	注油量 Oil Charge
						-35	-30	-25	-23.3	-20	-15			
						105	95	120	135	155	180 <td>1.30</td> <td>104</td> <td>180</td>			
DF	*LAFQD30UHP	3.0	1/8	RSIR	S	105	95	120	135	155	180	1.30	104	180
	LAFQD35UHP	3.5	1/6	RSIR	S	96	110	145	160	185	215	1.30	123	180
	LAFQD43UHP	4.3	1/5	RSIR	S	120	140	180	200	230	270	1.32	151	180
	LAFQD52UHP	5.2	1/5	RSIR	S	135	160	205	230	265	310	1.32	174	180
DL	LALQD59UHR	5.9	1/5+	RSIR	S	158	190	248	275	310	370	1.50	183	220
	LALQD65UHR	6.5	1/4	RSIR	S	175	205	265	295	335	395	1.50	196	220
	LALQD75UHM	7.5	1/4+	CSIR	S/F	205	235	310	345	390	430	1.52	227	220
DQ	LAQD91UHM	9.1	3/8	CSIR	F	240	285	365	410	470	550	1.50	273	250
	LAQD110UHM	11.1	3/8+	CSIR	F	295	345	435	495	565	660	1.50	330	250
	LAQD120UHM	12.1	3/5	CSIR	F	325	385	480	550	630	730	1.50	366	250

## R290制冷压缩机技术参数

Technical Data of QD Series R290 Refrigeration Compressor ( 208-230V/60Hz )

机型 Style	型号 Model	气缸 容积 Displ. (Cm3)	商业标称 Power HP	电机类型 Motor Type	冷却方式 Cooling	制冷量 Capacity(W)54.4℃/130°F Condensing Temp.						能效比 COP W/W	输入功率 Input Power (W)	注油量 Oil Charge
						-35	-30	-25	-23.3	-20	-15			
						90	108	142	158	180	210 <td>1.30</td> <td>122</td> <td>180</td>			
DF	*LBFQD30UHM	3.0	1/6	CSIR	F	90	108	142	158	180	210	1.30	122	180
	*LBFQD35UHM	3.5	1/5	CSIR	F	106	127	168	188	216	250	1.30	145	180
	LBFQD43UHM	4.3	1/4	CSIR	F	140	165	210	235	270	320	1.32	178	180
	LBFQD52UHM	5.2	1/4+	CSIR	F	155	185	240	265	305	360	1.32	200	180
DL	LBLQD59UHM	5.9	1/4+	CSIR	F	175	205	265	295	340	400	1.50	196	220
	LBLQD65UHM	6.5	1/3	CSIR	F	205	240	305						

## 低中背压商用系列制冷压缩机

L/MBP Commercial Series Compressor

### R404A制冷压缩机技术参数

Technical Data of  
QD Series R404A Refrigeration Compressor ( 220V-240V/50Hz )

QD系列  
L/MBP  
R404A

机型 Style	型号 Model	气缸 容积 Displ. (Cm3)	商业标称 Power HP	电机类型 Motor Type	冷却方式 Cooling	制冷量 Capacity(W)54.4℃/130°F Condensing Temp.										能效比 COP W/W		输入功率 Input Power (W)		注油量 Oil Charge
						-35	-30	-25	-23.3	-20	-15	-10	-6.7	-5	0	-23.3	-6.7	-23.3	-6.7	
						℃	℃	℃	℃	℃	℃	℃	℃	℃	℃	℃	℃	℃	℃	
DM	MAMQD30KHM	3.0	1/8	CSIR	F	96	107	147	162	193	243	300	324	356	389	1.25	1.75	130	93	160
	MAMQD35KHM	3.5	1/6	CSIR	F	112	125	172	189	225	284	350	378	416	454	1.25	1.75	151	108	160
DF	MAFQD43KHM	4.3	1/5	CSIR	F	134	150	207	228	271	342	422	456	501	547	1.30	1.80	175	127	180
	MAFQD52KHM	4.9	1/5	CSIR	F	153	171	236	260	309	390	480	519	571	623	1.30	1.80	200	144	180
DL	MALQD59KHM	5.5	1/5+	CSIR	F	178	200	275	303	360	454	560	605	666	726	1.35	2.00	224	151	220
	MALQD65KHM	6.2	1/4	CSIR	F	201	225	310	341	406	512	631	682	750	818	1.45	2.00	235	171	220
	MALQD75KHM	7.2	1/4+	CSIR	F	234	261	360	396	471	594	733	792	871	950	1.50	2.05	264	193	220
DQ	MAQQD91KHM	8.8	3/8	CSIR	F	275	308	424	466	555	700	863	933	1026	1119	1.45	2.00	322	233	250
	MAQQD110KHM	10.6	3/8+	CSIR	F	331	371	511	562	669	843	1039	1124	1236	1348	1.45	2.00	387	281	250
DT	MATQD128KHM	12.12	9/16	CSIR	F	363	407	561	616	733	924	1140	1232	1355	1478	1.24	1.70	497	362	450
	MATQD158KHM	14.5	5/8	CSIR	F	346	387	533	586	697	879	1084	1172	1289	1406	1.28	1.72	458	341	450
	MATQD168KHM	16.8	3/4	CSIR	F	496	554	764	840	1000	1260	1554	1680	1848	2016	1.26	1.72	667	488	450
	MATQD180KHM	17.4	3/4	CSIR	F	466	521	718	789	939	1184	1460	1578	1736	1894	1.15	1.60	686	493	450
	MATQD210KHM	20.4	3/4	CSIR	F	537	601	828	910	1083	1365	1684	1820	2002	2184	1.34	1.80	679	506	450

### R404a制冷压缩机技术参数

Technical Data of  
QD Series R404A Refrigeration Compressor ( 208V-230V/60Hz )

机型 Style	型号 Model	气缸 容积 Displ. (Cm3)	商业标称 Power HP	电机类型 Motor Type	冷却方式 Cooling	制冷量 Capacity(W)54.4℃/130°F Condensing Temp.										能效比 COP W/W		输入功率 Input Power (W)		注油量 Oil Charge
						-35	-30	-25	-23.3	-20	-15	-10	-6.7	-5	0	-23.3	-6.7	-23.3	-6.7	
						℃	℃	℃	℃	℃	℃	℃	℃	℃	℃	℃	℃	℃	℃	
DM	MBMQD30KHM	3.0	1/8+	CSIR	F	104	117	161	177	211	266	327	354	389	425	1.24	1.70	143	208	160
	MBMQD35KHM	3.5	1/6+	CSIR	F	122	136	188	207	246	310	382	413	454	496	1.24	1.70	167	243	160
DF	MBFQD43KHM	4.3	1/5+	CSIR	F	150	167	231	254	302	381	469	507	558	609	1.29	1.75	197	290	180
	MBFQD52KHM	4.9	1/5+	CSIR	F	171	191	263	289	344	434	535	578	636	694	1.29	1.75	224	330	180
DL	MBLQD59KHM	5.5	1/5+	CSIR	F	191	214	295	325	386	487	600	649	714	779	1.44	1.95	225	333	220
	MBLQD65KHM	6.2	1/4+	CSIR	F	216	241	333	366	435	549	677	732	805	878	1.45	2.00	252	366	220
	MBLQD75KHM	7.2	1/4+	CSIR	F	251	280	387	425	506	637	786	850	935	1020	1.50	2.05	283	414	220
DQ	MBQQD91KHM	8.8	3/8+	CSIR	F	306	343	472	519	618	779	961	1038	1142	1246	1.45	2.00	358	519	250
	MBQQD110KHM	10.6	3/8+	CSIR	F	369	413	569	625	744	938	1157	1251	1376	1501	1.45	2.00	431	625	250
DT	MBTQD128KHM	12.12	9/16+	CSIR	F	400	447	617	678	807	1017	1254	1356	1492	1627	1.36	1.90	499	714	450
	MBTQD158KHM	14.5	3/4	CSIR	F	381	426	587	645	768	968	1193	1290	1419	1548	1.41	1.95	457	662	450
	MBTQD168KHM	16.8	3/4+	CSIR	F	545	610	841	924	1100	1386	1709	1848	2033	2218	1.26	1.90	665	973	450
	MBTQD180KHM	17.4	3/4+	CSIR	F	535	599	825	907	1079	1361	1678	1814	1995	2177	1.26	1.80	720	1008	450
	MBTQD210KHM	20.4	3/4+	CSIR	F	591	661	911	1001	1191	1502	1852	2002	2202	2402	1.47	2.00	681	1001	450

### R404a制冷压缩机技术参数

Technical Data of  
QD Series R404A Refrigeration Compressor ( 115V-127V/60Hz )

机型 Style	型号 Model	气缸 容积 Displ. (Cm3)	商业标称 Power HP	电机类型 Motor Type	冷却方式 Cooling	制冷量 Capacity(W)54.4℃/130°F Condensing Temp.										能效比 COP W/W		输入功率 Input Power (W)		注油量 Oil Charge
						-35	-30	-25	-23.3	-20	-15	-10	-6.7	-5	0	-23.3	-6.7	-23.3	-6.7	
						℃	℃	℃	℃	℃	℃	℃	℃	℃	℃	℃	℃	℃	℃	
DM	MDMQD30KHM	3.0	1/8+	CSIR	F	105	118	162	179	212	268	330	357	393	428	1.25	1.75	143	204	160
	MDMQD35KHM	3.5	1/6+	CSIR	F	123	137	190	208	248	312	385	417	458	500	1.25	1.75	167	238	160
DF	MDFQD43KHM	4.3	1/5+	CSIR	F	151	169	233	256	304	384	473	512	563	614	1.30	1.80	197	284	180
	MDFQD52KHM	4.9	1/5+	CSIR	F	172	192	265	292	347	437	539	583	641	700	1.30	1.80	224	324	180
DL	MDLQD59KHM	5.5	1/5+	CSIR	F	193	216	298	327	389	491	605	655	720	785	1.45	2.00	226	327	220
	MDLQD65KHM	6.2	1/4+	CSIR	F	218	243	336	369	439	553	682	738	812	885	1.45	2.00	254	369	220
	MDLQD75KHM	7.2	1/4+	CSIR	F	253	283	390	428	510	643	793	857	942	1028	1.50	2.05	286	418	220
DQ	MDQQD91KHM	8.8	3/8+	CSIR	F	309	346	476	524	623	785	969	1047	1152	1257	1.45	2.00	361	524	250
	MDQQD110KHM	10.6	3/8+	CSIR	F	372	416	574	631	751	946	1167	1261	1388	1514	1.45	2.00	435	631	250
DT	MDTQD128KHM	12.12	9/16+	CSIR	F	400	447	617	678	807	1017	1254	1356	1492	1627	1.36	1.90	499	714	450
	MDTQD158KHM	14.5	3/4	CSIR	F	381	426	587	645	768	968	1193	1290	1419	1548	1.41	1.95	457	662	450
	MDTQD168KHM	16.8	3/4+	CSIR	F	545	610	841	924	1100	1386	1709	1848	2033	2218	1.39	1.90	665	973	450
	MDTQD180KHM	17.4	3/4+	CSIR	F	535	599	825	907	1079	1361	1678	1814	1995	2177	1.26	1.80	720	1008	450
	MDTQD210KHM	20.4	3/4+	CSIR	F	591	661	911	1001	1191	1502	1852	2002	2202	2402	1.47	2.00	681	1001	450

以上规格参数满足LST启动方式, 如需HST, 请联系本公司订制。  
The above specifications are for LST starting torque, if you need HST, contact with us please.

## 中高背压商用系列制冷压缩机

M/HBP Commercial Series Compressor

### R404A制冷压缩机技术参数

Technical Data of  
QD Series R404A Refrigeration Compressor ( 220V-240V/50Hz )

QD系列  
M/HBP  
R404A

机型 Style	型号 Model	气缸 容积 Displ. (Cm3)	商业标称 Power HP	电机类型 Motor Type	冷却方式 Cooling	制冷量 Capacity(W)54.4℃/130°F Condensing Temp.										能效比 COP W/W		输入功率 Input Power (W)		注油量 Oil Charge
						-20	-15	-10	-6.7	-5	0	5	7.2	10	15	-6.7	7.2	-6.7	7.2	
						℃	℃	℃	℃	℃	℃	℃	℃	℃	℃	℃	℃	℃	℃	
DM	HAMQD30KHM	3.0	1/8	CSIR	F	203	226	236	273	292	358	433	471	518	612	1.90	2.20	144	214	160
	HAMQD35KHM	3.5	1/6	CSIR	F	236	264	275	319	341	418	506	550	604	714	1.95	2.25	163	244	160
DF	HAFQD43KHM	4.3	1/5	CSIR	F	290	324	338	392	419	513	621	675	743	878	1.95	2.25	201	300	180
	HAFQD52KHM	4.9	1/5	CSIR	F	331	369	385	446	477	585	708	769	846	1000	1.95	2.25	229	342	180
DL	HALQD59KHM	5.5	1/5+	CSIR	F	371	414	432	501	535	656	794	864	950	1123	2.00	2.30	250	375	220
	HALQD65KHM	6.2	1/4	CSIR	F	419	467	487	565	604	740	896	973	1071	1265	2.00	2.30	282	423	220
	HALQD75KHM	7.2	1/4+	CSIR	F	486	543	565	656	701	859	1040	1130	1243	1470	2.00	2.30	328	491	220
DQ	HAQQD91KHM	8.8	3/8	CSIR	F	594	663	691	801	857	1050	1271	1382	1520	1796	1.90	2.20	422	628	250
	HAQQD110KHM	10.6	3/8+	CSIR	F	716	799	832	965	1032	1265	1531	1664	1831	2163	1.90	2.20	508	756	250
DT	HATQD128KHM	12.12	9/16	CSIR	F	745	831	866	1005	1074	1316	1593	1732	1905	2252	1.95	2.26	515	766	450
	HATQD158KHM	14.5	5/8	CSIR	F	914	1020	1063	1233	1318	1616	1956	2126	2339	2764	1.90	2.20	649	966	450
	HATQD180KHM	17.4	3/4	CSIR	F	1032	1152	1200	1392	1488	1824	2208	2400	2640	3120	1.90	2.17	733	1106	450
	HATQD210KHM	20.4	3/4	CSIR	F	1245	1390	1448	1679	1795	2200	2663	2895	3185	3764	1.90	2.20	884	1316	450

### R404a制冷压缩机

# 低中背压商用系列制冷压缩机

L/MBP Commercial Series Compressor

QD系列  
L/MBP  
R22

## R22制冷压缩机技术参数

Technical Data of QD Series R22 Refrigeration Compressor (220V-240V/50Hz)

机种 Style	型号 Model	气缸 容积 Displ. (cm <sup>3</sup> )	商业压缩 Power HP	电机类型 Motor Type	冷却方式 Cooling	制冷量 Capacity(W)/64°C/130°F Condensing Temp.														能效比 COP WW		输入功率 Input Power (W)		注油 Oil Charge																																																																																																																																																																																																																																																																																																																																																																																																																																																																																																																																																																																																																																																																																																																																																																																																																																																																																																																																																																																																																																																																																																																																																																																																																																																																																																																																																																
						20	25	30	35	40	45	50	55	60	65	70	75	80	85	90	95	100	105		110	115	120	125	130	135	140	145	150	155	160	165	170	175	180	185	190	195	200	205	210	215	220	225	230	235	240	245	250	255	260	265	270	275	280	285	290	295	300	305	310	315	320	325	330	335	340	345	350	355	360	365	370	375	380	385	390	395	400	405	410	415	420	425	430	435	440	445	450	455	460	465	470	475	480	485	490	495	500	505	510	515	520	525	530	535	540	545	550	555	560	565	570	575	580	585	590	595	600	605	610	615	620	625	630	635	640	645	650	655	660	665	670	675	680	685	690	695	700	705	710	715	720	725	730	735	740	745	750	755	760	765	770	775	780	785	790	795	800	805	810	815	820	825	830	835	840	845	850	855	860	865	870	875	880	885	890	895	900	905	910	915	920	925	930	935	940	945	950	955	960	965	970	975	980	985	990	995	1000	1005	1010	1015	1020	1025	1030	1035	1040	1045	1050	1055	1060	1065	1070	1075	1080	1085	1090	1095	1100	1105	1110	1115	1120	1125	1130	1135	1140	1145	1150	1155	1160	1165	1170	1175	1180	1185	1190	1195	1200	1205	1210	1215	1220	1225	1230	1235	1240	1245	1250	1255	1260	1265	1270	1275	1280	1285	1290	1295	1300	1305	1310	1315	1320	1325	1330	1335	1340	1345	1350	1355	1360	1365	1370	1375	1380	1385	1390	1395	1400	1405	1410	1415	1420	1425	1430	1435	1440	1445	1450	1455	1460	1465	1470	1475	1480	1485	1490	1495	1500	1505	1510	1515	1520	1525	1530	1535	1540	1545	1550	1555	1560	1565	1570	1575	1580	1585	1590	1595	1600	1605	1610	1615	1620	1625	1630	1635	1640	1645	1650	1655	1660	1665	1670	1675	1680	1685	1690	1695	1700	1705	1710	1715	1720	1725	1730	1735	1740	1745	1750	1755	1760	1765	1770	1775	1780	1785	1790	1795	1800	1805	1810	1815	1820	1825	1830	1835	1840	1845	1850	1855	1860	1865	1870	1875	1880	1885	1890	1895	1900	1905	1910	1915	1920	1925	1930	1935	1940	1945	1950	1955	1960	1965	1970	1975	1980	1985	1990	1995	2000	2005	2010	2015	2020	2025	2030	2035	2040	2045	2050	2055	2060	2065	2070	2075	2080	2085	2090	2095	2100	2105	2110	2115	2120	2125	2130	2135	2140	2145	2150	2155	2160	2165	2170	2175	2180	2185	2190	2195	2200	2205	2210	2215	2220	2225	2230	2235	2240	2245	2250	2255	2260	2265	2270	2275	2280	2285	2290	2295	2300	2305	2310	2315	2320	2325	2330	2335	2340	2345	2350	2355	2360	2365	2370	2375	2380	2385	2390	2395	2400	2405	2410	2415	2420	2425	2430	2435	2440	2445	2450	2455	2460	2465	2470	2475	2480	2485	2490	2495	2500	2505	2510	2515	2520	2525	2530	2535	2540	2545	2550	2555	2560	2565	2570	2575	2580	2585	2590	2595	2600	2605	2610	2615	2620	2625	2630	2635	2640	2645	2650	2655	2660	2665	2670	2675	2680	2685	2690	2695	2700	2705	2710	2715	2720	2725	2730	2735	2740	2745	2750	2755	2760	2765	2770	2775	2780	2785	2790	2795	2800	2805	2810	2815	2820	2825	2830	2835	2840	2845	2850	2855	2860	2865	2870	2875	2880	2885	2890	2895	2900	2905	2910	2915	2920	2925	2930	2935	2940	2945	2950	2955	2960	2965	2970	2975	2980	2985	2990	2995	3000	3005	3010	3015	3020	3025	3030	3035	3040	3045	3050	3055	3060	3065	3070	3075	3080	3085	3090	3095	3100	3105	3110	3115	3120	3125	3130	3135	3140	3145	3150	3155	3160	3165	3170	3175	3180	3185	3190	3195	3200	3205	3210	3215	3220	3225	3230	3235	3240	3245	3250	3255	3260	3265	3270	3275	3280	3285	3290	3295	3300	3305	3310	3315	3320	3325	3330	3335	3340	3345	3350	3355	3360	3365	3370	3375	3380	3385	3390	3395	3400	3405	3410	3415	3420	3425	3430	3435	3440	3445	3450	3455	3460	3465	3470	3475	3480	3485	3490	3495	3500	3505	3510	3515	3520	3525	3530	3535	3540	3545	3550	3555	3560	3565	3570	3575	3580	3585	3590	3595	3600	3605	3610	3615	3620	3625	3630	3635	3640	3645	3650	3655	3660	3665	3670	3675	3680	3685	3690	3695	3700	3705	3710	3715	3720	3725	3730	3735	3740	3745	3750	3755	3760	3765	3770	3775	3780	3785	3790	3795	3800	3805	3810	3815	3820	3825	3830	3835	3840	3845	3850	3855	3860	3865	3870	3875	3880	3885	3890	3895	3900	3905	3910	3915	3920	3925	3930	3935	3940	3945	3950	3955	3960	3965	3970	3975	3980	3985	3990	3995	4000	4005	4010	4015	4020	4025	4030	4035	4040	4045	4050	4055	4060	4065	4070	4075	4080	4085	4090	4095	4100	4105	4110	4115	4120	4125	4130	4135	4140	4145	4150	4155	4160	4165	4170	4175	4180	4185	4190	4195	4200	4205	4210	4215	4220	4225	4230	4235	4240	4245	4250	4255	4260	4265	4270	4275	4280	4285	4290	4295	4300	4305	4310	4315	4320	4325	4330	4335	4340	4345	4350	4355	4360	4365	4370	4375	4380	4385	4390	4395	4400	4405	4410	4415	4420	4425	4430	4435	4440	4445	4450	4455	4460	4465	4470	4475	4480	4485	4490	4495	4500	4505	4510	4515	4520	4525	4530	4535	4540	4545	4550	4555	4560	4565	4570	4575	4580	4585	4590	4595	4600	4605	4610	4615	4620	4625	4630	4635	4640	4645	4650	4655	4660	4665	4670	4675	4680	4685	4690	4695	4700	4705	4710	4715	4720	4725	4730	4735	4740	4745	4750	4755	4760	4765	4770	4775	4780	4785	4790	4795	4800	4805	4810	4815	4820	4825	4830	4835	4840	4845	4850	4855	4860	4865	4870	4875	4880	4885	4890	4895	4900	4905	4910	4915	4920	4925	4930	4935	4940	4945	4950	4955	4960	4965	4970	4975	4980	4985	4990	4995	5000	5005	5010	5015	5020	5025	5030	5035	5040	5045	5050	5055	5060	5065	5070	5075	5080	5085	5090	5095	5100	5105	5110	5115	5120	5125	5130	5135	5140	5145	5150	5155	5160	5165	5170	5175	5180	5185	5190	5195	5200	5205	5210	5215	5220	5225	5230	5235	5240	5245	5250	5255	5260	5265	5270	5275	5280	5285	5290	5295	5300	5305	5310	5315	5320	5325	5330	5335	5340	5345	5350	5355	5360	5365	5370	5375	5380	5385	5390	5395	5400	5405	5410	5415	5420	5425	5430	5435	5440	5445	5450	5455	5460	5465	5470	5475	5480	5485	5490	5495	5500	5505	5510	5515	5520	5525	5530	5535	5540	5545	5550	5555	5560	5565	5570	5575	5580	5585	5590	5595	5600	5605	5610	5615	5620	5625	5630	5635	5640	5645	5650	5655	5660	5665	5670	5675	5680	5685	5690	5695	5700	5705	5710	5715	5720	5725	5730	5735	5740	5745	5750	5755	5760	5765	5770	5775	5780	5785	5790	5795	5800	5805	5810	5815	5820	5825	5830	5835	5840	5845	5850	5855	5860	5865	5870	5875	5880	5885	5890	5895	5900	5905	5910	5915	5920	5925	5930	5935	5940	5945	5950	5955	5960	5965	5970	5975	5980	5985	5990	5995	6000	6005	6010	6015	6020	6025	6030	6035	6040	6045	6050	6055	6060	6065	6070	6075	6080	6085	6090	6095	6100	6105	6110	6115	6120	6125	6130	6135	6140	6145	6150	6155	6160	6165	6170	6175	6180	6185	6190	6195	6200	6205	6210	6215	6220	6225	6230	6235	6240	6245	6250	6255	6260	6265	6270	6275	6280	6285	6290	6295	6300	6305	6310	6315	6320	6325	6330	6335	6340	6345	6350	6355	6360	6365	6370	6375	6380	6385	6390	6395	6400	6405	6410	6415	6420	6425	6430	6435	6440	6445	6450	6455	6460	6465	6470	6475	6480	6485	6490	6495	6500	6505	6510	6515	6520	6525	6530	6535	6540	6545	6550	6555	6560	6565	6570	6575	6580	6585	6590	6595	6600	6605	6610	6615	6620	6625	6630	6635	6640	6645	6650	6655	6660	6665

### RSIR(PTC)



### RSIR(CURRENT)

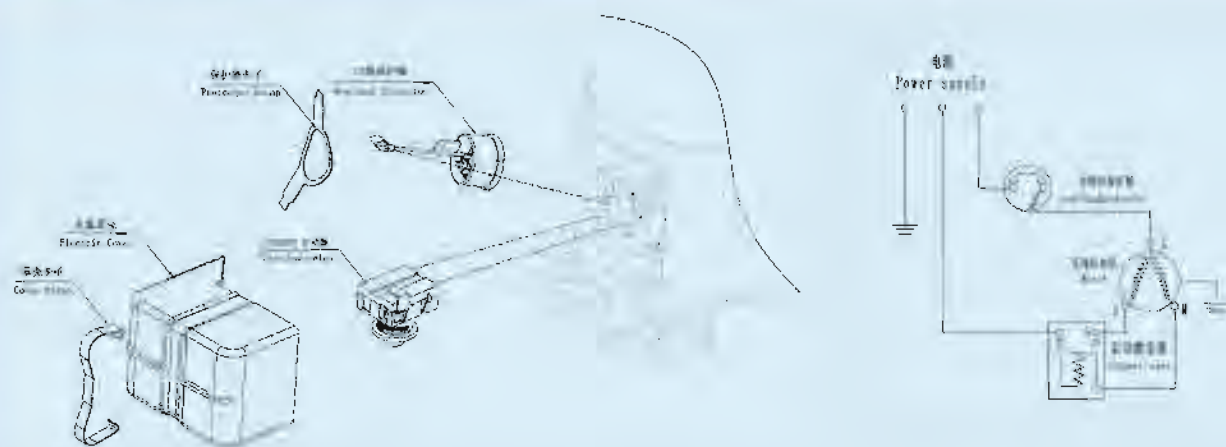

### RSIR(CURRENT)

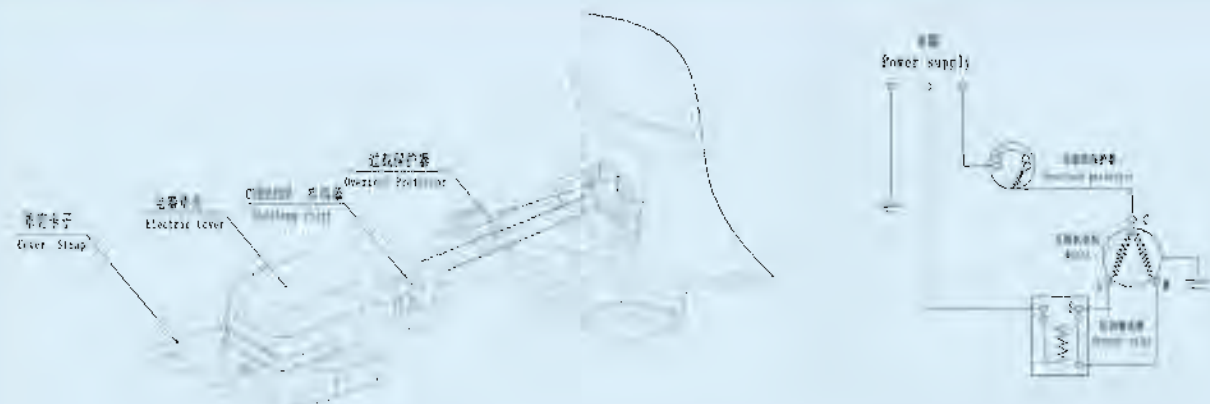

## 压缩机外形尺寸 Compressor Dimensions

### 图01-DW机型 DW Series

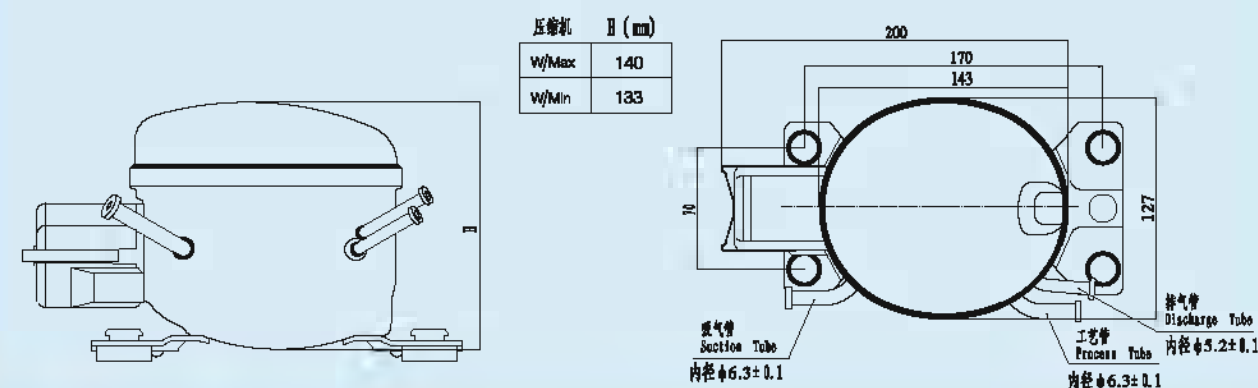

### 图02-DM机型 DM Style

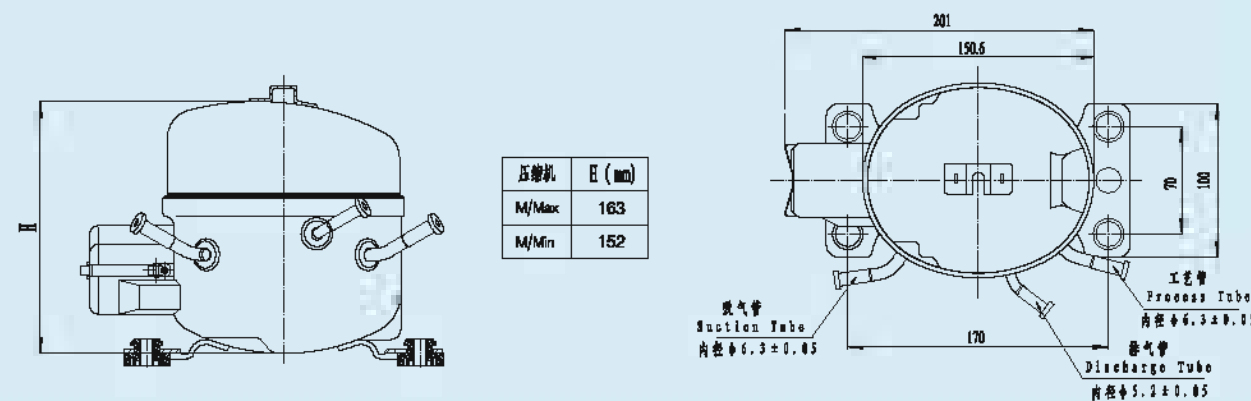

### 图03-DF机型 DF Style





图04-DL机型 DL Style



压缩机	H (mm)
L/Max	187
L/Min	186

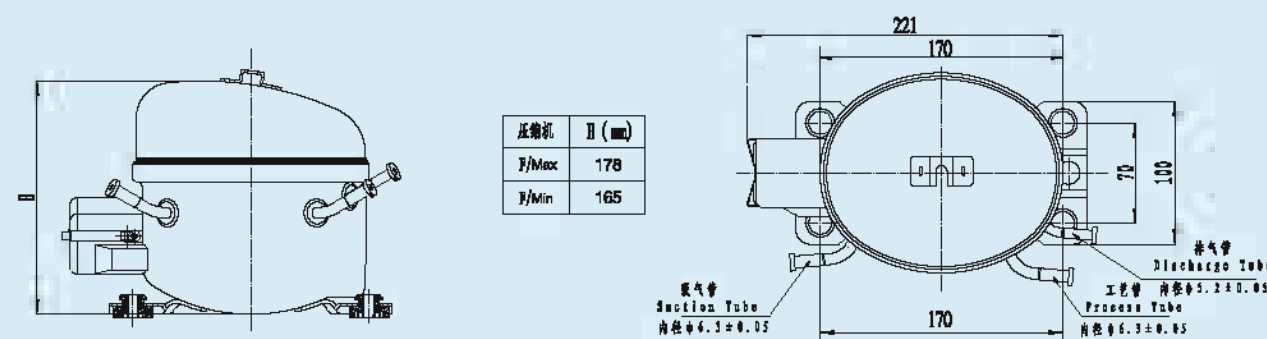
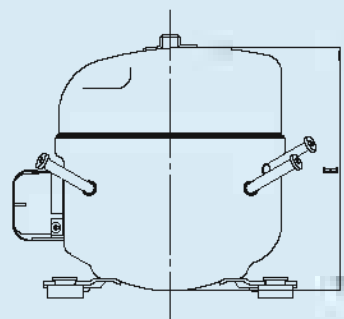

图05-DQ机型 DQ Style



压缩机	H (mm)
Q/Max	198
Q/Min	190

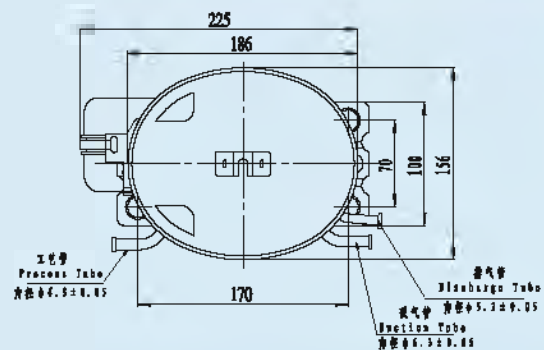
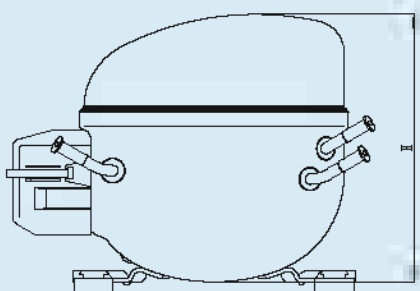

图06-FN机型 FN Style



压缩机	H (mm)
FL/Max	214

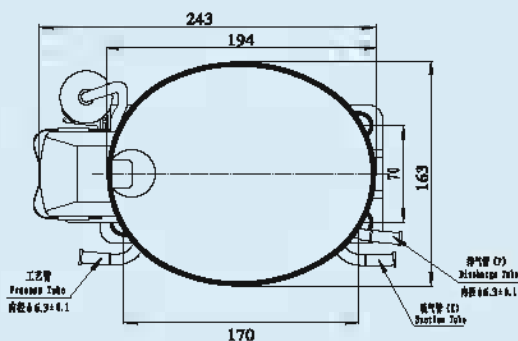
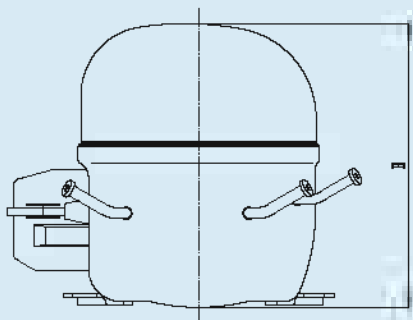
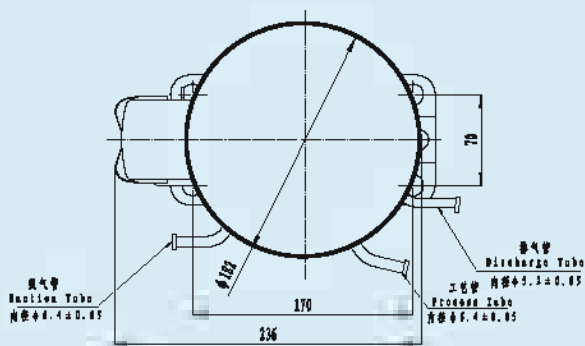

## 直流压缩机

DV compressor

DV系列  
L/MBP  
R134a

R134a直流压缩机技术参数  
Technical Data of  
DV series R134a Compressor(12/24V)

系列 Series	型号 Model	冷却方式 Cooling Type	工作容积 Displacement (cm <sup>3</sup> )	转速 Rotary Speed (rpm)	制冷量 Capacity -23.2°C(ASHRAE)			能效比 Efficiency		润滑油 Oil charge (g)	电压 Power Supply
					W	KGalH	BTUH	COP	EER		
DV	LZWDV25HHK	F	2.5	2000	44.5	38.5	151.7	1.08	3.7	160	12-24V(DV)
				2500	54.5	46.9	185.8	1.05	3.6		
				3000	63.5	54.6	216.5	1.06	3.6		
				3500	73.3	63.0	250.0	1.04	3.5		
	LZWDV30HHK		2000	52.6	45.2	179.4	1.04	3.5			
			2500	64.8	55.7	221.0	1.06	3.6			
			3000	76	65.4	259.2	1.06	3.6			
	LZWDV35HHK		3500	88	75.7	300.1	1.04	3.5			
			2000	61.2	52.6	208.7	1.08	3.7			
2500		73.4	63.1	250.3	1.06	3.6					
			3000	87.6	75.3	298.7	1.06	3.6			
			3500	102.3	88.0	348.8	1.05	3.6			

DV机型 DV Style

压缩机	H (mm)
ZW/Max	140
ZW/Min	133

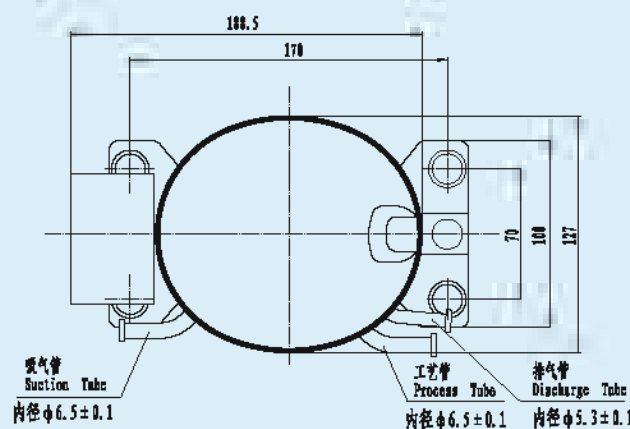
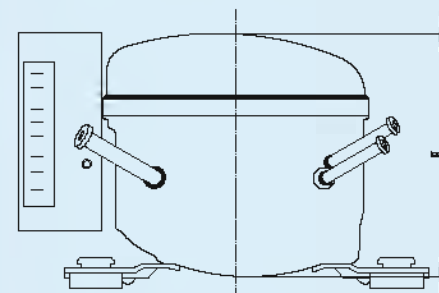

# 直流压缩机安装说明

## DV Compressor Instruction

### 控制器接线图

### Electronic Unit Wiring Diagram

图1

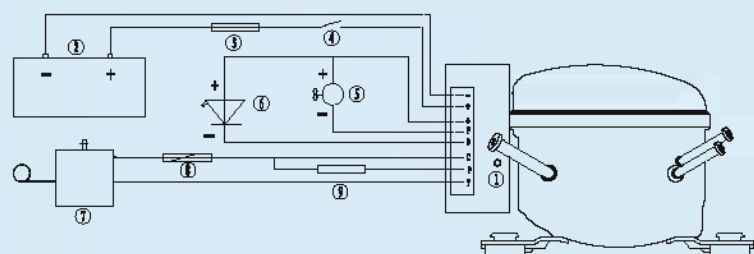

- ① 螺丝钉 Screw
- ② 电池 Battery
- ③ 保险丝 Fuse
- ④ 主开关 Main Switch
- ⑤ 风扇 DV Fan
- ⑥ LED灯 LED
- ⑦ 温控 Thermostat
- ⑧ 调速电阻 Resistor for presetting speed
- ⑨ 电池保护电阻 Resistor for presetting battery protection voltage

### 控制器使用说明

- 1、此控制器能自动适应双电压即直流12V和24V电源输入系统，直流12V系统时最大输入电压为17V，24V系统时最大输入电压为31.5V。控制器工作环境温度不大于60℃；当控制器外壳温度过高时将停止压缩机而产生温度过高保护。
- 2、安装方式：如图1所示，将控制器三相输出插件紧插在压缩机的连接线上，控制器套入压缩机的装卡片后拧紧螺钉①。
- 3、电源连接：如图1所示。
  - a、控制器的电源输入线直接连接至电池的正负极②，控制器的(-)极连至电池的负极；控制器的(+)极连至电池的正极，否则控制器将不能正常工作，控制器具有电源反接保护。
  - b、为了保护装置，必须在正电源连线中接入一个保险丝③，并尽可能靠近电池的正输出极，LZWQD25HHOZ，LZWQD30HHOZ和LZWQD35HHOZ压缩机推荐12V系统采用15A，24V系统采用7.5A。
  - c、如果加入主开关④，则LZWQD25HHOZ，LZWQD30HHOZ和LZWQD35HHOZ压缩机开关的最小通断电流值大于20A。
  - d、电源线的选择（线径及长度）可参照表2，否则会因电源连线上的电压降影响到控制器的电池保护点的设置值。
- 4、电池的保护：如图1所示
  - a、控制通过检测输入极(+)和(-)之间的电压值来确定停止压缩机及重启压缩机，用于保护不同的供电电池。
  - b、标准电池的保护设备推荐值见表3；其他电压的设定可通过调节控制器的端子(C)和(F)的连接电阻⑨，具体数值参照表1。
- 5、温度开关：如图1所示。
  - a、温度开关⑦连接在控制器的C、T端，如果中间不连接任何电阻，则当温度开关闭合时压缩机的运行速度为2000rpm。
  - b、其他压缩机的设定转速可通过电阻⑧来调节电流(mA)来获得，具体电阻数值参照表4。
- 6、外接风扇：如图1所示。
  - a、控制器的端子(+)和(F)之间可接入一个12V的直流风扇⑤，风扇的正极连接控制器的(+)端，负极连接控制器的(F)端。当控制器的输入电压超过12V时，端子(+)和(F)之间输出的值总是保持12V。不管输入电压系统是12V还是24V，风扇必须是12V的直流风扇。
  - b、控制器可持续输出0.5A的风扇驱动能力。
- 7、外接LED显示：如图1所示。
  - A、控制器的端子(+)和(D)之间可接入一个10mA的LED⑥用于显示故障，LED的阳极连接控制器的(+)端，阴极连接控制器的(D)端。
  - b、当发生故障时，LED每3秒循环，在每个循环中连续闪烁，根据不同的故障闪烁不同的次数，每次闪烁为0.2秒，持续增值3分钟，具体代码和闪烁次数见表5。

### Electronic Unit Specification

1. The electronic unit is a dual voltage device. This means that the same unit can be used in both 12V and 24V power supply systems, maximum voltage is 17V for a 12V system and 31.5V for a 24V system. Maximum ambient temperature is 60°C. The electronic unit has a built-in thermal protection which is actuated and stops compressor operation if the electronic unit temperature gets too high.
2. Installation (Fig.1)
 

Connect the terminal plug from the electronic unit to the compressor terminal. Mount the electronic unit on the compressor by snapping the cover over the screw head①.
3. Power supply (Fig.1)
  - a. The electronic unit must always be connected directly to the battery poles②, connect the plus to (+) and the minus to (-), otherwise the electronic unit will not work. The electronic unit is protected against reverse battery connection.
  - b. For protection of the installation, a fuse ③ must be mounted in the (+) cable as close to the battery as possible. 15A fuse for 12V and 7.5A fuse for 24V circuits are recommended for model LZWQD25HHOZ, LZWQD30HHOZ and LZWQD35HHOZ.
  - c. If a main switch (4) is used, model LZWQD25HHOZ, LZWQD30HHOZ and LZWQD35HHOZ should be rated to a current of min.20A.
  - d. The wire dimensions in Table.2 must be observed. Avoid extra junctions in the power supply system to prevent voltage drop from affecting the battery protection setting.
4. Battery protection (Fig.1)
  - a. The compressor is stopped and re-started again according to the decided voltage limits measured on the (+) and (-) terminals of the electronic unit.
  - b. The standard settings for 12V and 24V power supply system appear from Table.3. Other setting (Table.1) are optional if a connection which includes a resistor (9) is established between terminals C and F.
5. Thermostat switch (Fig.1)
  - a. The thermostat⑦ is connected between the terminals C and T. Without any resistor in the control circuit, the compressor with electronic unit will run with a fixed speed of 2000 rpm when the thermostat is Switched On.
  - b. Other fixed compressor speeds in the range between 2000 and 3500 rpm can be obtained when a resistor ⑧ use installed to adjust the Voltage (V) of the control circuit. Resistor values for various motor Speeds appear from Table.4.
6. Fan (Optional, Fig.1)
  - a. A fan ⑤ can be connected between the terminals (+) and (F). Connect the plus to (+) and the minus to (F). Since the output Voltage between the terminals (+) and (F) is always regulated to 12V, a 12V fan must be used for 12V and 24V power supply systems.
  - b. The fan Output can supply a continuous current of 0.5A. A higher current draw is allowed for 2 seconds during start.
7. LED (Optional, Fig.1)
  - a. A 10mA light emitting diode (LED)⑥ can be connected between the terminals (+) and (D).
  - b. In case the electronic unit records an operational error, the diode will flash a number of times. The number of flashes depends on what kind of operational error was recorded. Each flash will last 1/5 second. After the actual number of flashes there will be a delay with no flashes, so that the sequence for each error recording is repeated every 3 minutes.

### 注意事项：

- 1、控制器通电前，请仔细阅读说明书，并检查连接线是否正确，不正确的连接可能损坏控制器；
- 2、控制器输入电压值不能大于直流35V。

### Notes：

1. Power electronic Unit please read the manual and check the connection is correct, incorrect connection may damage controller.
2. Electronic Unit can not be greater than the value of the input voltage 35V.

工作电压设定表 (表1)  
Optional battery protection settings (Table 1)

外接电源 Resistor ( $\Omega$ )K $\Omega$	12V停机值 12V cut-out V	12V开机值 12V cut-in V	12V高压停机值 12V Max cut-out V	24V停机值 24V cut-out V	24V开机值 24V cut-in V	24V高压停机值 24V Max cut-out V
0.0	9.6	10.9	17.0	21.3	22.7	31.5
1.6	9.7	11.0	17.0	21.5	22.9	31.5
2.4	9.9	11.1	17.0	21.8	23.2	31.5
3.6	10.0	11.3	17.0	22.0	23.4	31.5
4.7	10.1	11.4	17.0	22.3	23.7	31.5
6.2	10.2	11.5	17.0	22.5	23.9	31.5
8.2	10.4	11.7	17.0	22.8	24.2	31.5
11.0	10.5	11.8	17.0	23.0	24.5	31.5
14.0	10.6	11.9	17.0	23.3	24.7	31.5
18.0	10.8	12.0	17.0	23.6	25.0	31.5
24.0	10.9	12.2	17.0	23.8	25.2	31.5
33.0	11.0	12.3	17.0	24.1	25.5	31.5
47.0	11.1	12.4	17.0	24.3	25.7	31.5
82.0	11.3	12.5	17.0	24.6	26.0	31.5
220.0	9.6	10.9	17.0	21.3	22.7	31.5

电源进线推荐 (表2)  
Wire dimensions (Table 2)

线号 AWG Gauge	线径 Cross section (mm <sup>2</sup> )	12V最大长度Max Length 12V DC		24V最大长度Max Length 24V DC	
		ft	m	ft	m
13	2.5	8	2.5	16	5
12	4	13	4	26	8
10	6	20	6	39	12
8	10	23	10	66	20

标准电池保护设定推荐表 (表3)  
Standard battery protection settings (Table 3)

12V停机值 12V cut-out V	12V开机值 12V cut-in V	24V停机值 24V cut-out V	24V开机值 24V cut-in V
10.4	11.7	22.8	24.2

速度设定表(表4)  
Compressor speed settings (Table 4)

压缩机转速Motor speed (rpm)	C/T(8)间电阻C/T Resistor( $\Omega$ )	C/T(8)间电阻C/T current mA
2000	0	0.87-1.02
2100	51	1.02-1.17
2200	100	1.17-1.32
2300	150	1.32-1.48
2400	200	1.48-1.63
2500	277	1.63-1.78
2600	330	1.78-1.93
2700	400	1.93-2.08
2800	490	2.08-2.24
2900	586	2.24-2.39
3000	692	2.39-2.54
3100	816	2.54-2.69
3200	963	2.69-2.84
3300	1137	2.84-3.0
3400	1331	3.0-3.15
3500	1523	3.15-3.61
Stop	>3000	3.61-5

故障类型 (表5)  
Error Type (table 5)

闪烁次数 Number of Flashes	故障类型Error Type
1	电压故障--输入电压处于设定的范围之外。 Battery protection cut-out (The voltage is outside the cut-out setting)
2	风扇电流故障--风扇电流端输出电流大于1A。 Fan over-current cut-out (The fan loads the electronic unit with more than 1A)
3	压缩机启动故障--压缩机电机堵转或系统压力太大 (>6kg/cm <sup>3</sup> ) Motor start error (The rotor is blocked or the differential pressure in the refrigeration system is too high (>6kg/cm <sup>3</sup> ))
4	压缩机最小速度故障--压缩机负荷过大或电机的转速过小。 Minimum motor speed error (if the refrigeration system is too heavily loaded, the motor can not maintain minimum speed 1850 rpm or controller can not find the rotor position)
5	控制器温度故障--控制器外壳温度太高 (>75°C) The mal cut-out of electronic unit (if the refrigeration system had too heavily loaded, or if the ambient temperature is high, the electronic unit will run too hot (case temperature >75°C))
6	控制器硬件故障--控制器检测到不正常的参数。 Controller hardware failure (Controller detects abnormal parameters)

## 包装数据 Packing List

### 纸箱、木托包装数据

The Packing Details for Carton & Plywood Pallet

产品系列 Series	每托数量 QTY/PLT PSC	净重/件 N.W./PC KGS	毛重/件 G.W./PC KGS	纸箱尺寸 Carton Size CM	木托尺寸 PLT Size CM	层数 PCS/LAYER
DW	125/150	4.3-4.4	4.5-4.6	25.5*17*17	110*110*100/117	25
DM	125/150	5.1-5.3	5.4-5.6	25.5*17*19	110*110*110/129	25
DF	100/125	6.7-7.0	7.0-7.3	25.5*18*20.5	110*110*97/117	25
DL	100/125	8.6-9.1	8.9-9.4	25.5*18*23	110*110*107/129	25
DQ	80/100	9.6-10.3	9.9-10.6	28.8*19.8*22.6	110*110*105/127	20
FN	80/100	8.6-9.5	8.9-9.8	27*20*24	110*110*111/135	20
DV	125/150	4.5-4.6	4.7-4.8	25.5*16.5*16	110*110*95/111	25

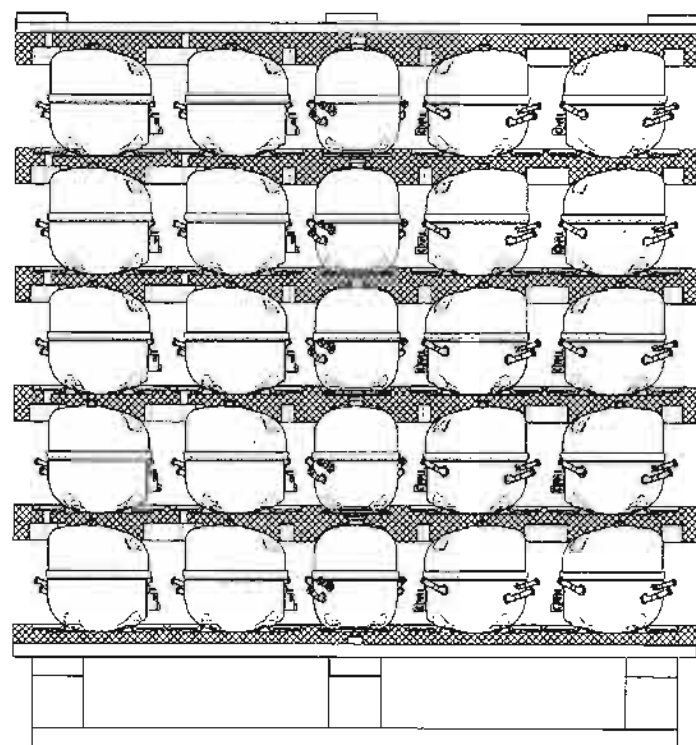

### 泡沫薄膜缠绕包装数据

The Packing Details for Foam Pallet

产品系列 Series	每托数量 QTY/PLT PSC	净重/件 N.W./PC KGS	木托尺寸 PLT Size CM	层数 PCS/LAYER
DW	168/180	4.3-4.4	106*96*102/117	28/30
DM	140/168	5.1-5.3	106*96*107/123	28
DF	96/120	6.7-7.0	114*95*93/113	24
DL	96/120	8.6-9.1	114*95*102/124	24
DQ	96/120	9.6-10.3	114*95*100/123	24
FN	80/100	8.6-9.5	100*100*103/125	20

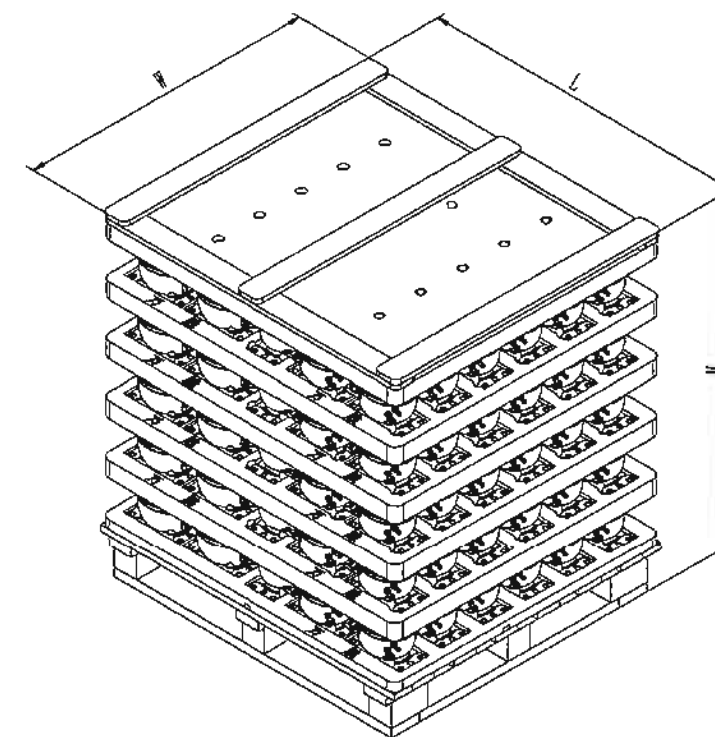

## RELAYS

CT90-290Q



### General Purpose Relays-8400 Series

This product feature quick connect terminals with universal mounting break away tabs

CATALOG NO.	DESCRIPTION	AMPS RES/NO	COIL VOLTAGE	LOM	ORDER MULTIPLE
CT90-290Q	SPST-NO	18A	24 VAC	EA	1
CT90-291Q	SPST-NO	18A	120 VAC	EA	1
CT90-293Q	SPST-NO	18A	240 VAC	EA	1
CT90-294Q	SPDT	8A	120 VAC	EA	1
CT90-295Q	SPDT	8A	240 VAC	EA	1

CTPR083



### Potential Relays

This product Relay has SPST NC configurations and offers a variety of mounting positions.

CATALOG NO.	COIL VOLTAGE	PICK-UP		DROP-OUT		LOM	ORDER MULTIPLE
		MIN	MAX	MAX	LOM		
CTPR083	188	140	153	45	EA	1	
CTPR084	395	242	272	140	EA	1	
CTPR085	332	171	184	90	EA	1	
CTPR086	395	223	252	130	EA	1	
CTPR087	420	300	328	121	EA	1	
CTPR088	502	314	342	135	EA	1	
CTPR089	395	180	195	105	EA	1	

CF-90340



### General Purpose Switching Relays

This Switching Relay has quick connect terminals for termination. The base is designed for easy replacement of competitive relays.

CATALOG NO.	COIL VOLTAGE	TERMINALS 1-2	TERMINALS 3-4	LOM	ORDER MULTIPLE
CF-90340	24 VAC	POWER	POWER	EA	1
CF-90341	110/120	POWER	POWER	EA	1
CF-90342	208/240	POWER	POWER	EA	1

## STARTERS

### Mars AllStart Hard Start Device

#### Feature:

- Maximum Starting Torque! More Than 20% Faster Starts
- Easy Two Wire Installation Recycles Instantly
- Individually packaged with wiring instructions

PART NO.	CROSS REFERENCE	MARS REPLACEMENT
TC-TO 5	KICKSTART	32708
CT-SPP6	SUPCO	32708
CT-WSX-1	WATSCO	32708



MARS NO.	MODEL NO.	H.P.	VOLT MAX.
32708	All Start	EA	115-277V

### Mars Combination Starters

#### Feature:

- Factory wired Wiring diagram on the product label
- Compact design
- Universal application reduces inventory

PART NO.	CROSS REFERENCE	MARS REPLACEMENT
CT-HS 410		32741
CT-HS 510	GEMLINE	32781
CT-HS 210		32725
CT-800-410		32741
CT-800-510	ROBERT SHAW	32781
CT-CT-800-210		32725
CT-RCO 410		32741
CT-RCO 510		32781
CT-RCO 210	SUPCO	32725



MARS NO.	MODEL NO.	HORSEPOWER	VOLT MAX.
32741	CT-MCS 41	1/4 to 1/3	115V
32781	CT-MCS 51	1/12 to 1/5	115V
32725	CT-MCS 25	1/2	115V

### Mars Motor Torque Multiplier

#### Feature:

- Totally solid state Integrated design! Fast, easy two wire installation
- Three mounting options; Clip, screw, or capacitor bracket
- Individually packaged

PART NO.	CROSS REFERENCE	MARS REPLACEMENT
CT-HS 600	GEMLINE	32701
CF-HS 600		32702
CF-800-052	ROBERTSHAW	32702
CF-800-067		32701
CF-SPP5		32701
CF-SPP6	SUPCO	32702



MARS NO.	MODEL NO.	HORSEPOWER	VOLT MAX.
32701	CT-100	5 to 5	277V
32702	CT-200	5 to 10	277V

## TIME DELAYS

CT-ADB-2



CT-ADB-1



### Adjustable Delay on Break Timer

CATALOG NO.	DESCRIPTION	LOM	ORDER MULTIPLE
CT-ADB-1	Adjustable Delay on Break	EA	1
CT-ADB-2	Adjustable Delay on Break w/Wire Leads	EA	1

CT-ADM-2



CT-ADM-1



### Adjustable Delay on Break Timer

CATALOG NO.	DESCRIPTION	LOM	ORDER MULTIPLE
CT-ADM-1	Adjustable Delay on Break	EA	1
CT-ADM-2	Adjustable Delay on Break w/Wire Leads	EA	1



### PP 1100 relay

Model:1/8HP 1/6HP 1/5HP 1/4HP 1/3HP 1/2HP  
Power supply:110V/60Hz 220V/50Hz



### JB series overload

Model:1/8HP 1/6HP 1/5HP 1/4HP 1/3HP 1/2HP  
Power supply:110V/60Hz 220V/50Hz



### PTC series relay

Model:1pin 2pins 3pins 4pins  
Power supply:110V 220V



### RP series relay

Model:1/8HP 1/6HP 1/5HP 1/4HP 1/3HP 1/2HP  
Power supply:110V/60Hz 220V/50Hz



### IC-4 series relay

Model:1pin 2pins 3pins 4pins  
Power supply:110V 220V



### SPP Relay



### 4TM overload

Model:1/8HP 1/6HP 1/5HP 1/4HP 1/3HP 1/2HP  
Power supply:110V/60Hz 220V/50Hz



### Danfoss long relay

Model:1/8HP 1/6HP 1/5HP 1/4HP 1/3HP 1/2HP  
Power supply:110V/60Hz 220V/50Hz



### ICG-1 Relay

Power supply:110V/60Hz 220V/50Hz



### Danfoss short relay

Model:1/8HP 1/6HP 1/5HP 1/4HP 1/3HP 1/2HP  
Power supply:110V/60Hz 220V/50Hz



### JQ series relay

Model:1/8HP 1/6HP 1/5HP 1/4HP 1/3HP 1/2HP  
Power supply:110V/60Hz 220V/50Hz

# Hermetic Piston Refrigerant Compressor Screw Connection Type



Screw thread connection type

Refrigerant: R404a/R407

With electron box



Screw thread connection type

Refrigerant: R404a/R407

Middle and High temperature

Refrigerant	Model	Nominal Power (HP)	Displacement (cm <sup>3</sup> /rev)	Power	Refrigerant Capacity at 50Hz Rated @ 54.4°C Condensing (W)						Oil Charge (cm <sup>3</sup> )	Weight (kg)
					-25°C -12°F	-15°C +5°F	-10°C +14°F	0°C +32°F	+7.2°C +45°F	+15°C +59°F		
R404a R407	CTH44K	2	44	220-240V/1PH/50Hz 208-230V/1PH/60Hz	1379*	1850	2580	4370	5977	8110	1600	33
	CTH52K	2.5	52		1508*	2260	3240	5400	7146	9320		33
	CTH58K	3	58.2		1635*	2390	3310	5720	7967	10240		34
	CTH62K	3	62.7		1998*	2970	3960	6420	8613	11540		34
	CTH3-44K	2	44	220V/3PH/60Hz 380V/3PH/50Hz 380V/3PH/60Hz 460V/3PH/60Hz	1379*	1850	2580	4370	5977	8110	1500	31
	CTH3-52K	2.5	52		1508*	2260	3240	5400	7146	9320		31
	CTH3-58K	3	58.2		1635*	2390	3310	5720	7967	10240		33
	CTH3-62K	3	62.7		1998*	2970	3960	6420	8613	11540		33
	CTH3-74K	3.5	74.2		3078*	2805	4296	7276	9814	13056		33
	CTH3-90K	4	90.2		1510	3388	4425	7956	11300	15719		46
	CTH3-112K	5	112.5		3965	4360	5890	10450	14780	20230		46
	CTH3-124K	6	124.4	5146	5320	7080	11970	16650	22760	48		
	CTH3-134K	7	134.8	5453	5760	7710	13120	18230	24806	48		

# Hermetic Piston Refrigerant Compressor Copper Connection Type



Copper connection type

Refrigerant: R404a/R407

With electron box



Copper connection type

Refrigerant: R404a/R407

Middle and High temperature

Refrigerant	Model	Nominal Power (HP)	Displacement (cm <sup>3</sup> /rev)	Power	Refrigerant Capacity at 50Hz Rated @ 54.4°C Condensing (W)						Oil Charge (cm <sup>3</sup> )	Weight (kg)
					-25°C -12°F	-15°C +5°F	-10°C +14°F	0°C +32°F	+7.2°C +45°F	+15°C +59°F		
R404a R407	CTH44AK	2	44	220-240V/1PH/50Hz 208-230V/1PH/60Hz	1379*	1850	2580	4370	5977	8110	1600	33
	CTH52AK	2.5	52		1508*	2260	3240	5400	7146	9320		33
	CTH58AK	3	58.2		1635*	2390	3310	5720	7967	10240		34
	CTH62AK	3	62.7		1998*	2970	3960	6420	8613	11540		34
	CTH3-44AK	2	44	220V/3PH/60Hz 380V/3PH/50Hz 380V/3PH/60Hz 460V/3PH/60Hz	1379*	1850	2580	4370	5977	8110	1500	31
	CTH3-52AK	2.5	52		1508*	2260	3240	5400	7146	9320		31
	CTH3-58AK	3	58.2		1635*	2390	3310	5720	7967	10240		33
	CTH3-62AK	3	62.7		1998*	2970	3960	6420	8613	11540		33
	CTH3-74AK	3.5	74.2		3078*	2805	4296	7276	9814	13056		33
	CTH3-90AK	4	90.2		1510	3388	4425	7956	11300	15719		46
	CTH3-112AK	5	112.5		3965	4360	5890	10450	14780	20230		46
	CTH3-124AK	6	124.4	5146	5320	7080	11970	16650	22760	48		
	CTH3-134AK	7	134.8	5453	5760	7710	13120	18230	24806	48		



Screw thread connection type

Refrigerant: R22

With electron box



Screw thread connection type

Refrigerant: R22

Refrigerant	Model	Nominal Power (HP)	Displacement (cm <sup>3</sup> /rev)	Power	Refrigerant Capacity at 50Hz Rated @ 54.4°C Condensing (W)						Oil Charge (cm <sup>3</sup> )	Weight (kg)
					-25°C -12°F	-15°C +5°F	-10°C +14°F	0°C +32°F	+7.2°C +45°F	+15°C +59°F		
R22	CTH44E	2	44	220-240V/1PH/50Hz 208-230V/1PH/60Hz	1320*	1960	2680	4300	5770	7830	1600	33
	CTH52E	2.5	52		1610*	2370	3180	5300	7050	9200		33
	CTH58E	3	58.2		1820*	2720	3680	5950	7900	10300		35
	CTH62E	3	62.7		1950*	2890	3830	6300	8500	11450		35
	CTH3-44E	2	44	220V/3PH/60Hz 380V/3PH/50Hz 380V/3PH/60Hz 460V/3PH/60Hz	1320*	1960	2680	4300	5770	7830	1500	31
	CTH3-52E	2.5	52		1610*	2370	3180	5300	7050	9200		31
	CTH3-58E	3	58.2		1820*	2720	3680	5950	7900	10300		33
	CTH3-62E	3	62.7		1950*	2890	3830	6300	8500	11450		33
	CTH3-74E	3.5	74.2		2038*	3000	4300	7330	9860	12900		33
	CTH3-90E	4	90.2		1330	3100	4370	7840	11250	16000		46
	CTH3-112E	5	112.5		2060	4470	6130	10600	14900	20660		46
	CTH3-124E	6	124.4	2500	5160	6970	11860	16640	23360	48		
	CTH3-134E	7	134.8	2800	5630	7500	12630	17800	25200	48		



Copper connection type

Refrigerant: R22

With electron box



Copper connection type

Refrigerant: R22

Refrigerant	Model	Nominal Power (HP)	Displacement (cm <sup>3</sup> /rev)	Power	Refrigerant Capacity at 50Hz Rated @ 54.4°C Condensing (W)						Oil Charge (cm <sup>3</sup> )	Weight (kg)
					-25°C -12°F	-15°C +5°F	-10°C +14°F	0°C +32°F	+7.2°C +45°F	+15°C +59°F		
R22	CTH44AE	2	44	220-240V/1PH/50Hz 208-230V/1PH/60Hz	1320*	1960	2680	4300	5770	7830	1600	33
	CTH52AE	2.5	52		1610*	2370	3180	5300	7050	9200		33
	CTH58AE	3	58.2		1820*	2720	3680	5950	7900	10300		35
	CTH62AE	3	62.7		1950*	2890	3830	6300	8500	11450		35
	CTH3-44AE	2	44	220V/3PH/60Hz 380V/3PH/50Hz 380V/3PH/60Hz 460V/3PH/60Hz	1320*	1960	2680	4300	5770	7830	1500	31
	CTH3-52AE	2.5	52		1610*	2370	3180	5300	7050	9200		31
	CTH3-58AE	3	58.2		1820*	2720	3680	5950	7900	10300		33
	CTH3-62AE	3	62.7		1950*	2890	3830	6300	8500	11450		33
	CTH3-74AE	3.5	74.2		2038*	3000	4300	7330	9860	12900		33
	CTH3-90AE	4	90.2		1330	3100	4370	7840	11250	16000		46
	CTH3-112AE	5	112.5		2060	4470	6130	10600	14900	20660		46
	CTH3-124AE	6	124.4	2500	5160	6970	11860	16640	23360	48		
	CTH3-134AE	7	134.8	2800	5630	7500	12630	17800	25200	48		

## Hermetic Piston Refrigerant Compressor Parallel Screw Connection Type

Middle and High temperature

Refrigerant	Model	Nominal Power (H.P.)	Displacement (cm <sup>3</sup> /rev)	Power	Refrigeration Capacity at 50Hz Rated @ 34.4°C Cond Temp. (W)						Oil Charge (cm <sup>3</sup> )	Weight (kg)
					-25°C -12°F	-15°C +5°F	-10°C +14°F	0°C +32°F	+7.2°C +45°F	+15°C +59°F		
R404a R407	CTH3-44PK	2	44	220V/3PH/60Hz 380V/3PH/50Hz 380V/3PH/60Hz 460V/3PH/60Hz	1379*	1850	2580	4370	5977	8110	1500	31
	CTH3-62PK	2.5	52		1508*	2260	3240	5400	7146	9320		31
	CTH3-68PK	3	58.2		1635*	2390	3310	5720	7967	10240		33
	CTH3-62PK	3	62.7		1998*	2970	3960	6420	8613	11540		33
	CTH3-74PK	3.5	74.2		3078*	2805	4296	7276	9814	13056		33
	CTH3-90PK	4	90.2		1510	3388	4425	7956	11300	15719		46
	CTH3-112PK	5	112.5		3965	4360	5890	10450	14780	20230		46
	CTH3-124PK	6	124.4		5146	5320	7080	11970	16650	22760		48
	CTH3-134PK	7	134.8		6463	6780	7710	13120	18230	24806		48
	R22	CTH3-44PE	2		44	220V/3PH/60Hz 380V/3PH/50Hz 380V/3PH/60Hz 460V/3PH/60Hz	1320*	1960	2480	4300		5770
CTH3-62PE		2.5	52	1610*	2370		3180	5300	7050	9200	31	
CTH3-68PE		3	58.2	1820*	2720		3680	5950	7900	10300	33	
CTH3-62PE		3	62.7	1950*	2890		3830	6300	8500	11450	33	
CTH3-74PE		3.5	74.2	2038*	3000		4300	7330	9860	12900	33	
CTH3-90PE		4	90.2	1330	3100		4370	7840	11250	16000	46	
CTH3-112PE		5	112.5	2060	4470		6130	10600	14900	20660	46	
CTH3-124PE		6	124.4	2500	5160		6970	11860	16640	23360	48	
CTH3-134PE		7	134.8	2800	5630		7500	12630	17800	25200	48	



## Hermetic Piston Refrigerant Compressor Screw Connection Type & Copper Connection Type

Low temperature / Low pressure



Screw thread connection type

Refrigerant: R404a/R407

## Hermetic Piston Refrigerant Compressor Parallel Copper Connection Type

Middle and High temperature

Refrigerant	Model	Nominal Power (H.P.)	Displacement (cm <sup>3</sup> /rev)	Power	Refrigeration Capacity at 50Hz Rated @ 34.4°C Cond Temp. (W)						Oil Charge (cm <sup>3</sup> )	Weight (kg)
					-25°C -12°F	-15°C +5°F	-10°C +14°F	0°C +32°F	+7.2°C +45°F	+15°C +59°F		
R404a R407	CTH3-44PAK	2	44	220V/3PH/60Hz 380V/3PH/50Hz 380V/3PH/60Hz 460V/3PH/60Hz	1379*	1850	2580	4370	5977	8110	1500	31
	CTH3-62PAK	2.5	52		1508*	2260	3240	5400	7146	9320		31
	CTH3-68PAK	3	58.2		1635*	2390	3310	5720	7967	10240		33
	CTH3-62PAK	3	62.7		1998*	2970	3960	6420	8613	11540		33
	CTH3-74PAK	3.5	74.2		3078*	2805	4296	7276	9814	13056		33
	CTH3-90PAK	4	90.2		1510	3388	4425	7956	11300	15719		46
	CTH3-112PAK	5	112.5		3965	4360	5890	10450	14780	20230		46
	CTH3-124PAK	6	124.4		5146	5320	7080	11970	16650	22760		48
	CTH3-134PAK	7	134.8		6463	6780	7710	13120	18230	24806		48
	R22	CTH3-44PAE	2		44	220V/3PH/60Hz 380V/3PH/50Hz 380V/3PH/60Hz 460V/3PH/60Hz	1320*	1960	2480	4300		5770
CTH3-62PAE		2.5	52	1610*	2370		3180	5300	7050	9200	31	
CTH3-68PAE		3	58.2	1820*	2720		3680	5950	7900	10300	33	
CTH3-62PAE		3	62.7	1950*	2890		3830	6300	8500	11450	33	
CTH3-74PAE		3.5	74.2	2038*	3000		4300	7330	9860	12900	33	
CTH3-90PAE		4	90.2	1330	3100		4370	7840	11250	16000	46	
CTH3-112PAE		5	112.5	2060	4470		6130	10600	14900	20660	46	
CTH3-124PAE		6	124.4	2500	5160		6970	11860	16640	23360	48	
CTH3-134PAE		7	134.8	2800	5630		7500	12630	17800	25200	48	



Low temperature / Low Pressure

Refrigerant	Model	Nominal Power (H.P.)	Displacement (cm <sup>3</sup> /rev)	Power	Refrigeration Capacity at 50Hz Rated @ 34.4°C Cond Temp. (W)							Oil Charge (cm <sup>3</sup> )		
					-40°C -40°F	-35°C -31°F	-30°C -22°F	-23.3°C -8.9°F	-20°C -4°F	-10°C +14°F	0°C +32°F			
R404a R407	CTL52K	2.5	52	220-240V/1PH/50Hz 208-230V/1PH/60Hz	475*	836	1410	2068	3037	5050	5300	1500		
	CTL82K	3	62.7		1136*	1286	1993	2617	3660	6130	6300			
	CTL3-52K	2.5	52		220V/3PH/60Hz 380V/3PH/50Hz 380V/3PH/60Hz 460V/3PH/60Hz	475*	836	1410	2068	3037	5050		5300	2000
	CTL3-74K	3.5	74.2			1404*	1521	2358	3051	4333	7265		7330	
	CTL3-112K	5	112.5			1646*	2035	3164	4365	6231	10550		10600	
	CTL3-134K	7	134.8			2354*	2782	4177	5428	7892	12120		12630	
	CTL52AK	2.5	52	220-240V/1PH/50Hz 208-230V/1PH/60Hz		475*	836	1410	2068	3037	5050	5300	1500	
	CTL82AK	3	62.7			1136*	1286	1993	2617	3660	6130	6300		
	CTL3-52AK	2.5	52		220V/3PH/60Hz 380V/3PH/50Hz 380V/3PH/60Hz 460V/3PH/60Hz	475*	836	1410	2068	3037	5050	5300		2000
	CTL3-74AK	3.5	74.2			1404*	1521	2358	3051	4333	7265	7330		
	CTL3-112AK	5	112.5			1646*	2035	3164	4365	6231	10550	10600		
	CTL3-134AK	7	134.8			2354*	2782	4177	5428	7892	12120	12630		

## Hermetic Piston Refrigerant Compressor Double Inspiratory / Parallel Screw Connection type

Middle and High temperature

Refrigerant	Model	Nominal Power (H.P.)	Displacement (cm <sup>3</sup> /rev)	Power	Refrigeration Capacity at 50Hz Rated @ 34.4°C Cond Temp. (W)						Oil Charge (cm <sup>3</sup> )	Weight (kg)
					-25°C -12°F	-15°C +5°F	-10°C +14°F	0°C +32°F	+7.2°C +45°F	+15°C +59°F		
R404a R407	CTH3-44PDK	2	44	220V/3PH/60Hz 380V/3PH/50Hz 380V/3PH/60Hz 460V/3PH/60Hz	1379*	1850	2580	4370	5977	8110	1500	31
	CTH3-62PDK	2.5	52		1508*	2260	3240	5400	7146	9320		31
	CTH3-68PDK	3	58.2		1635*	2390	3310	5720	7967	10240		33
	CTH3-62PDK	3	62.7		1998*	2970	3960	6420	8613	11540		33
	CTH3-74PDK	3.5	74.2		3078*	2805	4296	7276	9814	13056		33
	CTH3-90PDK	4	90.2		1510	3388	4425	7956	11300	15719		46
	CTH3-112PDK	5	112.5		3965	4360	5890	10450	14780	20230		46
	CTH3-124PDK	6	124.4		5146	5320	7080	11970	16650	22760		48
	CTH3-134PDK	7	134.8		6463	6780	7710	13120	18230	24806		48
	R22	CTH3-44PDE	2		44	220V/3PH/60Hz 380V/3PH/50Hz 380V/3PH/60Hz 460V/3PH/60Hz	1320*	1960	2480	4300		5770
CTH3-62PDE		2.5	52	1610*	2370		3180	5300	7050	9200	31	
CTH3-68PDE		3	58.2	1820*	2720		3680	5950	7900	10300	33	
CTH3-62PDE		3	62.7	1950*	2890		3830	6300	8500	11450	33	
CTH3-74PDE		3.5	74.2	2038*	3000		4300	7330	9860	12900	33	
CTH3-90PDE		4	90.2	1330	3100		4370	7840	11250	16000	46	
CTH3-112PDE		5	112.5	2060	4470		6130	10600	14900	20660	46	
CTH3-124PDE		6	124.4	2500	5160		6970	11860	16640	23360	48	
CTH3-134PDE		7	134.8	2800	5630		7500	12630	17800	25200	48	



# R134a Condensing Units



R134a (220V-240V/50Hz) L/MBP Application

Model	Displ. (Cm <sup>3</sup> )	Power HP	Motor Type	Cooling	Capacity(W)@4.4°C/ 39°F Condensing Temp.										COP WW		Input Power (W)		Oil Charge
					-20	-15	-10	-5	0	5	10	15	20	25	27	29	31		
CU-MAMQD30HHP	3.0	1/10	RSIR	S	36	49	63	70	90	112	152	170	188	210	0.85	1.00	82	89	140
CU-MAMQD35HHP	3.5	1/8	RSIR	S	40	56	72	80	105	128	176	220	242	275	0.90	1.08	89	111	160
CU-MAMQD43HHP	4.3	1/7	RSIR	S	47	65	83	110	121	149	216	270	297	338	0.95	2.01	116	134	180
CU-MAFQD52HHP	5.5	1/7	RSIR	S	70	95	123	136	177	218	280	350	385	438	1.15	2.01	118	174	180
CU-MAFQD59HHP	6.2	1/6	RSIR	S	85	115	149	185	215	265	312	390	430	488	1.20	2.00	128	195	180
CU-MAFQD65HHP	6.6	1/5	RSIR	S	95	129	167	185	241	297	360	430	473	538	1.25	2.02	148	193	180
CU-MAFQD75HHP	7.6	1/5+	RSIR	S/F	105	147	190	210	273	337	387	496	645	618	1.25	2.10	168	236	180
CU-MALQD91HHR	8.8	1/5+	RSIR	S/F	115	180	207	230	300	368	425	530	583	655	1.37	2.12	168	250	220
CU-MALQD110HHR	10.6	1/4+	RSIR	F	135	189	243	285	370	458	520	660	715	813	1.41	2.12	202	307	220
CU-MALQD120HHR	11.8	1/3	RSIR	F	165	231	297	330	430	528	576	720	792	900	1.41	2.12	234	340	220
CU-MAQQD128HHR	12.3	3/8	RSIR	F	180	252	324	360	468	576	740	925	1018	1158	1.31	2.00	275	463	250
CU-MAQQD142HHR	13.5	3/8+	CSIR	F	195	273	351	390	507	624	800	1000	1100	1250	1.30	2.00	300	500	250
CU-MAQQD158HHR	15.3	3/8+	CSIR	F	215	300	387	430	560	690	890	1120	1230	1400	1.30	2.00	331	560	250
CU-MAQQD168HHR	16.3	1/2	CSIR	F	230	322	415	460	598	738	976	1220	1340	1530	1.30	2.00	354	610	250



R134a (220V-240V/50Hz) M/HBP Application

Model	Displ. (Cm <sup>3</sup> )	Power HP	Motor Type	Cooling	Capacity(W)@4.4°C/ 39°F Condensing Temp.										COP WW		Input Power (W)		Oil Charge
					-20	-15	-10	-5	0	5	10	15	20	25	27	29	31		
CU-HAMQD30HHP	3.0	1/8	RSIR	S	90	120	150	190	210	225	273	300	345	420	1.90	2.18	100	158	160
CU-HAMQD35HHP	3.5	1/7	RSIR	S	105	140	175	220	245	263	318	350	403	490	1.98	2.31	111	162	160
CU-HAMQD43HHP	4.3	1/6	RSIR	S	130	172	215	270	300	323	391	430	495	600	2.01	2.38	134	182	160
CU-HAFQD52HHP	4.9	1/6+	RSIR	S	145	196	245	310	343	368	446	490	563	686	2.01	2.37	154	207	180
CU-HAFQD59HHP	5.5	1/5	RSIR	S	165	220	275	345	385	413	500	550	633	770	2.00	2.35	173	234	180
CU-HAFQD65HHP	6.2	1/5+	RSIR	S	190	262	315	390	441	473	573	630	725	882	2.06	2.41	190	261	180
CU-HALQD75HHR	7.2	1/4	RSIR	S/F	205	276	345	430	483	518	628	690	826	965	2.10	2.51	205	275	220
CU-HALQD91HHR	8.8	1/4+	RSIR	S/F	250	332	415	530	580	623	747	830	955	1160	2.12	2.51	250	331	220
CU-HALQD110HHR	10.6	1/3+	CSIR	F	305	411	515	650	720	771	935	1028	1182	1439	2.12	2.52	307	408	220
CU-HALQD120HHR	11.6	3/8+	CSIR	F	365	516	645	790	900	960	1170	1290	1480	1770	2.10	2.50	348	516	220
CU-HAQQD128HHR	12.3	3/8+	CSIR	F	395	528	660	830	924	990	1200	1320	1518	1848	2.02	2.38	411	558	250
CU-HAQQD142HHR	13.6	1/2	CSIR	F	440	586	739	920	1026	1099	1333	1465	1685	1978	2.02	2.37	455	616	250
CU-HAQQD158HHR	15.3	1/2+	CSIR	F	480	640	800	1008	1120	1200	1456	1600	1840	2160	2.02	2.37	499	675	250

# R404A Condensing Units



R404A (220V-240V/50Hz) L/MBP Application

Model	Displ. (Cm <sup>3</sup> )	Power HP	Motor Type	Cooling	Capacity(W)@4.4°C/ 39°F Condensing Temp.										COP WW		Input Power (W)		Oil Charge
					-20	-15	-10	-5	0	5	10	15	20	25	27	29	31		
CU-MAMQD30KHM	3.0	1/8	CSIR	F	96	107	147	161	193	243	309	324	356	366	1.28	1.76	130	89	160
CU-MAMQD35KHM	3.5	1/6	CSIR	F	112	125	172	189	225	284	350	378	416	454	1.26	1.76	151	108	160
CU-MAFQD43KHM	4.3	1/5	CSIR	F	134	160	207	228	271	342	422	456	501	547	1.30	1.80	175	127	180
CU-MAFQD52KHM	4.9	1/5	CSIR	F	163	171	236	280	309	390	480	619	671	623	1.30	1.80	200	144	180
CU-MALQD59KHM	5.5	1/5+	CSIR	F	178	200	275	303	380	464	560	606	688	726	1.35	2.00	224	161	220
CU-MALQD65KHM	6.2	1/4	CSIR	F	201	225	310	341	408	512	631	682	750	818	1.45	2.00	235	171	220
CU-MALQD75KHM	7.2	1/4+	CSIR	F	234	281	380	398	471	594	733	792	871	950	1.50	2.06	264	193	220
CU-MAQQD91KHM	8.8	3/8	CSIR	F	275	308	424	468	555	700	863	933	1026	1119	1.45	2.00	322	233	250
CU-MAQQD110KHM	10.6	3/8+	CSIR	F	331	371	511	562	669	843	1039	1124	1236	1348	1.45	2.00	387	281	250
CU-MATQD128KHM	12.12	9/16	CSIR	F	363	407	561	616	733	924	1140	1232	1355	1478	1.24	1.70	497	362	450
CU-MATQD158KHM	14.5	5/8	CSIR	F	346	387	533	586	697	879	1084	1172	1289	1406	1.28	1.72	458	341	450
CU-MATQD168KHM	16.8	3/4	CSIR	F	498	554	784	840	1000	1260	1554	1680	1848	2018	1.26	1.72	667	488	450
CU-MATQD180KHM	17.4	3/4	CSIR	F	486	521	718	780	939	1184	1460	1578	1736	1894	1.15	1.60	686	483	450
CU-MATQD210KHM	20.4	3/4	CSIR	F	537	601	828	910	1083	1365	1664	1820	2002	2184	1.34	1.80	679	508	450

R404A (220V-240V/50Hz) M/HBP Application

Model	Displ. (Cm <sup>3</sup> )	Power HP	Motor Type	Cooling	Capacity(W)@4.4°C/ 39°F Condensing Temp.										COP WW		Input Power (W)		Oil Charge
					-20	-15	-10	-5	0	5	10	15	20	25	27	29	31		
CU-HAMQD30KHM	3.0	1/8	CSIR	F	203	226	236	273	292	358	433	471	518	612	1.90	2.20	144	214	160
CU-HAMQD35KHM	3.5	1/6	CSIR	F	236	264	275	319	341	418	506	550	604	714	1.85	2.25	163	244	160
CU-HAFQD43KHM	4.3	1/5	CSIR	F	290	324	338	392	419	513	621	675	743	878	1.95	2.25	201	300	180
CU-HAFQD52KHM	4.9	1/5	CSIR	F	331	369	385	448	477	585	708	769	846	1000	1.95	2.25	229	342	180
CU-HALQD59KHM	5.5	1/5+	CSIR	F	371	414	432	501	535	656	794	864	950	1123	2.00	2.30	250	375	220
CU-HALQD65KHM	6.2	1/4	CSIR	F	419	467	487	565	604	740	898	973	1071	1265	2.00	2.30	282	423	220
CU-HALQD75KHM	7.2	1/4+	CSIR	F	486	543	565	656	701	859	1040	1130	1243	1470	2.00	2.30	328	491	220
CU-HAQQD91KHM	8.8	3/8	CSIR	F	594	663	691	801	857	1050	1271	1382	1520	1796	1.90	2.20	422	628	250
CU-HAQQD110KHM	10.6	3/8+	CSIR	F	716	799	832	966	1032	1286	1531	1664	1831	2163	1.90	2.20	508	756	250
CU-HATQD128KHM	12.12	9/16	CSIR	F	745	831	866	1005	1074	1318	1593	1732	1905	2252	1.95	2.28	616	766	450
CU-HATQD158KHM	14.5	5/8	CSIR	F	814	1020	1063	1233	1316	1616	1956	2128	2339	2764	1.90	2.20	649	966	450
CU-HATQD180KHM	17.4	3/4	CSIR	F	1032	1152	1200	1392	1488	1824	2208	2400	2640	3120	1.90	2.17	733	1106	450
CU-HATQD210KHM	20.4	3/4	CSIR	F	1245	1390	1448	1678	1795	2200	2683	2896	3186	3764	1.90	2.20	884	1316	450



# R22 Condensing Units



## R22 (220V-240V/50Hz) L/MBP Application

Model	Diam (Cm3)	Power HP	Motor Type	Cooling	Capacity(W/54.4°C/130°F Condensing Temp.)										COP WW		Input Power (W)		Oil Charge
					7	8	9	10	11	12	13	14	15	16	17	18	19	20	
CU-MAMQD30EHM	3.0	1/8	CSIR	F	78	85	117	129	161	181	245	284	310	1.25	1.75	103	74	180	
CU-MAMQD35EHM	3.5	1/8	CSIR	F	89	99	137	151	188	211	286	301	331	1.25	1.75	120	86	180	
CU-MAFQD43EHM	4.3	1/8	CSIR	F	109	122	168	185	231	259	351	370	407	1.20	1.70	154	109	180	
CU-MAFQD52EHM	4.9	1/8	CSIR	F	124	139	192	211	263	295	400	421	464	1.20	1.70	176	124	180	
CU-MALQD58EHM	6.5	1/8+	CSIR	F	140	156	215	237	296	331	449	473	520	1.25	1.75	189	135	220	
CU-MALQD65EHM	6.2	1/4	CSIR	F	157	176	243	267	333	373	507	533	587	1.23	1.70	217	157	220	
CU-MALQD75EHM	7.2	1/4+	CSIR	F	183	204	282	310	387	433	588	619	681	1.23	1.70	252	182	220	
CU-MAQD81EHM	8.8	3/8	CSIR	F	202	227	312	343	429	480	652	686	755	1.20	1.70	286	202	250	
CU-MAQD110EHM	10.6	3/8+	CSIR	F	219	245	338	371	464	519	705	742	816	1.20	1.70	309	218	250	
CU-MATQD128EHM	12.12	9/16	CSIR	F	250	280	386	424	530	584	806	848	933	1.24	1.70	342	250	450	
CU-MATQD158EHM	14.5	5/8	CSIR	F	289	335	462	508	634	711	984	1015	1117	1.18	1.68	430	302	450	
CU-MATQD168EHM	16.8	3/4	CSIR	F	347	388	535	588	735	823	1117	1178	1294	1.26	1.72	487	342	450	
CU-MATQD180EHM	17.4	3/4	CSIR	F	359	402	554	609	761	853	1157	1218	1340	1.24	1.74	491	350	450	
CU-MATQD210EHM	20.4	3/4	CSIR	F	421	471	650	714	893	1000	1367	1428	1571	1.34	1.80	533	387	450	

# Hitachi Horizontal Rotary Condensing unit



### Product advantages:

- Wide voltage operation, the operating voltage from 180V to 240V. Hitachi horizontal compressor, high efficiency, high reliability, no noise and vibration.
- Wide voltage operation, the operating voltage from 180V to 240V. Hitachi horizontal compressor, high efficiency, high reliability, no noise and vibration.
- All pump parts titanium nitride coating treatment, wear and anti-strike capability was stronger, life doubled.
- Horizontal units height is lower (240 ~ 275mm), it can get the most effective volume of the showcase. Also it can be installed directly inside the device. It reducing installation costs.
- High performance, high efficiency, high winds patent motor; doubled efficiency than similar motor.
- Automatic spray fluid control and reduce the input power at different temperatures.
- Use built-in motor bundled protection, the motor temperature monitoring more sensitive, to prevent abnormal overheating of the motor through frequent starting.

## 技术参数 Technical Date

MODEL	CTHC-127D04D	CTHC-211D04D	CTHC-307D04D	CTHC-356D04D	CTHC-488D04D
Input Power(W)	E30	1060	1500	1730	2470
Power	220V-240V/1PH/50HZ				380V/3PH/50HZ
Refrigerant (Maximum liquid volume KG)	R404A(1.2)	R404A(2.0)	R404A(3.0)	R404A(3.0)	R404A(3.7)
Starting current(A)	20	35	42	50	35
Maximum RunningCurrent(A)	4.0	7.0	9.2	10.6	7.0
evaporating temperature °C	(-25~0)		(-40~0)		
Ambient Temp °C	(-7~43)				
Compressor Model	DDD127CV-A2A	DDL211CV-B5M	DDH307LV-B5M	DDH356LV-B5M	DWH488LV-B5M
Condenser	Spec				
	Fan	4 rows 5 rings	5 rows 5 rings	5 rows 5 rings	5 rows 5 rings
Pipe Conn. mm (Inch)	Suction (Dia.)		ø12.7(1/2")		
	Liquid (Dia.)		ø9.53(3/8")		
Dimension (mm)	L(mm)		680	790	940
	W(mm)		480	520	540
	H(mm)		275	275	275
Installation	L*W		650*450	760*490	910*510
	Evaporating Temp (°C)		Capacity: W, Condensing Temp: 45°C, Ambient temperature: 32°C		
Capacity	-40		/	/	1291(1110)
	-35		/	/	1621(1394)
	-30		/	/	2000(1720)
	-25		960(825)	1500(1290)	2427(2087)
	-20		1195(1028)	1830(1574)	2903(2497)
	-15		1500(1290)	2100(1806)	3424(2945)
	-10		1850(1591)	2500(2150)	3986(3428)
Connection capacity	Leakage protector	Rated current	10	15	20
		Leakage current	30	30	30
	Wire dia (mm2)	10m IN10m	2	2	4
		20m IN20m	2.5	2.5	6
30m IN30m		2.5	2.5	6	

## R22 Air Conditioning Series

Working Range for Compressor	
Refrigerant	R22
Nominal Condition	T3
Evaporating Temp.	-15~12.5°C
Max.condensing Temp.	68°C
Winding Resistance Temp.	130°C
Max.Ambient Temp.	52°C
Oil Brand	3GS

NOMINAL CONDITION	
Evaporating Temp.	7.2°C
Condensing Temp.	54.4°C
Ambient Temp.	35.0°C
Subcooling	0K
Superheat	11K



Model	Displacement (cm³/rev)	Nominal Capacity (W)	Power Input (W)	RLA (A)	COP (W/W)	Power	Oil Charge (cm³)	Weight (kg)	Run Capacitor	Refrigeration Capacity at 50HZ Rated @54.4°C Cond.Temp. (W)				
										-10	-5	0	7.2	15
CT5518	33.5	4100	1600	8.6	2.50	1PH 220V/ 50hz	1200	26	25	1993	2287	3115	4100	5553
CT5522	41.4	5300	2100	10.6	2.62		1200	27	30	2275	2957	3862	5300	7230
CT5527	49.8	8300	2400	11.3	2.62		1200	27	40	2812	3652	4654	6300	9820
CT5531	58.4	7800	2900	14.0	2.62		1200	28	40	3630	4773	5862	7800	10210
CT5518S	33.5	4100	1600	2.6	2.50	3PH 380V/ 50HZ	1200	26		1993	2287	3115	4100	5553
CT5522S	41.4	5300	2100	3.2	2.62		1200	27		2275	2957	3862	5300	7230
CT5527S	49.8	8300	2400	3.8	2.62		1200	27		2812	3652	4654	6300	9820
CT5531S	58.4	7800	2900	4.9	2.62		1200	28		3630	4773	5862	7800	10210
CT5532	61.9	8400	2800	13.8	2.90	1PH 220V/ 50HZ	1600	38	40	3750	5140	6270	8400	11366
CT5541	79.6	11000	3800	18.5	2.90		1600	38	50	4350	6730	7725	11000	15980
CT5546	90.4	13000	4500	22.2	2.88		1600	38	50	5246	7954	9115	13000	18377
CT5532S	61.9	8400	2800	4.6	3.00	3PH 380V/ 50HZ	1600	37		3750	5140	6270	8400	11366
CT5541S	79.6	11300	3800	6.5	2.95		1600	37		4350	6730	7725	11300	15980
CT5546S	90.4	13000	4500	7.5	2.90		1600	38		5246	7954	9115	13000	18377
CT5561S	113.2	14900	5300	9.6	2.80	3PH 380V/ 50HZ	1980	49		6133	8164	10593	14870	20658
CT5568S	125.2	16600	5950	10.6	2.78		1980	49		6967	9180	11862	16676	23359
CT5573S	134	17800	6400	11.5	2.78		1980	49		7511	9804	12632	17816	25204

Remark:  
 1.Nominal Capacity under 60HZ is 120% compare with 50HZ 3PH 480V.  
 2.CT5531 CT5532 CT5541 AND CT5546 must use start capacitor an start relay.CT5518 and CT5522 shoul use start capacitor and start relay when necessary

Model	Displacement (cm³/rev)	Nominal Capacity (W)	Power Input (W)	RLA (A)	COP (W/W)	Power	Oil Charge (cm³)	Weight (kg)	Run Capacitor	Refrigeration Capacity At 50HZ Rated @54.4°C Cond.Temp. (W)				
										-10°C	-5°C	0°C	+7.2°C	+15°C
CT5522E	41.4	6360	2500	12.5	2.53	1PH 208-230	1200	27	30	2730	3548	4634	6360	8676
CT5527E	49.8	7560	2880	13.8	2.62		1200	28	30	3374	4382	5575	7560	11784
CT5531E	58.4	10100	3850	17	2.6	60HZ	1200	28	40	4356	5727	7034	9360	12252
CT5532E	61.9	10100	3500	16.5	2.85		1600	38	40	4501	6168	7524	10100	13639
CT5541E	79.6	13200	4700	22.2	2.8		1600	38	50	5222	8075	9273	13200	17176
CT5546E	90.4	15600	5570	26.6	2.8		1600	39	50	6295	9545	10938	15600	22052

Remark: must use start capacitor an start relay.

## R22 Air Conditioning Series

Working Range for Compressor	
Refrigerant	R22
Nominal Condition	T3
Evaporating Temp.	-15~12.5°C
Max.condensing Temp.	68°C
Winding Resistance Temp.	130°C
Max.Ambient Temp.	52°C
Oil Brand	3GS

NOMINAL CONDITION	
Evaporating Temp.	7.2°C
Condensing Temp.	54.4°C
Ambient Temp.	35.0°C
Subcooling	0K
Superheat	11K



Model	Displacement (cm³/rev)	Nominal Capacity (W)	Power Input (W)	Power	Power	COP (W/W)	Oil Charge (cm³)	Weight (kg)	Refrigeration Capacity at 50HZ Rated @54.4°C Cond.Temp. (W)				
									-10	-5	0	7.2	15
CT5527ST	49.8	7560	2850	3PH208-230V 60HZ	8	2.62	1200	28	3374	4382	5575	7560	11784
CT5531ST	58.4	9600	3800		10.2	2.6	1200	28	4356	5727	7034	9360	12252
CT5532ST	61.9	10100	3500		10	2.9	1600	38	4501	6168	7524	10100	13639
CT5541ST	79.6	13500	4700		13.5	2.85	1600	38	5222	8075	9273	13200	17176
CT5546ST	90.4	15600	5500		15.6	2.85	1600	39	6295	9545	10938	15600	22052
CT5561ST	113.2	17800	6450		20	2.75	1980	49	6133	8164	10593	14870	20658

## R407C Air Conditioning Compressor

Working Range for Compressor	
Refrigerant	R407C
Nominal Condition	T3
Evaporating Temp.	-15~12.5°C
Max.condensing Temp.	68°C
Winding Resistance Temp.	130°C
Max.Ambient Temp.	52°C
Oil Brand	ICI-32H

NOMINAL CONDITION	
Evaporating Temp.	7.2°C
Condensing Temp.	54.4°C
Ambient Temp.	35.0°C
Subcooling	0K
Superheat	11K



Model	Displacement (cm³/rev)	Nominal Capacity (W)	Power Input (W)	RLA (A)	COP (W/W)	Power	Oil Charge (cm³)	Weight (kg)	Run Capacitor F/450VAC	Refrigeration Capacity at 50HZ Rated @54.4°C Cond.Temp. (W)				
										-10	-5	0	7.2	15
CT5532N	61.9	8400	2800	13.8	2.9	1PH 220V/ 50HZ	1600	38	40	3750	5140	6270	8400	11366
CT5541N	79.6	11000	3800	18.5	2.9		1600	38	50	4350	6730	7725	11000	15980
CT5546N	90.4	12500	4500	22.2	2.85		1600	39	50	5246	7954	9115	13000	18377
CT5532SN	61.9	8400	2800	4.6	3	3PH 380V/ 50HZ	1600	38		3750	5140	6270	8400	11366
CT5541SN	79.6	11000	3800	6.5	2.95		1600	38		4350	6730	7725	11300	15980
CT5546SN	90.4	12500	4500	22.2	2.95		1600	39		5246	7954	9115	13000	18377
CT5561SN	113.2	14900	5300	9.6	2.8	3PH 380V/ 50HZ	1980	49		6133	8164	10593	14870	20658
CT5568SN	125.2	16600	5950	10.6	2.78		1980	49		6967	9180	11862	16676	23359
CT5573SN	134	17800	6400	11.5	2.78		1980	49		7511	9804	12632	17816	25204

## R22 Commercial Refrigeration & Freezing Series

Working Range for Compressor	
Refrigerant	R22
Evaporating Temp.	-25~0°C
Max.condensing Temp.	60°C
Winding Resistance Temp.	130°C
Max.Ambient Temp.	43°C
Oil Brand	SR-32A

NOMINAL CONDITION	
Evaporating Temp.	7.2°C
Condensing Temp.	54.4°C
Ambient Temp.	35.0°C
Subcooling	0K
Superheat	11K

### Medium/High Back Pressure Compressors

Model	Capacity at 7.2		Nominal Power (H.P)	Displacement (cm <sup>3</sup> /rev)	Power	RLA (A)	Oil Charge (cm <sup>3</sup> )	Weight (kg)	Run Capacitor	Refrigeration Capacity at 50HZ Rated @54.4°C Cond.Temp.(W)					
	1PH	3PH								-20°C	-15°C	-10°C	-5.7°C	0°C	7.2°C
CT4517	11420	2878	1 1/4	27	1PH 220V/ 50HZ	7.2	1200	26	25		1214	1680	1980	2720	3230
CT4519	13989	3526	1 1/2	33.5		8	1200	26	25		1518	1978	2260	3076	4100
CT4522	18681	4709	2	41.4		10.6	1200	27	30		1541	2240	2900	3898	5300
CT4527	21734	5478	2 1/2	49.8	3PH 380V/ 50HZ	11.3	1200	27	30		2109	2800	3500	4748	6300
CT4531	26453	6668	3	58.4		13.5	1200	28	40		2481	3473	4300	5828	7581
CT4522S	18681	4709	2	41.4		3.2	1200	27			1541	2240	2900	3898	5300
CT4527S	21734	5478	2 1/2	49.8	1PH 220V/ 50HZ	3.8	1200	27			2109	2800	3500	4748	6300
CT4531S	26453	6668	3	58.4		4.9	1200	28			2481	3473	4300	5828	7581
CT4532	29865	7528	3	61.9		13.8	1600	38	40		2795	3750	4500	6226	8280
CT4542	34877	8791	3 1/2	79.6	3PH 380V/ 50HZ	18.5	1600	39	50	2218	3130	4388	6000	7579	10158
CT4546	38774	9773	4	90.4		22.2	1600	39	50	2232	3143	4412	6900	7918	11297
CT4532S	29865	7528	3	61.9		4.6	1600	37			2795	3750	4500	6226	8280
CT4542S	34877	8791	3 1/2	79.6	3PH 380V/ 50HZ	6.5	1600	38		2218	3130	4388	6000	7579	10158
CT4546S	38774	9773	4	90.4		7.5	1600	38		2232	3143	4412	6900	7918	11297
CT4561S	51893	13080	5	113.2		9.6	1980	48		3262	4510	6194	8000	10452	14989
CT4568S	59751	15060	6	125.2	3PH 380V/ 50HZ	10.6	1980	48		3825	5209	7037	8800	11793	16809
CT4573S	62194	15676	6	134		11.5	1980	49		4216	5612	7478	9300	12594	17764

#### Remark:

1. Condensing Temp. is 48.9°C
2. Nominal Capacity under 60HZ is 120% compare with 50HZ 1PH 208-230V 3PH 460V.
3. CT4517 CT4519 CT4522 CT4527 CT4531 CT4532 CT4542 CT4546 must use start capacitor and start relay.



## R404a Commercial Refrigeration & M/HBP

Working Range for Compressor	
Refrigerant	R404A
Evaporating Temp.	-25~0°C
Max.condensing Temp.	60°C
Winding Resistance Temp.	130°C
Max.Ambient Temp.	43°C
Oil Brand	ICI-32H

NOMINAL CONDITION	
Evaporating Temp.	7.2°C
Condensing Temp.	54.4°C
Ambient Temp.	35.0°C
Subcooling	0K
Superheat	11K

### Medium/High Back Pressure Compressors

Model	Nominal Power (H.P)	Displacement (cm <sup>3</sup> /rev)	Power	RLA(A)	Oil Charge (cm <sup>3</sup> )	Weight (kg)	Run Capacitor	Refrigeration Capacity at 50HZ Rated @54.4°C Cond.Temp.(W)					
								-20°C	-15°C	-10°C	-5.7°C	0°C	7.2°C
CT4517D	1 1/4	27	1PH220V/ 50HZ	7.2	1200	26	25		1228	1753	1980	2832	3347
CT4519D	1 1/2	33.5		8	1200	26	25		1540	1996	2260	3120	4100
CT4522D	2	41.4		10.6	1200	27	30		1730	2334	2900	3947	5475
CT4527D	2 1/2	49.8	3PH380V/ 50HZ	11.3	1200	27	30		2116	2819	3500	4798	6370
CT4531D	3	58.4		13.5	1200	28	40		2698	3608	4300	5943	7753
CT4522SD	2	41.4		3.2	1200	27			1730	2334	2900	3947	5475
CT4527SD	2 1/2	49.8	1PH220V/ 50HZ	3.8	1200	27			2116	2819	3500	4798	6370
CT4531SD	3	58.4		4.9	1200	28			2698	3608	4300	5943	7753
CT4532D	3	61.9		13.8	1600	38	40		2589	3626	4500	6270	8753
CT4542D	3 1/2	79.6	3PH380V/ 50HZ	18.5	1600	39	50	2351	3529	4292	6000	7870	10222
CT4546D	4	90.4		22.2	1600	39	50	2365	3806	4609	6900	7956	11364
CT4532SD	3	61.9		4.6	1600	37			2589	3626	4500	6270	8753
CT4542SD	3 1/2	79.6	3PH380V/ 50HZ	6.5	1600	38		2351	3529	4292	6000	7870	10222
CT4546SD	4	90.4		7.5	1600	38		2365	3806	4609	6900	7956	11364
CT4561SD	5	113.2		9.6	1980	48		3457	4383	5895	8000	10702	15209
CT4568SD	6	125.2	3PH380V/ 50HZ	10.6	1980	48		4083	5322	7077	8800	11982	17512
CT4573SD	6	134		11.5	1980	49		4468	5788	7710	9300	13123	18228

#### Remark:

1. Condensing Temp. is 48.9°C
2. Nominal Capacity under 60HZ is 120% compare with 50HZ 1PH 208-230V 3PH 460V.
3. CT4517D CT4519D CT4522D CT4527D CT4531D CT4532D CT4542D CT4546D must use start capacitor and start relay.

## R404a Commercial Refrigeration & M/HBP

Working Range for Compressor		NOMINAL CONDITION	
Refrigerant	R404A	Evaporating Temp.	7.2°C
Evaporating Temp.	-40~12.5°C	Condensing Temp.	54.4°C
Max.condensing Temp.	60°C	Ambient Temp.	35.0°C
Winding Resistance Temp.	130°C	Subcooling	0K
Max.Ambient Temp.	43°C	Superheat	55K
Oil Brand	ICI-32H		

### Low Back Pressure Compressors

Model	Capacity at 7.2°C		HP	Displacement (cm³/min)	Power	RLA (A)	Oil charge (cm³)	Weight (kg)	Run Capacitor (µF/50VAC)	Refrigeration Capacity at 50HZ Rated @54.4°C Cond.Temp.(W)					
	liters	cuft								-40	-35	-30	-23.3	-20	-10
CT2462L	4060	1023	1 1/2	33.5	1PH 220V 50HZ	6	1200	26	25	701	1043	1190	1844	2912	
CT2480L	8182	2062	2	61.9		11.3	1600	38	40	809	1446	2398	2920	4853	
CT2511L	11475	2892	3	79.6		14	1600	387	50	1483	2157	3363	4032	6808	
CT2480SL	8182	2062	2	61.9	3PH 220V 50HZ	3.5	1600	37		809	1446	2398	2920	4853	
CT2511SL	11475	2892	3	79.6		4.6	1600	37		1483	2157	3363	4032	6808	
CT2516SL	15013	3784	4	113.2	3PH 380V 50HZ	7.5	1980	48		1407	1743	2704	4400	5335	9038
CT2522SL	19455	4904	6	134		9.2	1980	49		2012	2455	3657	5702	6906	11422

**Remark:**

1. Condensing Temp. is 40°C
2. Nominal Capacity under 60HZ is 120% compare with 50HZ 1PH 230V 460V
3. CT2462L CT2480L CT2511L must use start capacitor and start relay.



## R134a Commercial Refrigeration & M/HBP

Working Range for Compressor		NOMINAL CONDITION	
Refrigerant	R134A	Evaporating Temp.	7.2°C
Evaporating Temp.	-25~7.2°C	Condensing Temp.	54.4°C
Max.condensing Temp.	60°C	Ambient Temp.	35.0°C
Winding Resistance Temp.	130°C	Subcooling	0K
Max.Ambient Temp.	43°C	Superheat	11K
Oil Brand	ICI-32H		

### Medium/High back pressure compressors

Model	Capacity at 7.2°C		Nominal Power (H.P)	Displacement (cm³/min)	Power	RLA (A)	Oil Charge (cm³)	Weight (kg)	Run Capacitor	Enter Weight	Refrigeration Capacity at 50HZ Rated @54.4°C Cond.Temp.(W)					
	liters	cuft									-30°C	-15°C	-10°C	-5.7°C	0°C	7.2°C
CT4511U	10325	2602	1	33.5	1PH220V/ 50HZ	8	1200	26	25	49.4	878	1227	1600	2160	3026	
CT4518U	16378	4128	1.5	61.9	1PH380V/ 50HZ	13.8	1600	37	40		1020	1750	2500	3300	4800	
CT4525U	20745	5229	2	79.6		18.5	1600	38	50		1372	2356	3200	4250	6080	
CT4528U	23133	5831	2.5	90.4		22.2	1600	38	50		1678	2170	3500	4500	6780	
CT4518SU	16378	4128	1.5	61.9	3PH220V/ 50HZ	4.6	1600	37			1020	1750	2500	3300	4800	
CT4525SU	20745	5229	2	79.6		8.5	1600	37			1372	2358	3200	4250	6080	
CT4528SU	23133	5831	2.5	90.4		7.5	1600	37			1678	2170	3500	4500	6780	
CT4537SU	31128	7846	3 1/4	113.2	3PH380V/ 50HZ	9.6	1980	48			1756	2281	3308	4100	6258	9123
CT4543SU	33479	8438	3.5	125.2		10.6	1980	48			1848	2400	3442	4500	6820	9812

**Remark:**

1. Condensing Temp. is 48.9°C
2. Nominal Capacity under 60HZ is 120% compare with 50HZ 1HP 230V 3PH 460V.
3. CT4511U CT4518U CT4525U CT4528U must use start capacitor and start relay.



# HORIZONTAL CONDENSING UNIT (R404A)

PANASONIC/SANYO Horizontal Rotary Compressor **Panasonic SANYO**



Model	CU-PHK105L	CU-PHK125L	CU-PHK155L	CU-PHK205L	CU-PHK255L	CU-PHK305L		
Horse Power	1HP	1.2HP	1.5HP	2HP	2.5HP	3HP		
Cooling capacity (W)	760	850	1250	1550	1700	2300		
Power	220V/1PH/50Hz							
Refrigerant (Max/Kg)	R404A (1.2)	R404A (1.2)	R404A (1.4)	R404A (3.0)				
Starting Current (A)	25	27	37	50	53	60		
Max working current (A)	4.3	5.2	6.5	8.8	9.7	12.7		
Evaporating temp range (°C)	-45 ~ -5							
Ambient temp range (°C)	-7 ~ 43							
Liquid receiver (L)	0.8							
Accumulator (L)	0.65			1.2				
Condenser	Spec.(Raw*Ring*Lmm)		3*5*540	4*4.5*540	5*4.5*630	5*4.5*900	5*4.5*985	6*4.5*1060
	Fan motor	Motor(W)*Qty	10*2	10*2	10*2	10*3	10*3	10*3
		Fan Dia.(mm)	∠34° φ30*2	∠34° φ230*2	∠34° φ230*2	∠34° φ230*3	∠34° φ230*3	∠34° φ230*3
		Air volume (m³/hr)	820*2	820*2	820*2	820*3	820*3	820*3
Pipe (mm)	Suction φ		12.7(1/2")					
	Liquid outlet φ		9.53(3/8")					
Dimension (mm)	L±2		680	680	790	1060	1145	1210
	W±2		455	485	485	540	540	570
	H±4		276	261	261	263	263	263
Pitch of holes φ9--L*W (mm*mm)		660*435	660*465	770*465	1030*520	1125*520	1190*550	
Cooling capacity	Evap.Temp (°C)		Cooling capacity: W				Ambient Temp: 32°C	
	-40		505	635	840	1260	1405	1820
	-35		655	825	1090	1580	1760	2080
	-30		810	955	1190	1890	2110	2630
	-25		975	1210	1545	2310	2575	3320
	-20		1190	1440	1865	2730	3040	3955
	-15		1430	1710	2100	3095	3450	4540
	-10		1795	2070	2428	3680	4100	5465
-5		2135	2370	2790	4100	4570	6485	
Wiring	Leakage protector	Rated current(A)	10	10	15	25	25	30
		Action current(mA)	30					
	Wire dia (mm2)	≤10m	2.0	2.0	2.0	4.0	4.0	5.0
		≤20m	2.0	2.0	3.5	6.0	6.0	6.0
≤30m		3.5	3.5	3.5	6.0	6.0	8.0	

# HORIZONTAL CONDENSING UNIT (R404A)

GREE/LAMDA Horizontal Rotary Compressor **GREE LAMDA**



Model	CU-GHK105L	CU-GHK155L	CU-GHK205L	CU-GHK255L	CU-GHK305L	
Horse Power	1HP	1.5HP	2HP	2.5HP	3HP	
Cooling capacity (W)	960W	1630W	2400W	2800W	2680W	
Power	220V/1PH/50HZ					
Refrigerant (Max/Kg)	R404A/1.2Kg	R404A/1.5Kg	R404A/2.0Kg	R404A/2.3Kg	R404A/2.5Kg	
Max working current (A)	4.8A	7.8A	11.8A	12.0A	12.5A	
Evaporating temp range (°C)	-40°C~10°C	-40°C~10°C	-40°C~10°C	-40°C~10°C	-40°C~10°C	
Ambient temp range (°C)	30~45°C	30~45°C	30~45°C	30~45°C	30~45°C	
Liquid receiver (L)	1L	1L	1L	1L	1L	
Accumulator (L)	1.8L	1.8L	1.8L	1.8L	1.8L	
Condenser	Fan motor	Motor power supply*Qty	16W*2	16W*2	16W*3	16W*3
		Fan Dia(mm)	200mm	230mm	230mm	230mm
Pipe(mm)	Suction OD		16mm	16mm	16mm	16mm
	Liquid outlet OD		10mm	10mm	10mm	10mm
Dimension (mm)	L±2		670mm	750mm	1026mm	1090mm
	W±2		480mm	520mm	480mm	480mm
	H±4		245mm	275mm	245mm	245mm
Cooling capacity (W)	Evap.Temp (°C)		Cooling Capacity:W			
	-40		763W	974W	1623W	1781W
	-30		960W	1209W	1935W	2135W
	-25		1197W	1605W	2320W	2620W
	-20		1435W	1917W	2712W	3160W
	-15		1736W	2206W	3010W	3670W
	-10		2080W	2620W	3729W	4432W
-5		2370W	2918W	4180W	5250W	
Wiring	Leakage protector	Rated current(A)	25A	25A	25A	25A

# HORIZONTAL CONDENSING UNIT (R404A)

HITACHI/HIGHLY Horizontal Rotary Compressor

**HITACHI HIGHLY**



Model		CU-HHK108L	CU-HHK155L	CU-HHK208L	CU-HHK263L	CU-HHK301L	
Horse Power		1HP	1.5HP	2HP	2.5HP	3HP	
Input Power(W)		630	1060	1500	1730	2420	
Power Supply		220V-240V/1PH/50HZ				380V/3PH/50HZ	
Refrigerant (Maximum liquid volume KG)		R404A(1.2)	R404A(2.0)	R404A(3.0)	R404A(3.0)	R404A(3.7)	
Starting current(A)		20	35	42	50	75	
Maximum Running Current(A)		4	7	9.2	10.6	7	
Evaporating temperature °C		(-25~0)		(-40~0)			
Ambient Temp °C		(-7~43)					
Compressor Model		DDD127CV-A2A	DDI211CV-B5M	DDH307LV-B5M	DDH356LV-B5M	DWH468LV-B5M	
Condenser	Spec.(Raw*Ring)	4*5	5*5	5*5	6*5	6*5	
	Fan	Dia*Qty(mm)					
Pipe Conn. mm (inch)	Suction (Dia.)	φ 12.7 (1/2")					
	Liquid (Dia.)	φ 9.52 (3/8")					
Dimension (mm)	L(mm)	680	790	940	1145	1230	
	W(mm)	480	520	540	540	540	
	H(mm)	275	275	275	275	275	
Installation	L*W	650*450	780*490	910*510	1105*510	1200*510	
Capacity	Evaporating Temp (°C)		Capacity: W, Condensing Temp: 45°C, Ambient temperature: 32°C				
	-40		/	/	1291 (1110)	1379 (1186)	1850 (1691)
	-35		/	/	1821 (1394)	1659 (1427)	2306 (1883)
	-30		/	/	2000 (1720)	2041 (1755)	2905 (2498)
	-25		960 (825)	1500 (1290)	2427 (2087)	2515 (2163)	3541 (3045)
	-20		1195 (1028)	1830 (1574)	2803 (2497)	3068 (2638)	4043 (3478)
	-15		1500 (1290)	2100 (1806)	3424 (2945)	3687 (3170)	4734 (4071)
	-10		1850 (1591)	2500 (2150)	3986 (3428)	4359 (3749)	5638 (4848)
	-5		2200 (1892)	2900 (2494)	4582 (3941)	5068 (4358)	6786 (5835)
Connection capacity	Leakage protector	Rated current	10	15	20	25	30
		Leakage current	30	30	30	30	30
	Wire dia (mm <sup>2</sup> )	10m IN10m	2	2	4	4	4
		20m IN20m	2.5	2.5	6	6	6
		30m IN30m	2.5	2.5	6	6	6

# Kitchen Freezer Unit

Plug-in Type Kitchen Freezer Unit Range of Application



### Products Description:

- Low installation cost
- Low operating cost and low after sale cost

### Innovative technology

- Most cutting-edge food grade safety materials are used in the structure
- Strong refrigeration performance
- Ecological refrigeration fluid Forced ventilation
- With high efficiency motor and low consumption compressors

### Installation advantages

- Modular design, rapid installation
- Plug-in type connection, connected with plug-in
- Evaporator inside the modular, no occupation of space
- Ice cabinet space and increase the utility rate of space
- Automatic evaporation of condensate water
- Uniform device size & string universality

Model		CU-KFU0025HS	CU-KFU0033HS	CU-KFU0050HS	CU-KFU0050KS	CU-KFU0050KS	CU-KFL0100KS	
Horse Power		1/4HP	1/3HP	1/2HP	1/2HP	5/8HP	1HP	
Compressor Model		THK4430Y	AE4440Y	AE4460Y	AE2420Z	AE2425Z	TYA2446ZKS	
Power Supply		220V-240V/1PH/50HZ						
Refrigerant (Maximum liquid volume KG)		R134a	R134a	R134a	R404a	R404a	R404a	
Application Temp. (°C)		-2~+10	-2~+10	-2~+10	-22~0	-22~0	-22~0	
Application capacity (L)		400~500	800~1000	1400~1600	400~600	800~1000	800~1000	
Cooling Capacity Q <sub>0</sub> (W)	Evaporating Temp (°C)		Capacity: W, Condensing Temp: 45°C, Ambient temperature: 32°C					
	-35°C					283	382	566
	-30°C					379	607	879
	-23.3°C					534	706	1378
	-20°C					617	809	1632
	-15°C		366	409	613	770	1000	2077
	-10°C		444	620	784	946	1215	2660
	-5°C		540	658	989			
	0°C		679	821	1228			
7.2°C		892	1115	1648				
10°C			1260	1853				

### Unit Accessories:

Foam cover component, High-efficient evaporator (filled pipe optional), Toggle clip of electrical heating tube, Electrical heating pipe, Drainage strip for frost water, Evaporator motor bracket, High-efficient energy-saving motor (EMB motor), High-strength chassis, Foam cover pressure part, High-efficient condenser (Rifled pipe optional), High-efficient filter, Exhaust pipe with frost water evaporation, One-way valve, Chassis sealing strip.