

Compressor Technical Data

Model NO: R134a LBP
Energy Saving Series

220-240V 50Hz

Toeflex Ltd

Main Technical Data

Model	PW3.0VK	PW3.5VK	PW4.0VK	PW4.5VK
Application	LBP			
Running Voltage (V)	187~242V AC 50Hz			
Capacity (W)	76	95	112	128
Motor Input (W)	69	79	92	102
Current (A)	0.50	0.60	0.70	0.85
COP (W/W)	1.10	1.20	1.23	1.26
Weight (Kg)	6.8	7.2	7.2	7.2

Test Condition

Evaporating Temp: $-23.3^{\circ}\text{C} \pm 0.2^{\circ}\text{C}$ Condensing Temp: $54.4^{\circ}\text{C} \pm 0.3^{\circ}\text{C}$ Super Cooling Temp: $32.2^{\circ}\text{C} \pm 0.3^{\circ}\text{C}$ Suction Temp: $32.2^{\circ}\text{C} \pm 3^{\circ}\text{C}$ Ambient Temp: $32.2^{\circ}\text{C} \pm 1^{\circ}\text{C}$

Power Supply: 220V AC 50Hz

Applied Condition

Evaporating Temp Range: $-35^{\circ}\text{C} \sim -15^{\circ}\text{C}$

Refrigerant: R134a

Compressor Cooling: Static Cooling

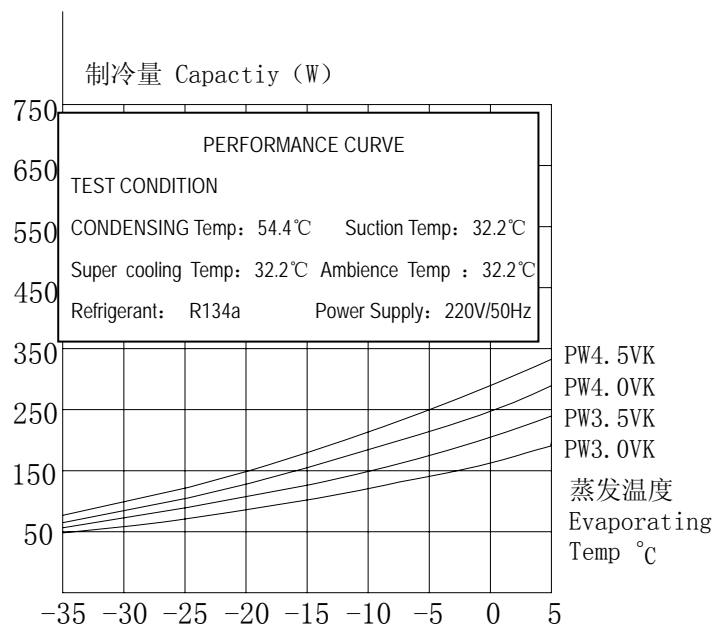
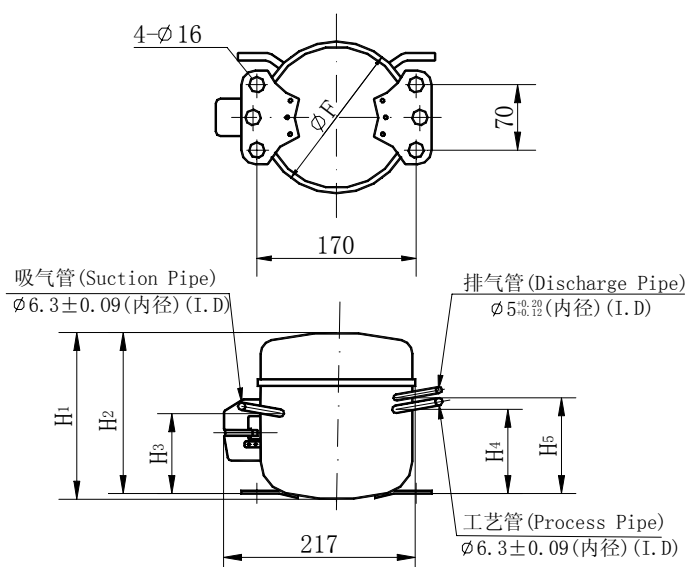
Ambient Temp: $10^{\circ}\text{C} \sim 38^{\circ}\text{C}$ 

(Characteristic Curve)

Model	H ₁	H ₂	H ₃	H ₄	H ₅	F	Model	H ₁	H ₂	H ₃	H ₄	H ₅	F
PW3.0VK							PW4.5VK	176	168	80	80	78	163
PW3.5VK	165	158	74	79	82	157							
PW4.0VK													

TECHNICAL DATA SUBJECT TO CONSTANT TECHNOLOGY IMPROVEMENT WITHOUT ADVANCED NOTICE.