

Compressor Technical Data

Model NO: R134a M/LBP

110-120V/60Hz

Toeflex Ltd

(Main Technical Data)

| Model | PW1.5DV | PW2.0DV | PW2.5DV | PW3.0DV |
|---------------------|-----------------|---------|---------|---------|
| Application | MBP/LBP | | | |
| Running Voltage (V) | 95~127V AC 60Hz | | | |
| Capacity (W) | 41 | 52 | 62 | 72 |
| Motor Input (W) | 51 | 58 | 62 | 68 |
| Current (A) | 0.87 | 0.9 | 1.0 | 1.21 |
| COP (W/W) | 0.80 | 0.9 | 1.0 | 1.05 |
| Weight (Kg) | 5.7 | 5.8 | 6.1 | 6.3 |

Test Condition

Evaporating Temp: $-23.3^{\circ}\text{C} \pm 0.2^{\circ}\text{C}$ Condensing Temp: $54.4^{\circ}\text{C} \pm 0.3^{\circ}\text{C}$ Super Cooling Temp: $32.2^{\circ}\text{C} \pm 0.3^{\circ}\text{C}$ Suction Temp: $32.2^{\circ}\text{C} \pm 3^{\circ}\text{C}$ Ambient Temp: $32.2^{\circ}\text{C} \pm 1^{\circ}\text{C}$

Power Supply: 110 AC 60Hz

Applied Condition

Evaporating Temp Range: $-35^{\circ}\text{C} \sim -5^{\circ}\text{C}$

Refrigerant: R134a

Compressor Cooling: Static Cooling

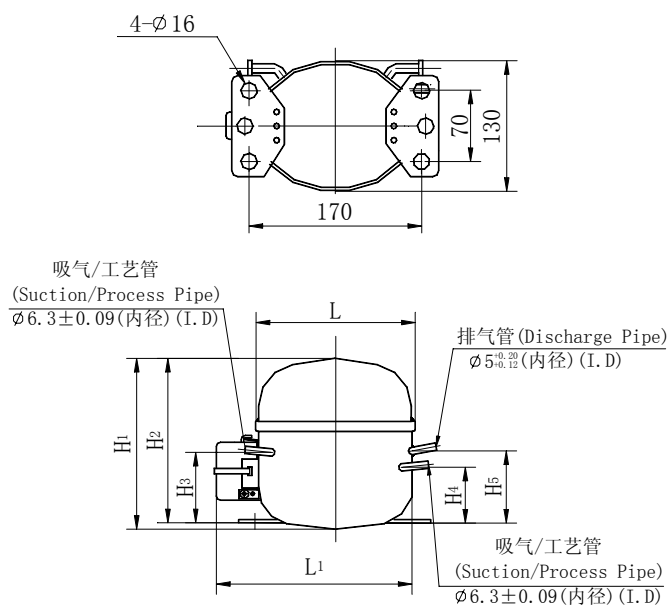
Ambient Temp: $10^{\circ}\text{C} \sim 38^{\circ}\text{C}$ 

制冷量 Capacity (W)

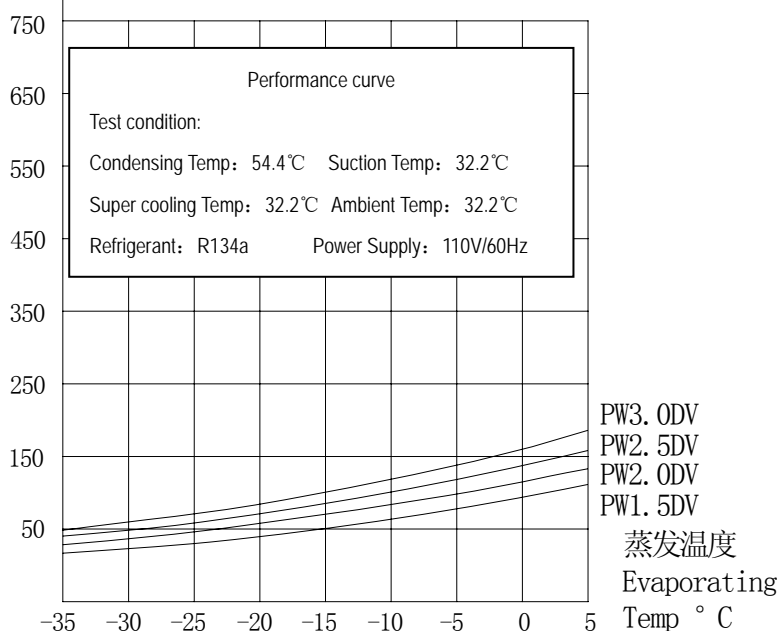

(Overall Dimensions)

| Model | H ₁ | H ₂ | H ₃ | H ₄ | H ₅ | L | L ₁ | Model | H ₁ | H ₂ | H ₃ | H ₄ | H ₅ | L | L ₁ |
|---------|----------------|----------------|----------------|----------------|----------------|-----|----------------|---------|----------------|----------------|----------------|----------------|----------------|-----|----------------|
| PW1.5DV | 156 | 149 | 73 | 67 | 77 | 147 | 206 | PW2.5DV | 158 | 149 | 73 | 68 | 75 | 157 | 216 |
| PW2.0DV | | | | | | | | PW3.0DV | | | | | | | |

TECHNICAL DATA SUBJECTED TO CONSTANT TECHNOLOGY IMPROVEMENT.

Main Technical Data

| Model | PW3.5VK | PW4.0VK | PW4.5VK |
|--|-----------------|---------|---------|
| Application | MBP/LBP | | |
| Running Voltage (V) | 95~127V AC 60Hz | | |
| Capacity (W) | 78 | 86 | 108 |
| Motor Input (W) | 82 | 81 | 98 |
| Current (A) | 1.35 | 1.40 | 1.60 |
| COP (W/W) | 0.95 | 1.06 | 1.1 |
| Weight (Kg) | 7.2 | 7.2 | 7.2 |
| <div> Test Condition Evaporating Temp: $-23.3^{\circ}\text{C} \pm 0.2^{\circ}\text{C}$ Condensing Temp: $54.4^{\circ}\text{C} \pm 0.3^{\circ}\text{C}$ Super Cooling Temp: $32.2^{\circ}\text{C} \pm 0.3^{\circ}\text{C}$ Suction Temp: $32.2^{\circ}\text{C} \pm 3^{\circ}\text{C}$ Ambient Temp: $32.2^{\circ}\text{C} \pm 1^{\circ}\text{C}$ Power Supply: 110V AC 60Hz </div> <div> Applied Condition Evaporating Temp Range: $-35^{\circ}\text{C} \sim -5^{\circ}\text{C}$ Refrigerant: R134a Compressor Cooling: Static Cooling Ambient Temp: $10^{\circ}\text{C} \sim 38^{\circ}\text{C}$ </div> | | | |

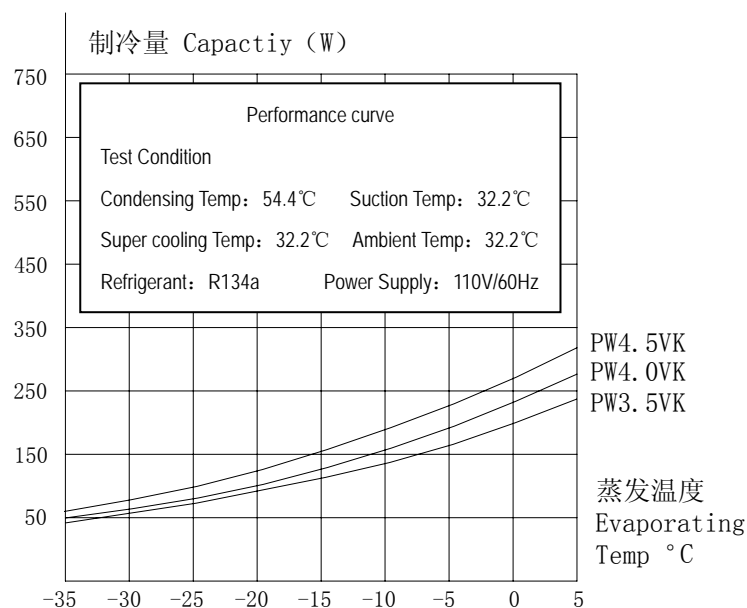
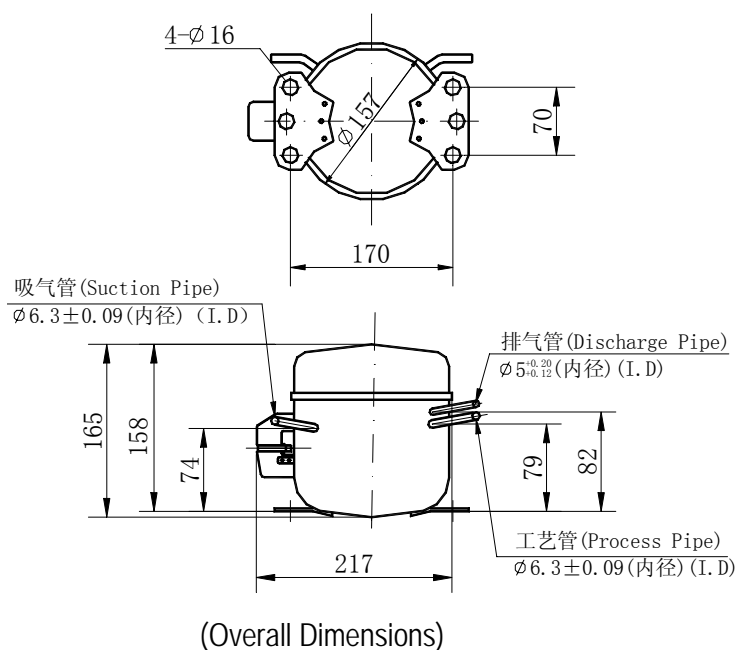

TECHNICAL DATA SUBJECTED TO CONSTANT TECHNOLOGY IMPROVEMENT.