

# Compressor Technical Data

Model NO: R134a L/HBP

220-240V/50Hz

Toeflex Ltd

## Main Technical Data

Model	PW3.0VK
Application	L/HBP
Running Voltage (V)	187~242V AC 50Hz
Capacity (W)	220 <sup>(1)</sup> 62 <sup>(2)</sup>
Motor Input (W)	115 <sup>(1)</sup> 69 <sup>(2)</sup>
Current (A)	0.9 <sup>(1)</sup> 0.53 <sup>(2)</sup>
COP (W/W)	1.9 <sup>(1)</sup> 0.9 <sup>(2)</sup>
Weight (Kg)	6.1

### (1) Test Condition

Evaporating Temp:  $7.2^{\circ}\text{C} \pm 0.2^{\circ}\text{C}$   
 Condensing Temp:  $54.4^{\circ}\text{C} \pm 0.3^{\circ}\text{C}$   
 Super Cooling Temp:  $46.1^{\circ}\text{C} \pm 0.3^{\circ}\text{C}$   
 Suction Temp:  $35^{\circ}\text{C} \pm 3^{\circ}\text{C}$   
 Ambient Temp:  $35^{\circ}\text{C} \pm 1^{\circ}\text{C}$   
 Power Supply: 220V AC 50Hz

### Applied Condition

Evaporating Temp Range:  $-35^{\circ}\text{C} \sim +15^{\circ}\text{C}$   
 Refrigerant: R134a  
 Compressor Cooling: Static Cooling  
 Ambience Temp:  $10^{\circ}\text{C} \sim 38^{\circ}\text{C}$

### (2) Test Condition

Evaporating Temp:  $-23.3^{\circ}\text{C} \pm 0.2^{\circ}\text{C}$   
 Condensing Temp:  $54.4^{\circ}\text{C} \pm 0.3^{\circ}\text{C}$   
 Super Cooling Temp:  $32.2^{\circ}\text{C} \pm 0.3^{\circ}\text{C}$   
 Suction Temp:  $32.2^{\circ}\text{C} \pm 3^{\circ}\text{C}$   
 Ambient Temp:  $32.2^{\circ}\text{C} \pm 1^{\circ}\text{C}$   
 Power Supply: 220V AC 50Hz

Note: HBP Test condition (1), LBP Test condition (2) .

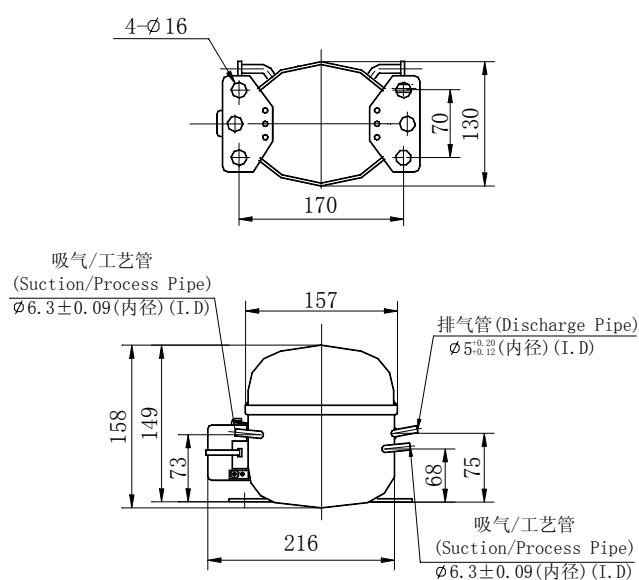

(Overall Dimensions)

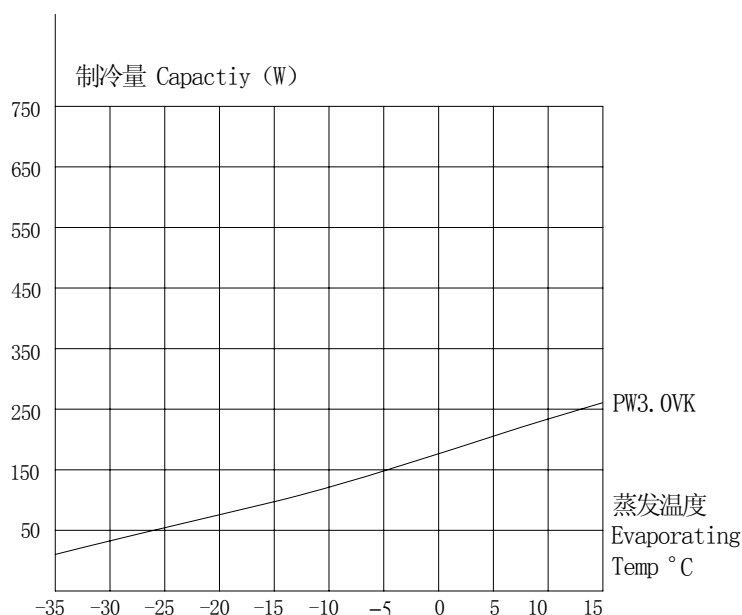

TECHNICAL DATA SUBJECTED TO CONSTANT TECHNOLOGY IMPROVEMENT WITHOUT ADVANCED NOTICE.

## Main Technical Data

Model	PW4.0VK	PW4.5VK
Application	L/HBP	
Running Voltage (V)	187~242V AC 50Hz	
Capacity (W)	310 <sup>(1)</sup> 72 <sup>(2)</sup>	395 <sup>(1)</sup> 108 <sup>(2)</sup>
Motor Input (W)	150 <sup>(1)</sup> 76 <sup>(2)</sup>	188 <sup>(1)</sup> 108 <sup>(2)</sup>
Current (A)	1.0 <sup>(1)</sup> 0.65 <sup>(2)</sup>	1.15 <sup>(1)</sup> 0.76 <sup>(2)</sup>
COP (W/W)	2.1 <sup>(1)</sup> 0.95 <sup>(2)</sup>	2.1 <sup>(1)</sup> 1.0 <sup>(2)</sup>
Weight (Kg)	7.2	7.2

### (1)件 Test Condition

Evaporating Temp:  $7.2^{\circ}\text{C} \pm 0.2^{\circ}\text{C}$

Condensing Temp:  $54.4^{\circ}\text{C} \pm 0.3^{\circ}\text{C}$

Super Cooling Temp:  $46.1^{\circ}\text{C} \pm 0.3^{\circ}\text{C}$

Suction Temp:  $35^{\circ}\text{C} \pm 3^{\circ}\text{C}$

Ambient Temp:  $35^{\circ}\text{C} \pm 1^{\circ}\text{C}$

Power Supply: 220V AC 50Hz

### Applied Condition

Evaporating Temp Range:  $-35^{\circ}\text{C} \sim 15^{\circ}\text{C}$

Refrigerant: R134a

Compressor Cooling: Static Cooling

Ambient Temp:  $10^{\circ}\text{C} \sim 38^{\circ}\text{C}$

### (2) Test Condition

Evaporating Temp:  $-23.3^{\circ}\text{C} \pm 0.2^{\circ}\text{C}$

Condensing Temp:  $54.4^{\circ}\text{C} \pm 0.3^{\circ}\text{C}$

Super Cooling Temp:  $32.2^{\circ}\text{C} \pm 0.3^{\circ}\text{C}$

Suction Temp:  $32.2^{\circ}\text{C} \pm 3^{\circ}\text{C}$

Ambient Temp:  $32.2^{\circ}\text{C} \pm 1^{\circ}\text{C}$

Power Supply: 220V AC 50Hz

Note: HBP Test condition (1), LBP Test condition (2).

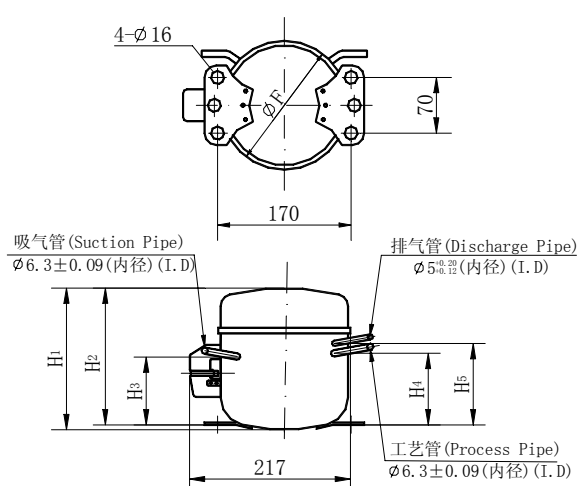

(Overall Dimensions)

Model	$H_1$	$H_2$	$H_3$	$H_4$	$H_5$	F
PW4.0VK	165	158	74	79	82	157
PW4.5VK						
PW5.5VK	176	168	80	80	78	163

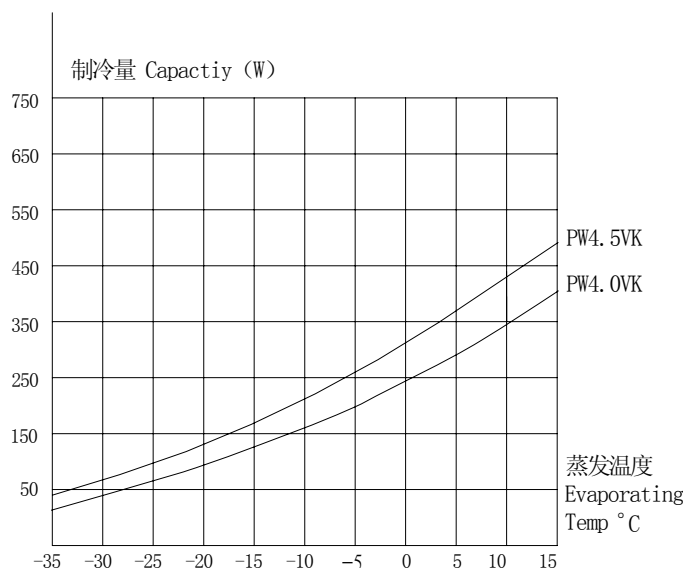

TECHNICAL DATA SUBJECTED TO CONSTANT TECHNOLOGY IMPROVEMENT WITHOUT ADVANCED NOTICE.